

VOLVO COMPUTER CONTROLLED ELECTRONIC IGNITION SYSTEM (Cont.)

ENGINE STARTS BUT WILL NOT RUN PROPERLY

1) Check ignition timing with vacuum hose at electronic control unit disconnected. Timing of 10-14° BTDC is acceptable. Check advance by increasing engine speed and observing whether timing advances. If necessary, try a new electronic control unit and re-test.

2) Check vacuum advance. Run engine at approximately 1500 RPM with vacuum hose disconnected. Connect vacuum hose and ensure that timing changes. If not, check vacuum line. If line is ok, try a known good control unit.

TESTING SYSTEM WHEN ENGINE WILL NOT START

In cold start situations where the engine will not start, perform the following test.

SPARKING TEST

1) Disconnect high tension wire at distributor cap and hold approximately 1/2" (12 mm) from engine block. Crank engine. If spark occurs, check rotor and distributor cap. Ensure spark is reaching spark plugs.

2) If no spark occurs, disconnect connector at distributor. Connect a jumper wire to pin "A" in electronic control unit connector. See Fig. 3. With ignition "ON", touch pin "C" with other end of jumper wire and check for spark.

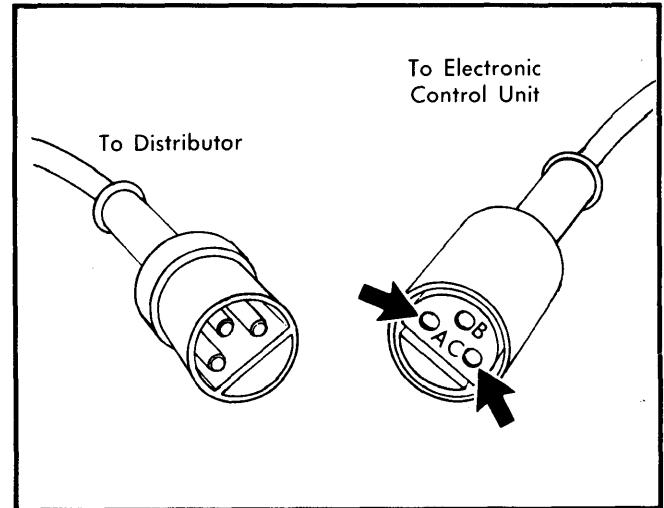

Fig. 3 Distributor Connector Showing Pin Locations

3) If no spark occurs, proceed to step 4). If spark occurs, touch a jumper to pin "B" and check for spark. If spark occurs, try a new Hall sender in distributor. If there is no spark, replace electronic control unit.

4) If no spark occurred in step 2), check wire and connectors carefully. If no fault is found, try a new electronic control unit. If there is still no spark, try a new ignition coil.