

Crankcase Ventilation

PORSCHE CLOSED

912 4-Cylinder Models
 914 4-Cylinder Models
 914/6 6-Cylinder Models
 911 6-Cylinder Models

are vented from the camshaft chamber, through a connecting hose, to the oil filler tank. From here they pass through a flame arrestor and connecting hose to the air cleaner, then through the carburetors and into the intake manifold.

DESCRIPTION & OPERATION

912 4-Cylinder Models – 912 crankcase ventilation system components consist of a connecting hose located between camshaft chamber and oil filler tank (located on generator support). A flame arrestor is located between oil filler tank and a hose connected to air cleaner. Crankcase fumes and gases

911T, 911E, 911S & 914/6 6-Cylinder Models – Components of system consist of a connecting hose located between crankcase and oil tank, with a second hose connecting oil tank to engine air cleaner. Vapors and gases produced in the crankcase are vented through connecting hose to the oil tank. From oil tank, vapors and gases pass through a second connecting hose to engine air cleaner where they are drawn into the combustion chambers and burned.

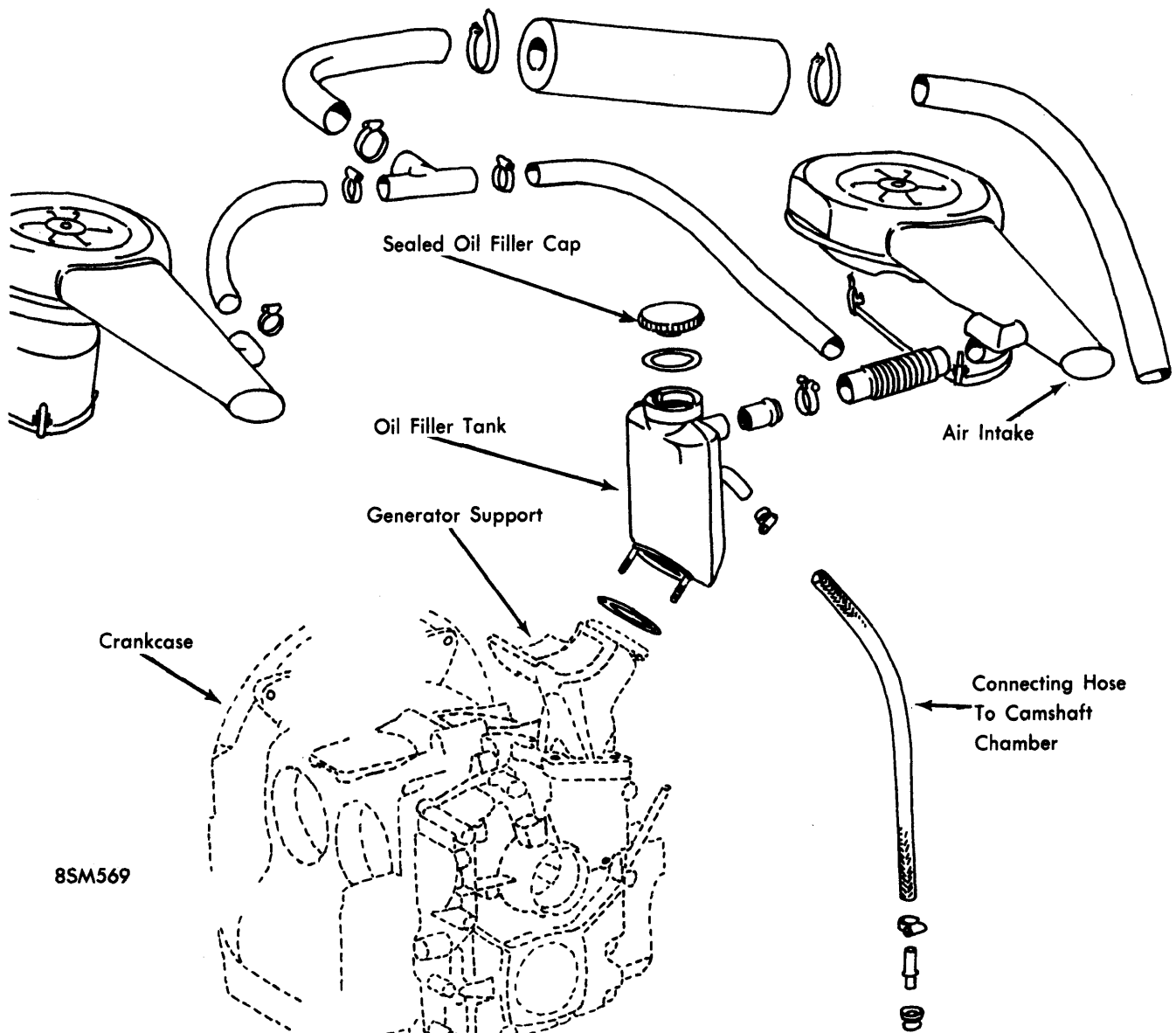

**CRANKCASE VENTILATION SYSTEM COMPONENTS
 (PORSCHE 912 4 CYL. MODELS)**

Crankcase Ventilation

PORSCHE CLOSED (Cont.)

914 4-Cylinder Models (1970-71) – Crankcase ventilation on Porsche 914 4-cylinder models is accomplished through a closed system. Vapors produced in the engines crankcase pass through a ventilation hose which is connected between the oil breather (separator) and the engine air cleaner. They are then drawn through the intake manifold and enter the combustion chambers where they are burned. The oil breather is located between the crankcase and the oil fill tube. It is designed to prevent liquid (condensate) from passing through into the combustion system.

914 4-Cylinder Models (1972-73) – Components of system consist of connecting hoses between air cleaner and cylinder head covers, and oil breather with a regulator valve incorporated, and a connecting hose from oil breather to intake air distributor. Vapors and gases produced in the crankcase are mixed with fresh air from air cleaner and flow through oil breather into intake air distributor. From intake air distributor, fumes pass into combustion chambers and are burned. Regulator valve controls flow of vapors and gases into engine.

MAINTENANCE

Check system for proper operation and clean all hoses every 6,000 miles (1965-71), or every 10,000 miles (1972-73).

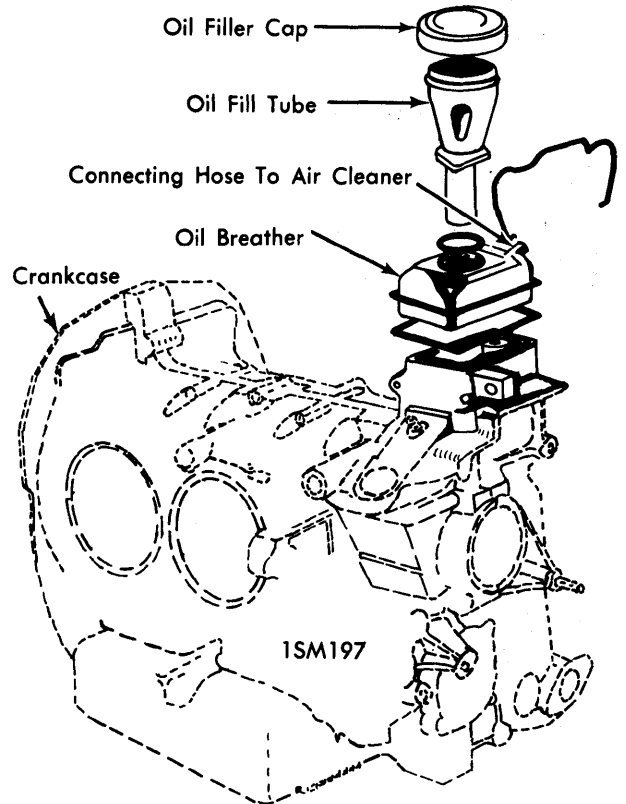

CRANKCASE VENTILATION SYSTEM COMPONENTS (PORSCHE 914 4 CYL. MODELS)

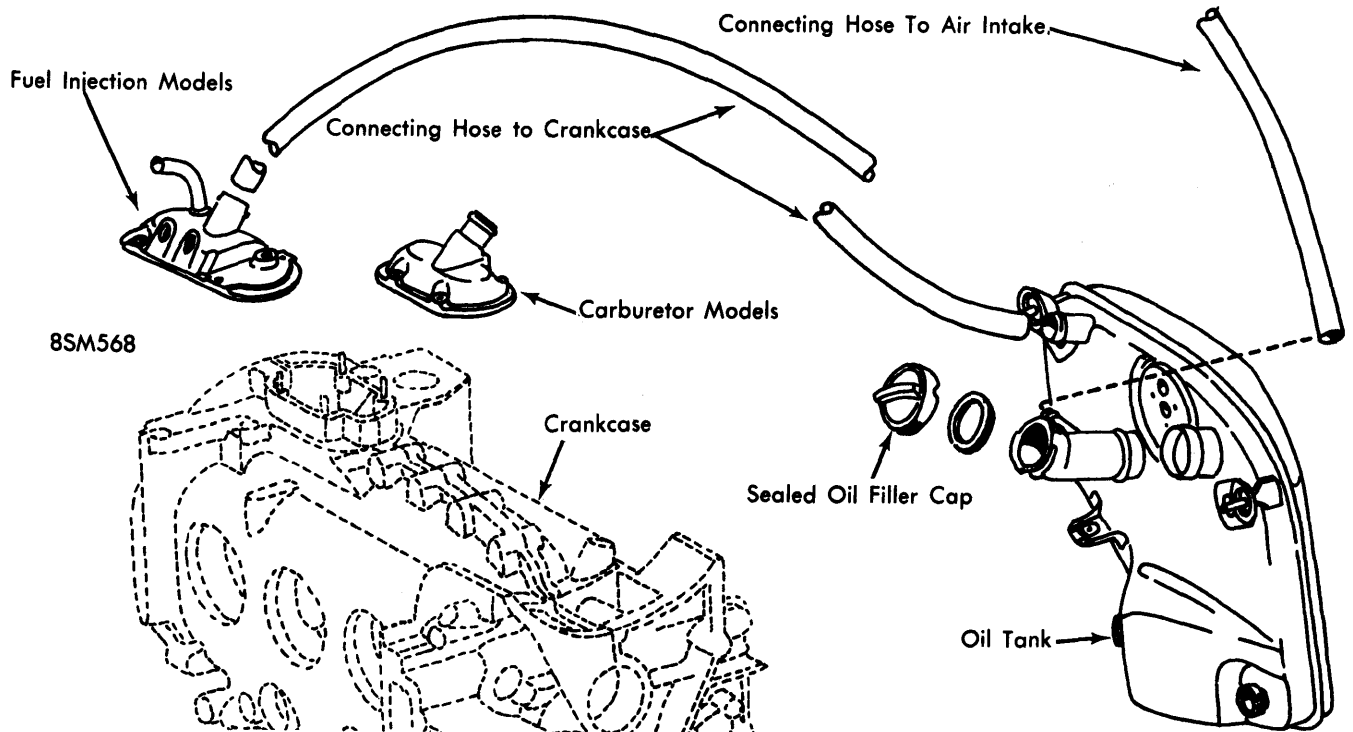

CRANKCASE VENTILATION SYSTEM COMPONENTS (TYPICAL PORSCHE 914/6 & 911 MODELS)