

1975-79 FUEL SYSTEMS

Holley 1945 1-Barrel Carburetor

1975-79 Chrysler Corp.

CARBURETOR APPLICATION

CHRYSLER CORP.

Application	Part No. Man. Trans.	Part No. Auto. Trans.
1975		
Federal		
Light Duty	R-7074A	R-7076A
Heavy Duty	R-7080A	R-7081A
California		
Light Duty	R-7078A	R-7079A
Heavy Duty	R-7082A	R-7083A
1976		
Federal		
Light Duty	R-7428A	R-7429A
Heavy Duty	R-7080A	R-7081A
California		
Light Duty	R-7401A	
Heavy Duty	R-7082A	R-7083A
Other Models	¹ R-7224A	
1977		
Federal	R-7847A	R-7848A
	¹ R-7849A	
California	R-7815A	R-7816A
1978	²	²
1979 Federal	R-8593A	R-8594A

¹ - Used on 4-speed overdrive only.

² - Information not available.

CARBURETOR IDENTIFICATION

Part number is stamped in float bowl body or on tag attached to carburetor.

DESCRIPTION

The Holley model 1945 carburetor is a 1-barrel downdraft design. The carburetor consists of 3 main sub-assemblies: air horn, main body and throttle body. Air horn houses choke valve, accelerator pump system, vacuum controlled power enrichment valve piston assembly, choke assembly, fuel bowl and vent assembly.

Main body houses fuel inlet system (float assembly and needle valve), main metering jet, power enrichment valve assembly, accelerator pump check ball and weight. Throttle body houses throttle valve, linkage and tamper-proof idle mixture adjusting needle.

ADJUSTMENTS

NOTE: For all on-vehicle adjustments not covered in this article, see appropriate TUNE-UP article.

FLOAT LEVEL

- 1) With air horn removed, invert main body. Catch accelerator pump check ball and weight if not previously removed. Hold float hinge pin retainer in place with finger. See Fig. 1.
- 2) Place a straightedge across air horn gasket surface and toes of both floats. Ends of float should just contact straight edge.
- 3) To adjust, bend float tang. Make sure floats are correctly aligned with walls of float bowl and that they move freely through full travel. See appropriate CARBURETOR ADJUSTMENT SPECIFICATIONS table.

NOTE: Make sure accelerator pump check ball and weight are reinstalled if removed.

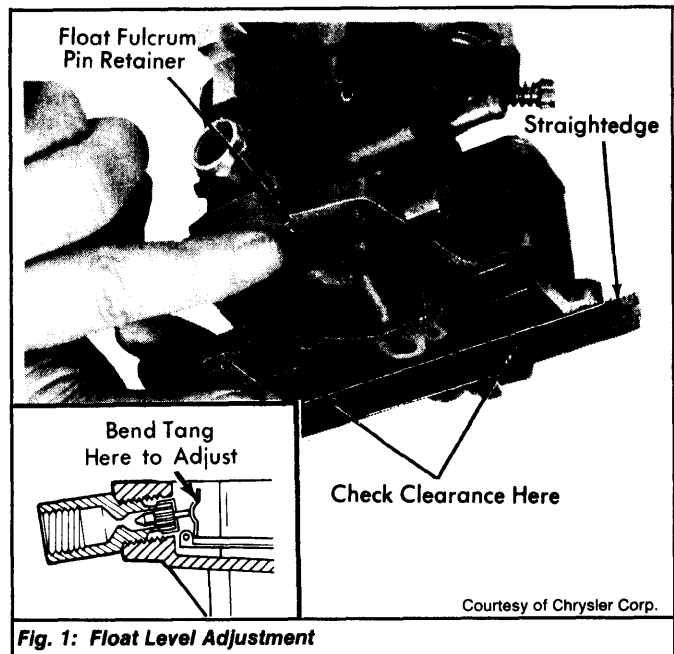

Fig. 1: Float Level Adjustment

ACCELERATOR PUMP

1) Make sure accelerator pump rod is in correct slot or hole. Inner slot is designated number 1 and outer slot is designated number 2. If accelerator pump adjustment is made, bowl vent adjustment must be performed.

2) Place throttle lever in curb idle position. Measure accelerator pump distance between center of rod in throttle lever to center of rod in accelerator pump arm. See Fig. 2. To adjust, bend existing loop in accelerator pump operating link. See appropriate CARBURETOR ADJUSTMENT SPECIFICATIONS table.

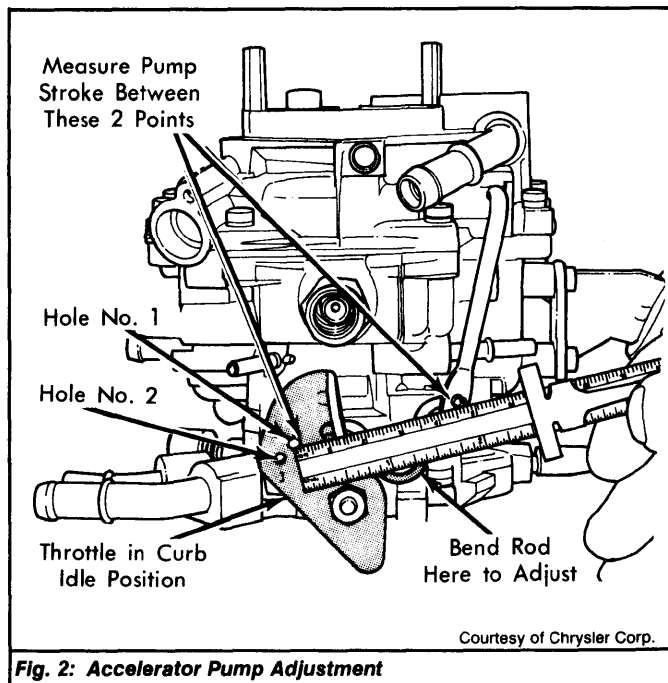

Fig. 2: Accelerator Pump Adjustment

FAST IDLE CAM POSITION

1) Position fast idle speed screw on second step of fast idle cam against shoulder of highest step. Hold choke valve toward closed position with light finger pressure.

1975-79 FUEL SYSTEMS

Holley 1945 1-Barrel Carburetor (Cont.)

- 2) Measure fast idle cam specified clearance between upper edge of choke valve and air horn wall. Measurement can be checked using a specified drill or pin gauge. See Fig. 3.
- 3) To adjust, bend fast idle cam rod (located between automatic choke housing) at "U" shaped bend. See appropriate CARBURETOR ADJUSTMENT SPECIFICATIONS table.

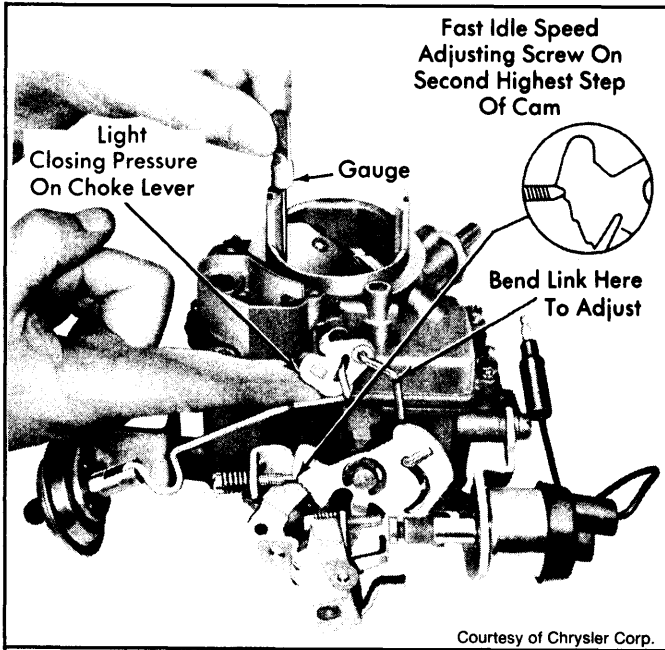

Fig. 3: Adjusting Fast Idle Cam Position

Courtesy of Chrysler Corp.

CHOKE UNLOADER

- 1) Hold throttle valves in wide open position. Hold choke valve toward closed choke position by applying light closing pressure to choke lever. See Fig. 4.
- 2) Measure choke unloader specified clearance between upper edge of choke valve and air horn wall. Measurement can be checked using a specified drill or pin gauge. To adjust, bend choke unloader tang. See appropriate CARBURETOR ADJUSTMENT SPECIFICATIONS table.

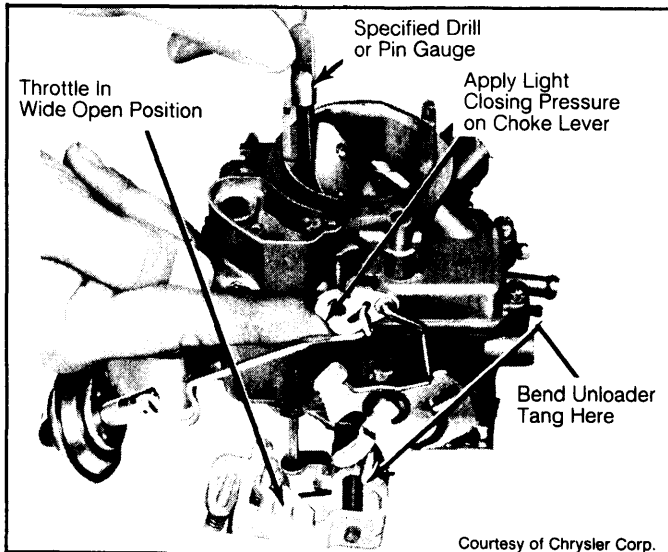

Fig. 4: Adjusting Choke Unloader

Courtesy of Chrysler Corp.

CHOKE VACUUM KICK (CHOKE PULL-DOWN)

- 1) Open throttle then close throttle. Release throttle to trap fast idle cam at closed throttle position. See Fig. 5.
- 2) Remove tamper-proof steel plug. Apply outside vacuum source to activate pull-down motor and measure choke vacuum kick specified clearance between upper edge of choke valve and air horn wall.
- 3) To adjust, turn adjusting screw in or out as required. See appropriate CARBURETOR ADJUSTMENT SPECIFICATIONS table.

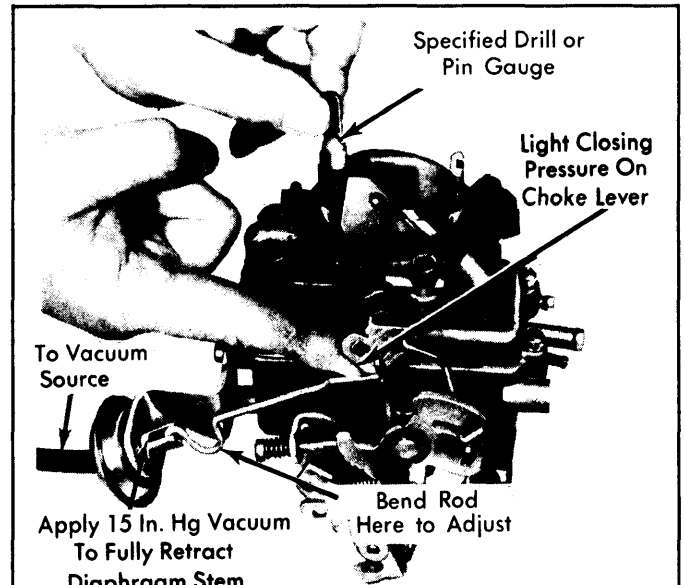

Fig. 5: Adjusting Choke Vacuum Kick

Courtesy of Chrysler Corp.

BOWL VENT

NOTE: Adjustment must be performed if accelerator pump adjustment was changed.

1978-79 Models - Position throttle at curb idle position. Remove bowl vent cover, spring and gasket. Turn bowl vent screw until specified distance from bowl vent cover surface on air horn to flat on plastic vent lever. See appropriate CARBURETOR ADJUSTMENT SPECIFICATIONS table. See Fig. 6.

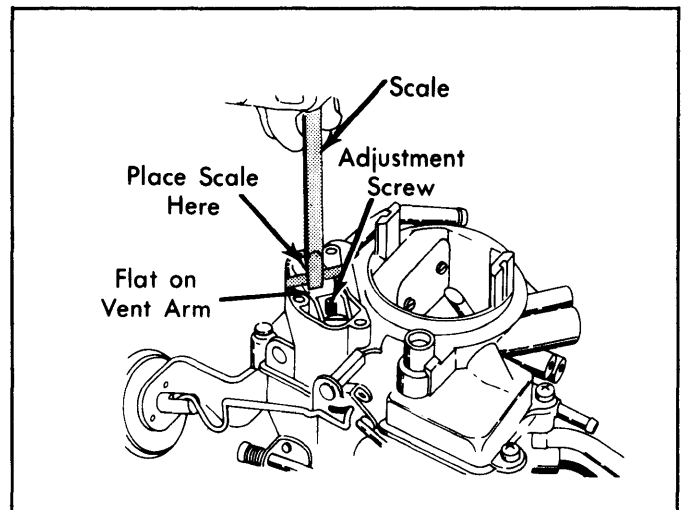
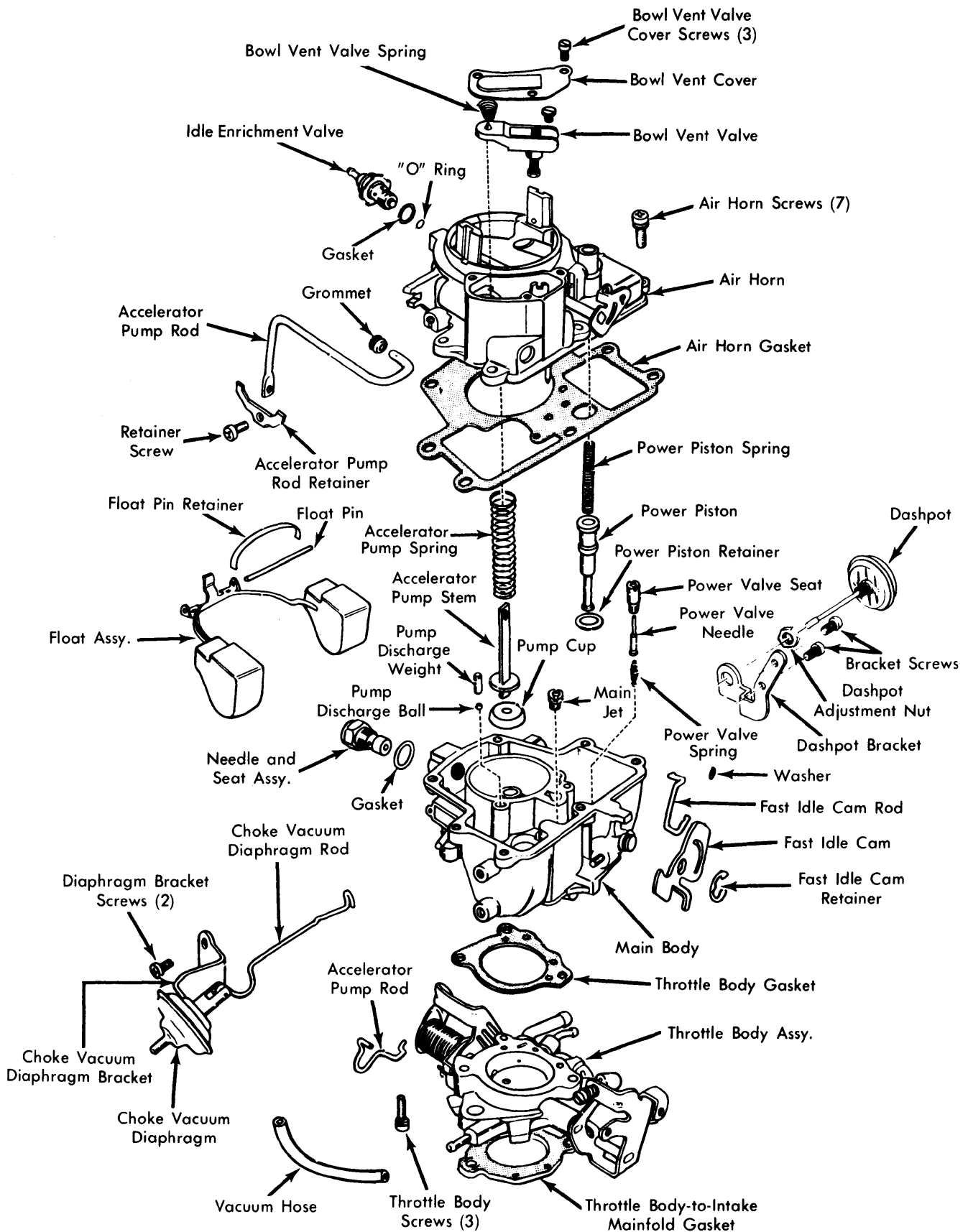

Fig. 6: Adjusting Bowl Vent

Courtesy of Chrysler Corp.

1975-79 FUEL SYSTEMS

Holley 1945 1-Barrel Carburetor (Cont.)



Courtesy of Chrysler Corp.

Fig. 7: Exploded View of Holley 1945 Carburetor

1975-79 FUEL SYSTEMS

Holley 1945 1-Barrel Carburetor (Cont.)

OVERHAUL

CARBURETOR

Disassembly - 1) Place carburetor in a stand. Remove bowl vent valve cover, spring and bowl vent valve (if equipped). Remove fast idle cam retaining clip, fast idle cam and connector rod.

2) Remove choke vacuum diaphragm bracket screws. Disconnect diaphragm rod from slot in choke lever. Remove diaphragm and rod. Remove 7 air horn screws and remove air horn and gasket from main body.

3) Remove accelerator pump rod retaining screw and retainer. Remove accelerator pump. Remove accelerator pump operating rod and grommet from air horn.

4) Remove staking from around vacuum piston retainer using a sharp pointed punch. Depress vacuum piston and allow piston to snap up. Remove retaining ring and vacuum piston.

NOTE: DO NOT attempt to remove main well tube from air horn.

5) Remove fuel inlet fitting from main body. Remove float pin retainer, float pin and float assembly. Turn main body upside down and catch accelerator pump discharge ball and weight.

6) Remove main jet. Depress power valve needle with screwdriver and remove power valve. Remove 3 throttle body screws and

separate throttle body from main body. Remove idle speed screw. Remove idle mixture screw limiter cap. Lightly seat idle mixture screw, counting number of turns for reassembly reference. Remove idle mixture screw and spring.

Cleaning & Inspection - 1) Use a regular carburetor cleaning solution. Soak parts long enough to thoroughly clean all passages.

NOTE: DO NOT soak any parts containing rubber, leather or plastic.

2) Remove all cleaning residue after soaking by rinsing parts in clean solvent. Blow out all passages with compressed air.

Reassembly - 1) To reassembly, reverse disassembly procedures. Remove all staking around vacuum piston ring groove in air horn. Lightly seat idle mixture screw, then back out number of turns noted during disassembly.

2) When installing accelerator pump discharge ball, check for proper sealing. Hold accelerator pump discharge ball and weight down with brass rod. With gasoline in float bowl, install accelerator pump in well and operate by hand. If no resistance is felt, ball is leaking at seat.

3) Remove new accelerator pump discharge ball and install old ball. Using a small drift punch, lightly tap on old ball to form a new seat. Remove old ball. Install new ball and weight and perform leak test. If still leaking, replace carburetor.

1975 CARBURETOR ADJUSTMENT SPECIFICATIONS							
Holley Carb. No.	Idle Speed (Engine RPM)		Accel. Pump Setting	Float Setting	Fast Idle Cam Setting	Vacuum Kick Setting	Choke Unloader Setting
	Hot	Fast					
R-7074A	800	1600	2 ¹ / ₃₂ "	3 ¹ / ₄ "	.080"	.110"	.250"
R-7076A	750	1700	2 ² / ₆₄ "	3 ¹ / ₄ "	.080"	.090"	.250"
R-7078A	800	1600	2 ¹ / ₃₂ "	3 ¹ / ₄ "	.080"	.110"	.250"
R-7079A	750	1700	2 ¹ / ₆₄ "	3 ¹ / ₄ "	.080"	.090"	.250"
R-7080A	700	1600	2 ¹ / ₃₂ "	3 ¹ / ₄ "	.080"	.110"	.250"
R-7081A	700	1700	2 ¹ / ₆₄ "	3 ¹ / ₄ "	.080"	.090"	.250"
R-7082A	700	1600	2 ¹ / ₃₂ "	3 ¹ / ₄ "	.080"	.110"	.250"
R-7083A	700	1700	2 ¹ / ₆₄ "	3 ¹ / ₄ "	.080"	.090"	.250"

1976 CARBURETOR ADJUSTMENT SPECIFICATIONS									
Holley Carb. No.	Idle Speed (Engine RPM)		Float Setting	Float Drop	Fast Idle Cam Setting	Accel. Pump Plunger Stem	Accel. Pump Connector Slot	Vacuum Kick Setting	Choke Unloader Setting
	Hot	Fast							
R-7080A	700	1600	⊙080"	2 ⁷ / ₃₂ "	No. 2	.110"	.250"
R-7081A	700	1700	⊙080"	2 ² / ₆₄ "	No. 3	.090"	.250"
R-7082A	700	1600	⊙080"	2 ¹ / ₃₂ "	No. 2	.110"	.250"
R-7083A	700	1700	⊙080"	2 ² / ₆₄ "	No. 3	.110"	.250"
R-7224A
R-7401A	750	1600	⊙080"	2 ⁷ / ₃₂ "	No. 2	.110"	.250"
R-7428A	750	1600	⊙080"	2 ⁷ / ₃₂ "	No. 2	.110"	.250"
R-7429A	750	1700	⊙080"	2 ² / ₆₄ "	No. 3	.110"	.250"

⊙ — Flush with top of float bowl gasket, ±¹/₃₂".

1975-79 FUEL SYSTEMS

Holley 1945 1-Barrel Carburetor (Cont.)

1977 CARBURETOR ADJUSTMENT SPECIFICATIONS									
Holley Carb. No.	Idle Speed (Engine RPM)		Float Setting	Float Drop	Fast Idle Cam Setting	Accel. Pump Plunger Stem	Accel. Pump Connector Slot	Vacuum Break Setting	Choke Unloader Setting
	Hot	Fast							
R7815A	①	1600	②080"	2 ² / ₆₄ "	#3③	.110"	.250"
R7816A	①	1700	②080"	2 ² / ₆₄ "	#3	.110"	.250"
R7847A	①	1600	②080"	2 ⁷ / ₃₂ "	#2	.110"	.250"
R7848A	①	1700	②080"	2 ² / ₆₄ "	#3	.110"	.250"
R7849A	①	1600	②080"	2 ⁷ / ₃₂ "	#3	.110"	.250"

- ① — See Emission Control Tune-Up Decal
 ② — Flush with top of float bowl gasket, $\pm 1/32$ "
 ③ — B & C models should be in Slot #2

NOTE: Carburetor adjustment specifications not available for 1978 models.

1979 CARBURETOR ADJUSTMENT SPECIFICATIONS							
Application	Float Level Setting	Accelerator Pump		Fast Idle Cam Setting	Choke Unloader Setting	Choke Vacuum Kick Setting	Bowl Vent Valve Setting
		Hole Setting	Stroke Setting				
R8593A	Flush①	No. 1	2 ⁷ / ₃₂ "	.080"	.250"	.100"	1/16"
R9593A	Flush①	No. 2	2 ² / ₆₄ "	.080"	.250"	.100"	1/16"

- ① — See adjustment procedure.