

# Holley Carburetors

## HOLLEY MODEL 2110 2-BARREL

### INTERNATIONAL HARVESTER

| Application      | Holley Part No. |
|------------------|-----------------|
| 1965             |                 |
| 265" 6 Cyl. .... | 1812            |
| 1966             |                 |
| 265" 6 Cyl. .... | 1812            |

### CARBURETOR IDENTIFICATION

Holley part number is stamped on tag attached to fuel bowl cover. **NOTE** — Do not remove this tag.

### DESCRIPTION

Dual downdraft type carburetor utilizing a manual choke. Each venturi, while utilizing a single air horn, has its own idle system, main metering system, and throttle plate.

### ADJUSTMENTS

#### HOT (SLOW) IDLE RPM

See appropriate article in TUNE-UP Section.

#### COLD (FAST) IDLE RPM

See appropriate article in TUNE-UP Section.

#### ACCELERATOR & DOWNSHIFT LINKAGE ADJUSTMENT

See appropriate article in TUNE-UP Section.

### FLOAT LEVEL ADJUSTMENT

Place inverted air horn on a level surface and rest specified gauge on horizontal surface of air horn with gauge just touching float, but not lying across soldered seam. Adjust by bending rounded tab which contacts head of fuel inlet needle.

### ACCELERATOR PUMP STROKE

Three holes in throttle lever permit adjustment of accelerator pump discharge. Outer hole provides maximum pump discharge for extreme cold weather, and inner hole provides a minimum pump discharge for hot weather. However, for most driving conditions, use middle hole.

### CARBURETOR ADJUSTMENT SPECIFICATIONS

| Holley Part No. | Idle Speed (RPM) | Float Level Gauge |
|-----------------|------------------|-------------------|
| 1812            | 350-400          | SE-1772-9         |

### OVERHAUL

#### DISASSEMBLY

During disassembly, discard all gaskets and all parts which have a replacement in repair kit.

1) Remove air horn to main body screw and separate main body assembly from air horn assembly. Remove pump link assembly. Remove screws and separate main body assembly from throttle body assembly.

2) Slide float shaft out from bracket and remove float assembly. Using suitable socket (SE-1772-5), remove fuel inlet valve and seat assembly. **NOTE** — Fuel inlet valve and seat assembly are a matched set and are not interchangeable. Remove choke lever and swivel assembly, then choke lever plunger and spring. Remove choke plate screws and choke plate, then slide choke shaft out of air horn.

3) Remove pump rod stud, then remove accelerator pump assembly from main body and disassemble. Remove throttle kicker screw, then throttle kicker and spring. Remove nozzle bar screws and clamps, then remove nozzle bars. Unscrew idle tube assemblies from nozzle bars. Remove pump discharge nozzle and invert main body to slide pump discharge valve out. Remove main jet passage plugs, and using suitable tool (SE-1772-6) remove the two main jets. Remove economizer valve assembly using suitable socket (SE-1772-1).

4) Using suitable puller (SE-1772-15), remove pump check valve retainer and invert main body and shake out pump check valve. Remove pump operating rod lubricating ring using same puller (SE-1772-15). Remove pump operating shaft washer and seal using same puller (SE-1772-15).

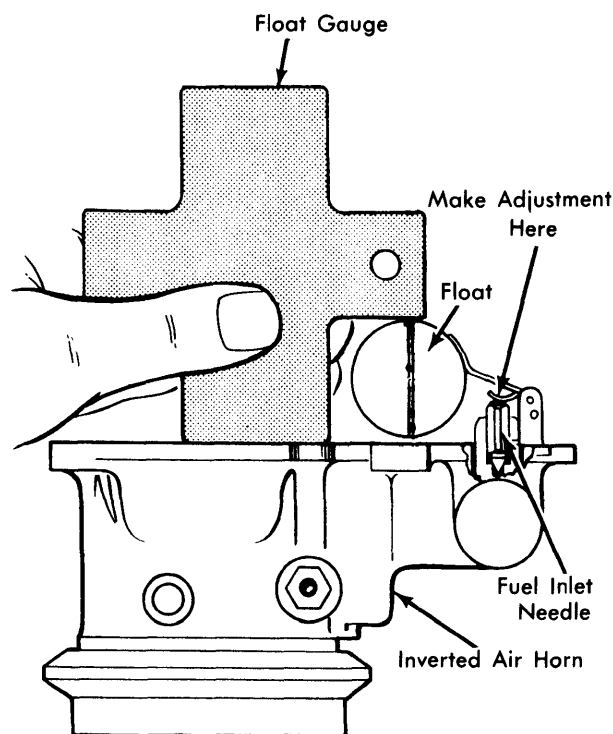

51H01

**FLOAT LEVEL ADJUSTMENT**

# Holley Carburetors

## HOLLEY MODEL 2110 2-BARREL (Cont.)

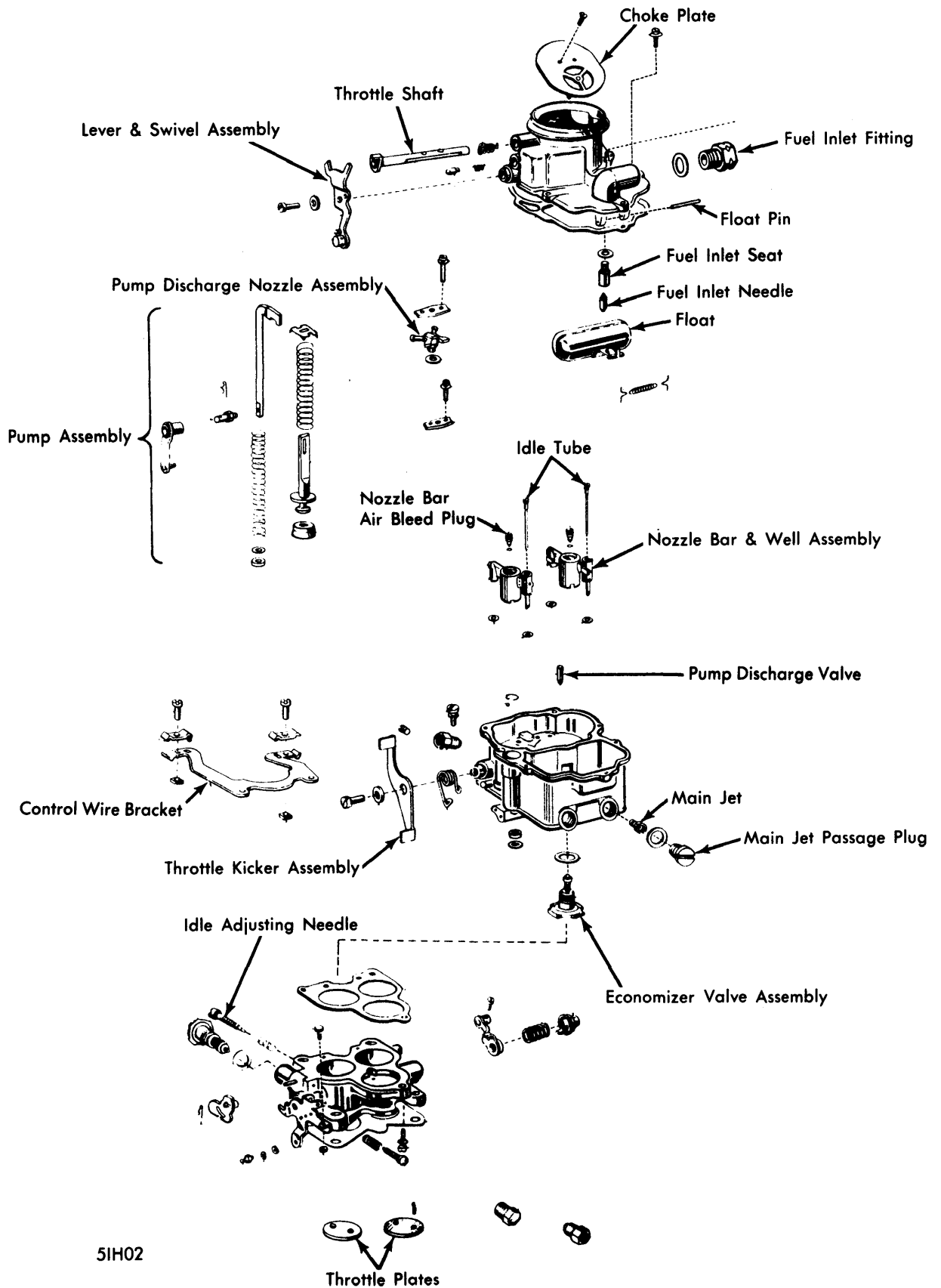

51H02

### HOLLEY MODEL 2110 2-BBL. CARBURETOR ASSEMBLY

# Holley Carburetors

## HOLLEY MODEL 2110 2-BARREL (Cont.)

5) Remove the two idle adjusting needles and springs and throttle stop screw and spring. Lightly scribe both throttle plates along throttle shaft and mark each throttle plate and its corresponding bore to insure replacement of each plate in original bore. Remove throttle plates and slide throttle shaft out of throttle body. *NOTE — Mark position of shaft for correct reassembly.*

### CLEANING & INSPECTION

Clean all carburetor casting and metal parts except nozzle bars in suitable solvent. Only inlet end of nozzle bars should be immersed in cleaning solution. Do not immerse any rubber or synthetic parts that are to be reused in solution; clean with gasoline. Check all parts and casting passages for carbon deposits and blow out all passages with compressed air. Inspect all components for wear or damage.

### REASSEMBLY

Use all new gaskets and reverse the disassembly procedure noting the following.

1) When installing throttle and choke plates, care must be taken to align plates so that little or no light shows between plate and bore when plate is closed and held up to strong light. Do not tighten plate screws down until this adjustment is made. When adjustment is made, tighten screws and stake them in place while supporting throttle or choke shaft to prevent shaft distortion.

2) To install accelerator pump ball check valve, place small brass rod on ball and tap lightly with fiber mallet to insure proper seating of ball. Care must be taken to prevent damage to ball or seat. Check to see if ball is still movable.