

Locking Hubs

WARN SELECTIVE MANUAL TYPE

Jeep; Front Axle

DESCRIPTION

Locking hubs provide a means of engagement of front wheels on vehicles with front drive axle. When hub is engaged, full power is transmitted to both front wheels. When hubs are disengaged, front wheels are free to turn, but axle shafts and differential will remain idle.

Engagement is accomplished through action of gears within hub. With hub in engaged position, clutch body and hub body of hub assembly act as one piece to connect axle shaft to wheel hub. All Warn Selective Manual Hubs function similarly, regardless of differing external appearances.

IDENTIFICATION

All Warn Hubs employ brass control knobs to engage and disengage locking mechanism. Model number of hub is stamped into recess of control knob. See table for model numbers of Warn Selective Manual Hubs.

Warn Selective Manual Type Hubs

Application	Model No.
Jeep	
“CJ” & Scrambler	M243
All Other Models	M247

REMOVAL & INSTALLATION

NOTE: Model M243 and M247 front drive hubs are serviced as either a complete assembly or subassembly, such as the hub body or clutch assembly only. Do not attempt to disassemble these units. If the entire hub or a subassembly has malfunctioned, replace the hub assembly or the defective subassembly as a unit only.

Fig. 1: Exploded View of Warn Hub Model M243

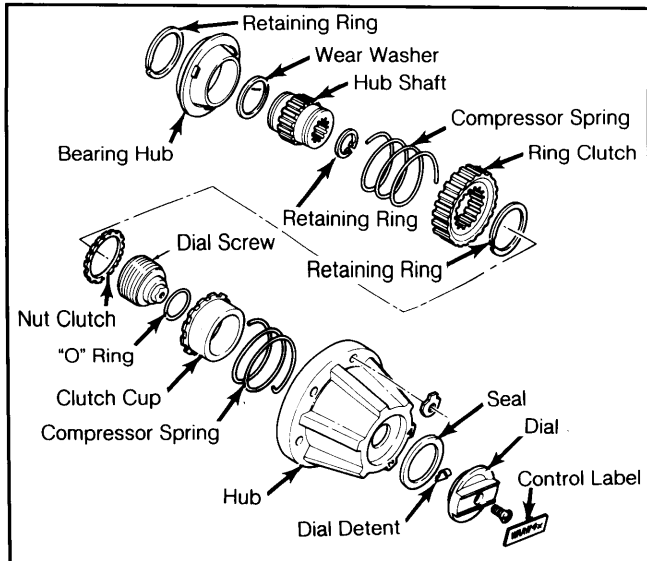

REMOVAL

Models M243 & M247

1) Remove bolts and tabbed lock washers (if equipped), attaching hub body to axle hub. Retain bolts and washers.

2) Remove retaining ring from axle shaft. Remove hub clutch and bearing assembly.

3) Clean hub components in solvent. Dry components, using compressed air or clean shop towel, or air dry.

4) Be sure old lubricant, dirt, water, or other foreign materials are flushed out.

CAUTION: Do not turn hub control dial, until hub has been installed. The hub clutch nut and cup can be damaged severely, if dial is rotated while hub is off vehicle.

INSTALLATION

Models M243 & M247

1) Lubricate hub components with all-purpose chassis lubricant. Apply light coat of lubricant only. Do not pack hub with lubricant.

2) On model M243, install hub clutch, bearing assembly, and retaining ring on axle shaft. Position new gasket on hub body, and install hub body and gasket.

3) On model M247, install hub clutch assembly and small retaining ring on axle shaft. Install large retaining ring in axle hub. Install new “O” ring if hub body is being replaced.

4) Align bolt holes in axle and hub body. Install bolts and tabbed lock washers (if equipped). Tighten bolts to 30 ft. lbs. (41 N.m), on model M243 and 30 INCH lbs. (3.4 N.m) on model M247.

5) Raise vehicle front end. Turn hub control dials to position “2” and rotate wheels. Wheels should rotate freely. If wheels drag, check hub installation. Also, be sure control dials fully engaged in 4x4 position.

Fig. 2: Exploded View of Warn Hub Model M247

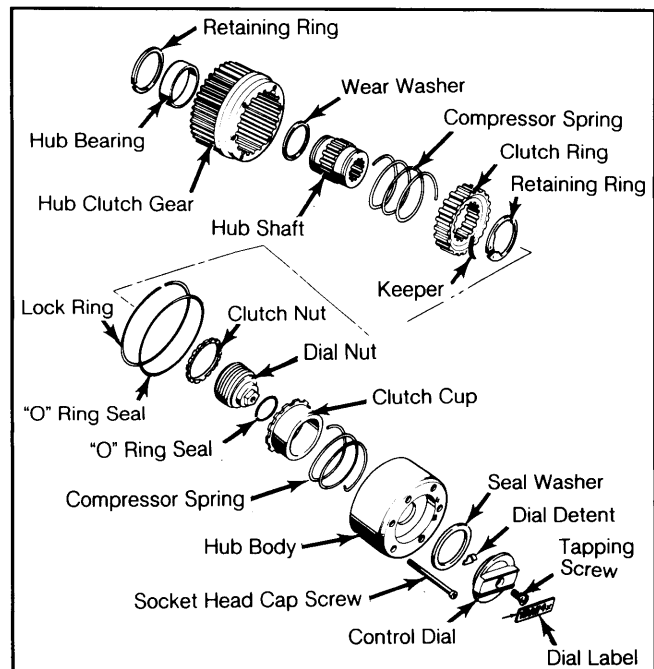

WARN SELECTIVE MANUAL TYPE (Cont.)

3) On model M247, install hub clutch assembly and small retaining ring on axle shaft. Install large retaining ring in axle hub. Install new "O" ring if hub body is being replaced.

4) Align bolt holes in axle and hub body. Install bolts and tabbed lock washers (if equipped). Tighten bolts to 30 ft. lbs. (41 N.m), on model M243 and 30 INCH lbs. (3.4 N.m) on model M247.

5) Raise vehicle front end. Turn hub control dials to position "2" and rotate wheels. Wheels should rotate freely. If wheels drag, check hub installation. Also, be sure control dials fully engaged in 4x4 position.

Fig. 3 Warn Hub Model M243 Clutch & Bearing Assembly

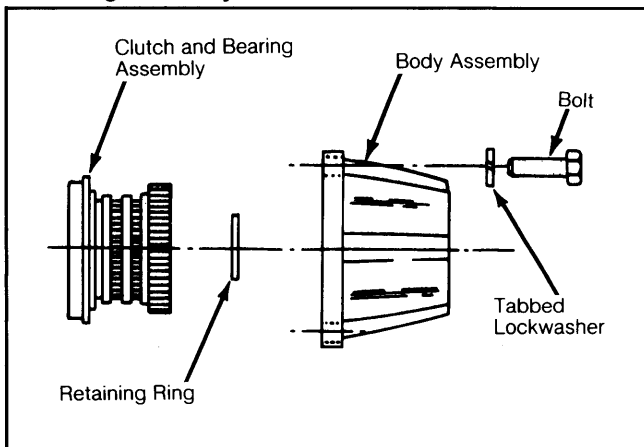

Fig. 4: Warn Hub Model 247 Clutch Assembly

