

INTERNATIONAL HARVESTER

All Models

DESCRIPTION

Three types of clutches are used in International Harvester vehicles. Auburn clutches are distinguished by the open cover design. Borg & Beck clutches have a full, or closed, cover and three release fingers. Diaphragm Spring type clutches also have a closed cover, but are distinguished by a dish shaped diaphragm spring which is slotted, thus creating multiple release fingers. Removal and installation of all three types of clutches is similar. Clutch actuation is accomplished through hydraulic system on Motor Home, and Mutli-Stop chassis. All others incorporate a mechanical release system.

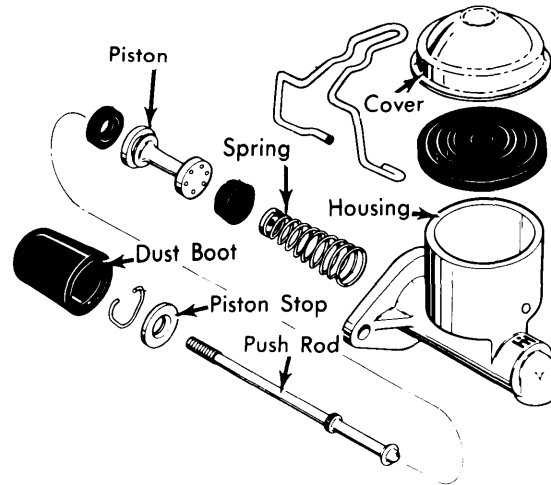

4IH01

CLUTCH MASTER CYLINDER ASSEMBLY (TYPICAL)

CLUTCH SLAVE CYLINDER

Disassembly & Reassembly — With slave cylinder removed from vehicle, remove dust boot, push rod, and piston. Remove piston and cup from cylinder bore. Inspect cylinder for signs of excessive wear or damage. If excessive scoring or pitting is apparent, manufacturer recommends replacement of cylinder. To reassemble cylinder, reverse disassembly procedure using new rubber parts.

REMOVAL & INSTALLATION

CLUTCH

Removal & Installation — Raise and support vehicle under frame, and remove transmission. See *appropriate article in MANUAL TRANSMISSION SERVICING Section*. Remove flywheel underpan (if equipped). Disconnect clutch linkage at clutch fork, and remove clutch fork, clutch release bearing, and bearing sleeve from vehicle. Remove clutch housing from vehicle. Mark clutch assembly and flywheel for reassembly reference and remove clutch cover-to-flywheel attaching bolts. Remove clutch cover assembly and clutch disc from vehicle. To install, clean flywheel surface and clutch assembly, and reverse removal procedure. Tighten clutch bolts evenly and alternately.

CLUTCH MASTER CYLINDER

Removal & Installation — Remove clutch pedal return spring, and disconnect master cylinder push rod at clutch pedal. Disconnect master cylinder-to-slave cylinder hydraulic line at master cylinder, and remove master cylinder attaching bolts. Remove master cylinder from vehicle. Remove master cylinder cover, and drain fluid from cylinder. To install, reverse removal procedure, and bleed system. See *Hydraulic System Bleeding*.

CLUTCH SLAVE CYLINDER

Removal & Installation — Clean outside of cylinder thoroughly and disconnect hydraulic line at slave cylinder. Remove slave cylinder attaching bolt(s), and remove slave cylinder from vehicle. To install, reverse removal procedure, and bleed system. See *Hydraulic System Bleeding*.

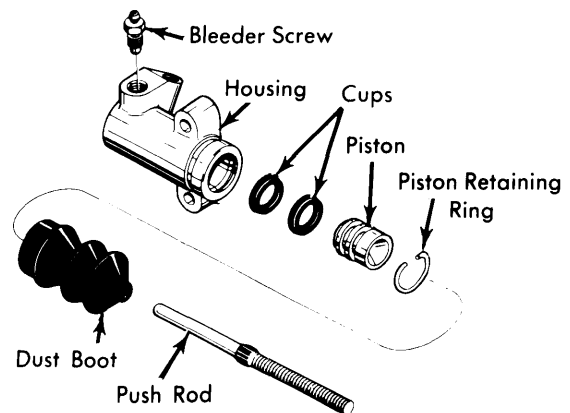

4IH02

CLUTCH SLAVE CYLINDER ASSEMBLY

ADJUSTMENT

CLUTCH PEDAL HEIGHT

Clutch pedal height is distance from floorboard of vehicle to top surface of clutch pedal pad when pedal is in fully returned position, as measured at 90° to floorboard. Pedal height adjustment is accomplished by moving pedal stop bracket under instrument panel.

OVERHAUL

CLUTCH MASTER CYLINDER

Disassembly & Reassembly — With master cylinder removed from vehicle, remove dust boot, retainer ring, and piston stop. Remove push rod, piston, and piston spring from cylinder bore, and inspect cylinder bore for damage. If excessive scoring or pitting is apparent, manufacturer recommends replacement of cylinder. To reassemble, reverse disassembly procedure, using new rubber parts.

Clutch Pedal Height

Application	Height
Scout II	9"
All Other Models	7¾"

INTERNATIONAL HARVESTER (Cont.)

CLUTCH PEDAL FREE TRAVEL

NOTE — On some vehicles it may be necessary to increase pedal height setting over recommended amount in order to obtain correct free travel.

Cable Linkage — Loosen lock nut securing equalizer shaft lever to control lever, and adjust equalizer shaft lever to obtain clutch pedal free travel of $\frac{3}{4}$ -1".

Solid Rod Linkage — Disconnect clutch pedal return spring, and loosen clutch pedal push rod lock nut. Adjust pedal push rod yoke to lengthen or shorten push rod, until pedal free travel is $\frac{3}{4}$ -1".

Hydraulic Linkage — From inside cab, adjust length of clutch master cylinder push rod to obtain clutch pedal free travel of $\frac{1}{4}$ ".

HYDRAULIC SYSTEM BLEEDING

Clean bleeder screw on slave cylinder, and attach bleeder hose to screw. Submerge free end of bleeder hose in jar $\frac{1}{2}$ full of clean brake fluid. Pressurize clutch master cylinder, and open and close bleeder screw at four second intervals, until no air appears in fluid running from bleeder hose.