

## FIAT X1/9

X1/9

### DESCRIPTION

Clutch is a dry, single plate, diaphragm spring type. Clutch actuation is hydraulic, using a firewall mounted master cylinder and a clutch housing mounted slave cylinder. A prelubricated clutch release bearing is also used.

### REMOVAL & INSTALLATION

#### CLUTCH ASSEMBLY

**Removal 1)** — Disconnect positive battery cable. Remove air cleaner and carburetor duct cooling. From inside engine compartment, separate slave cylinder from transmission case. Install engine support. Remove upper transmission-to-crankcase mounting bolts.

**2)** — Working from under vehicle, disconnect and swing out-of-way shifting flexible link. Disconnect back-up lights and seat belt warning system wire. Remove starter. Disconnect and remove exhaust pipe.

**3)** — Remove nuts from hub end of half shaft. Remove attaching hardware mounting suspension control arm to supports. Free half shaft from hub end and fix other end to transmission to prevent premature disconnection.

**4)** — Remove the following: Flywheel cover, engine cross-member support, and lower engine-to-transmission bolts. Remove transmission/differential from below vehicle. Mark clutch position on flywheel and remove clutch.

**Installation** — To install, reverse removal procedure using suitable tool (A. 70210) to center clutch assembly.

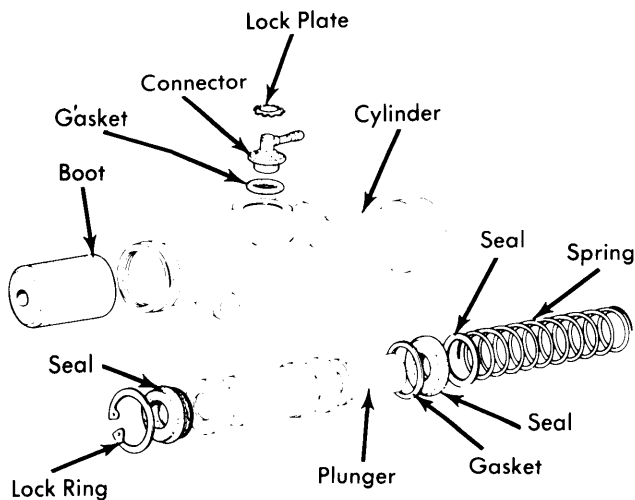

4FA01

#### CLUTCH MASTER CYLINDER

#### CLUTCH MASTER CYLINDER

**Removal** — Remove steering column. See *Steering Column Removal in STEERING Section*. Disconnect and cap master cylinder hydraulic line. Remove two bolts attaching cylinder to support plate. Withdraw cylinder from actuating rod and remove from vehicle.

**Installation** — To install, reverse removal procedure and bleed hydraulic system.

#### CLUTCH SLAVE CYLINDER

**Removal** — Remove slave cylinder hydraulic hose and union. Disconnect cylinder push rod from clutch release bearing fork. Slightly compress return spring and remove two mounting bolts; slowly withdraw cylinder from support plate.

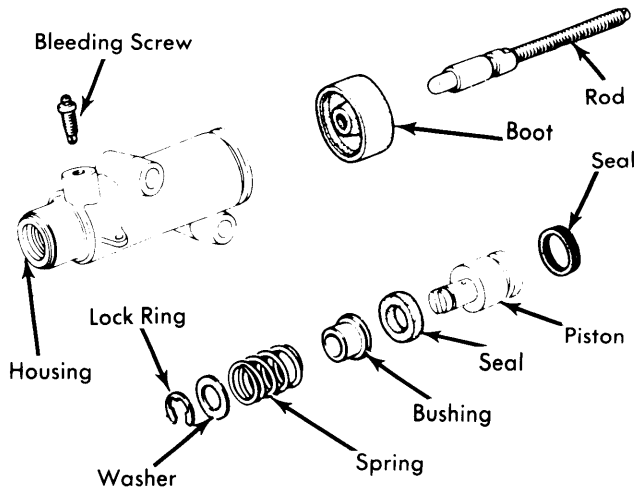

4FA02

#### CLUTCH SLAVE CYLINDER

**Installation** — To install, reverse removal procedure ensuring slave cylinder snugly fits against support and that hydraulic system is bled.

### TIGHTENING SPECIFICATIONS

Application	Ft. Lbs. (mkg)
Clutch Flywheel Bolts .....	10.8 (1.5)
Clutch Release Fork Bolt.....	18 (2.5)
Slave Cylinder Piston Adjusting Nut.....	18 (2.5)
Slave Cylinder Support Plate-to- Transmission Case .....	18 (2.5)
Support Plate-to-Transmission Case Stud Nut .....	18 (2.5)