

ALFA ROMEO

2000

DESCRIPTION

Alfa Romeo 2000 clutch is of the self-adjusting, hydraulically operated, single plate, dry type design. A diaphragm spring type pressure plate is used on all models. System includes clutch master cylinder, mounted on firewall; clutch slave cylinder, mounted on bell housing and connecting hydraulic lines. The clutch assembly main components are: disc, diaphragm spring pressure plate, clutch release bearing and bell housing.

REMOVAL & INSTALLATION

Information on Alfa Romeo clutch removal and installation is not available at time of publication.

OVERHAUL

Information on Alfa Romeo clutch overhaul is not available at time of publication.

ADJUSTMENT

Clutch is self-adjusting and no regular adjustment of free play is required.

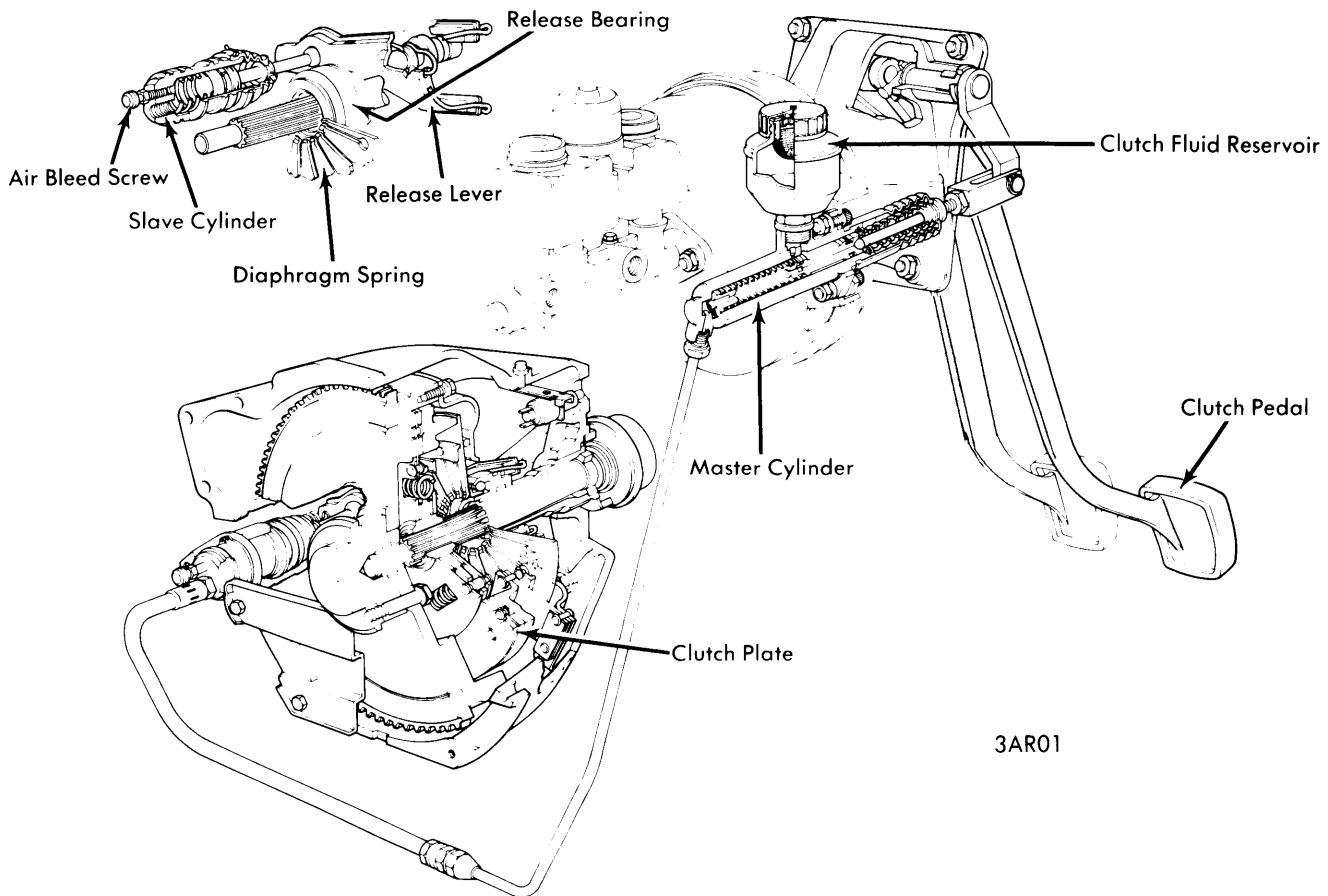

ALFA ROMEO 2000 CLUTCH