

## 1971-72 PLYMOUTH CRICKET

Cricket (1971-72)

## DESCRIPTION

Clutch is dry, single disc, diaphragm spring type. Clutch control linkage is mechanical and uses a cable to control clutch operation.

## REMOVAL &amp; INSTALLATION

## CLUTCH ASSEMBLY

- 1) With car raised on hoist, transmission oil drained, and battery disconnected, disconnect throttle rod from carburetor by removing retaining clip from rod. Remove rod from coupling.
- 2) Remove electrical leads and bolts from starter and remove starter. Remove console (if equipped). Remove gearshift lever cover and lever. Remove bolts and nuts for propeller shaft rear coupling and ease flanges apart. Pull shaft to rear and off of mainshaft spline.
- 3) Disconnect speedometer cable. Disconnect clutch cable by removing lock nut and adjusting nut. Move cable forward from release lever. Remove clutch inspection cover from front lower part of clutch housing.

4) Disconnect exhaust pipe flange from manifold and disconnect back-up light switch. Place jack under front of engine, using block of wood between engine and jack, remove rear support mountings from body, and lower transmission. Remove nuts and bolts from upper part of clutch housing and remove transmission assembly.

5) Loosen clutch cover bolts (one or two turns at a time), remove bolts and clutch cover complete with clutch disc.

6) To install, reverse removal procedure. Sparingly lubricate pilot bushing. Use a suitable aligning arbor (RG541) or spare transmission drive pinion to locate disc.

## CLUTCH CABLE

**Removal** - 1) Remove lock nut and adjusting nut from release lever, remove inner cable from release lever. Remove locating clip and cable from clutch housing opening and engine mounts. Remove clevis pin assembly from clevis at clutch pedal hook and detach cable.

2) Withdraw outer cable from firewall grommet, squeeze grommet next to firewall, and pull it into engine compartment. Remove cable from firewall.

**Installation** - 1) Slide nylon firewall grommet away from outer cable onto inner cable. From engine side, insert inner

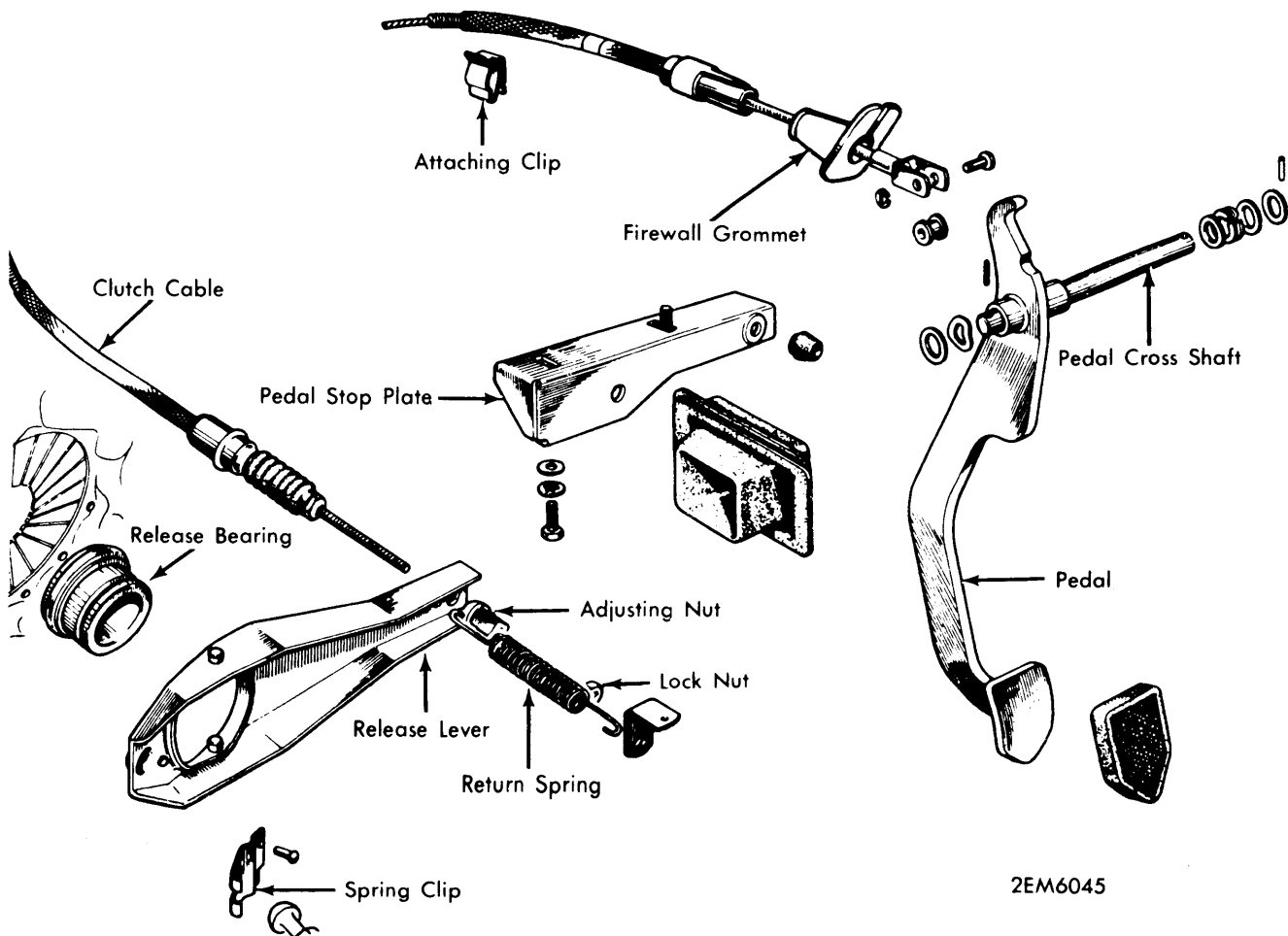

2EM6045

## CLUTCH CONTROL LINKAGE

## 1971-72 PLYMOUTH CRICKET (Cont.)

cable through firewall. With grommet around inner cable, squeeze lower ends together and insert upper end in firewall. Push grommet into place.

2) Using outer cable as a lever, gently force halves of grommet apart. Slide outer cable in place, with key in line with grommet slot, until grommet seats in firewall.

3) Insert clevis pin assembly in clevis to hold inner cable to clutch pedal hook. Pass lower end of cable through engine mount and clutch housing opening. Secure with clip. Pass inner cable through release lever and install adjusting nut.

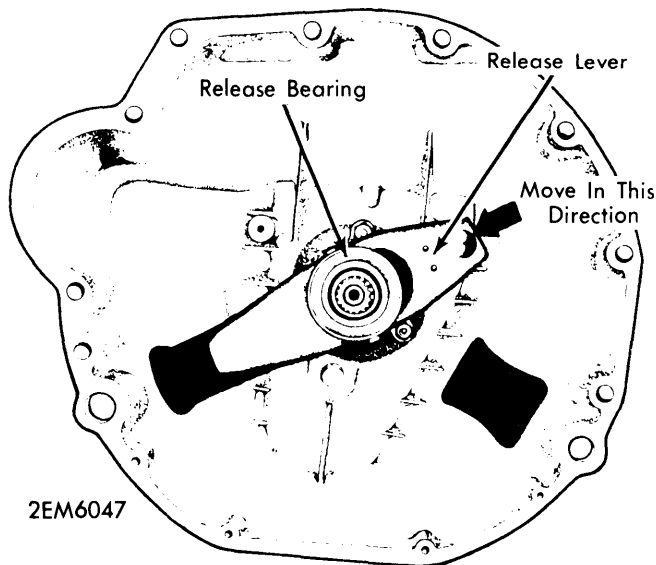

**RELEASE LEVER & BEARING REMOVAL**

### RELEASE LEVER & BEARING

With transmission removed, disconnect return spring from release lever. Move lever down and to the left and down to disconnect lever and spring clip from pivot (see illustration). Disconnect release bearing from lever. To install, reverse removal procedure.

## ADJUSTMENT

### CABLE ADJUSTMENT

Using adjusting nut at release lever, set lever/pedal free play so that free play is  $\frac{3}{16}$ " (4.7 mm) at release lever and  $1\frac{3}{16}$ " (20.6 mm) at pedal. Install and tighten lock nut making sure adjusting nut does not move.

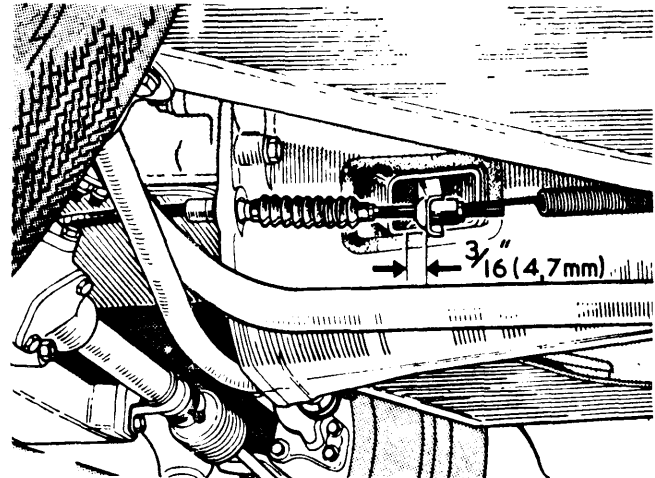

**FREE PLAY MEASUREMENT**

### TIGHTENING SPECIFICATIONS

Application	Ft. Lbs. (mkg)
Clutch Cover Assembly Bolts .....	16 (2.2)
Free Play Adjuster Lock Nut .....	3 (.41)