

## GENERAL MOTORS TAILGATE WINDOW

Buick Estate Wagon  
Chevrolet Imapala, Caprice  
Oldsmobile Custom Cruiser  
Pontiac Safari

### DESCRIPTION

General Motors has one type of power operated tailgate window. Window is operated by an instrument panel switch with the ignition switch at "On" position, or an external key switch located on the right side of the tailgate outer panel. A blockout switch prevents operation of the window by either switch when tailgate is open. When not completely closed, a Tailgate Ajar warning light will appear on the instrument panel. Window is controlled by a gearbox type regulator and 12 volt DC reversible direction motor with an internal circuit breaker. Circuit is also protected by a 30 ampere circuit breaker located at the fuse block. Window will retract into the tailgate door.

### TESTING

#### TAILGATE POWER WINDOW INOPERATIVE FROM PANEL OR TAILGATE KEY SWITCH

Check circuit breaker and replace if bad. If good, check motor ground. If good, check the Tan/White and Lt. Blue wires for short. If not shorted, replace window motor.

#### TAILGATE POWER WINDOW INOPERATIVE FROM PANEL SWITCH, OPERATES FROM TAILGATE KEY SWITCH

If current from fuse block is good, press switch to window "Up" position. Check Lt. Blue wire at back of switch. If no continuity exists, replace switch. If continuity is good, press switch to "Down" position and check Tan/White wire for continuity. If open, replace switch. If good, check window motor ground to body and Lt. Blue and Tan/White wires between switch and motor. **NOTE** – If switch operation is reversed, use same test procedure and replace tailgate key switch if necessary.

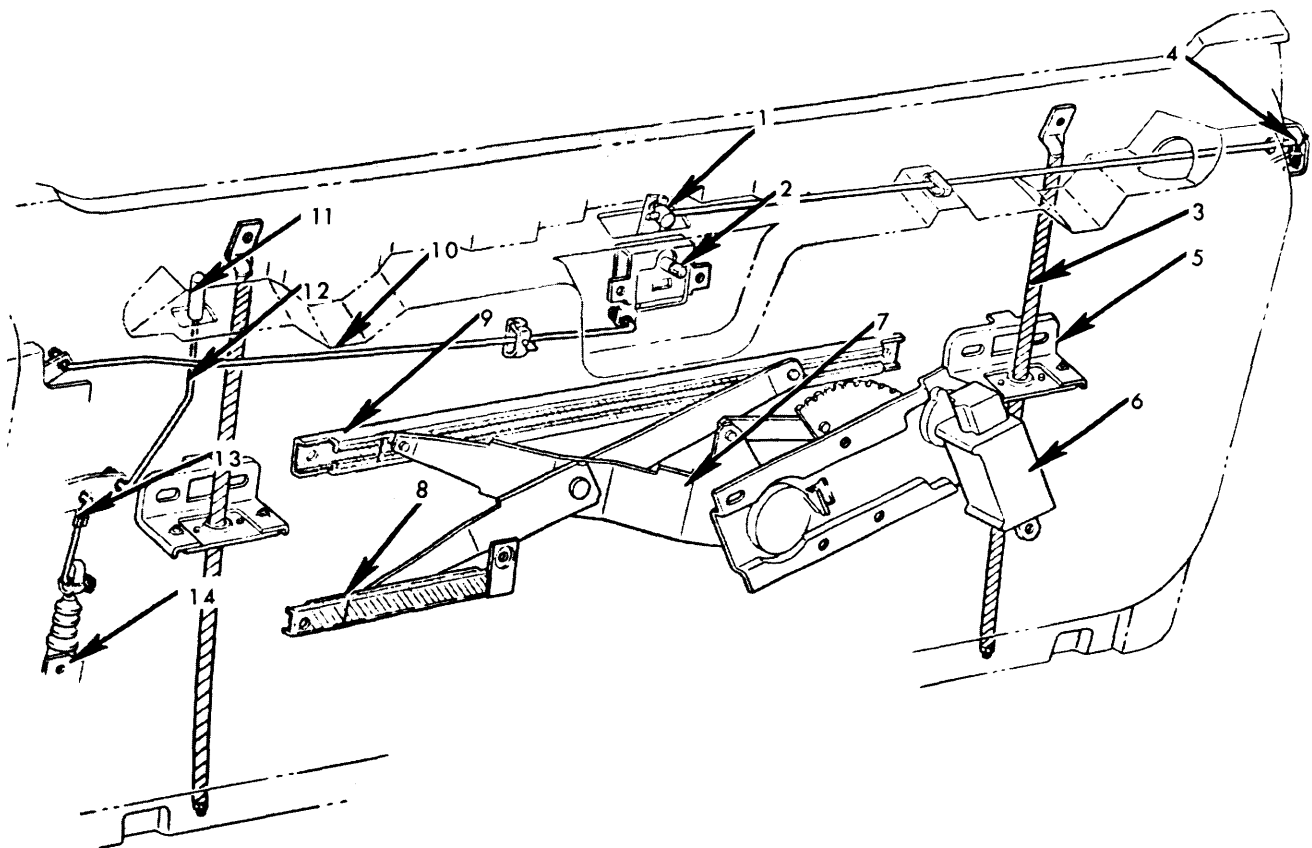

1. Left Lock Rod
2. Remote Control
3. Guide Tube
4. Left Hinge Lock
5. Guide Assembly

6. Motor Regulator
7. Window Regulator
8. Inner Panel Cam
9. Glass Regulator Cam
10. Upper Lock Rod

11. Inside Locking Knob
12. Lock Rod.
13. Rod to Power Actuator
14. Power Actuator

Fig. 1 General Motors Tailgate Power Window Components and Power Lock Components also Shown

## GENERAL MOTORS TAILGATE WINDOW (Cont.)

### TAILGATE WINDOW WILL NOT CLOSE FROM PANEL SWITCH, OTHERWISE OPERATES

With ignition switch "On", taigate door open, put panel switch in "Up" position. Check Lt. Blue wire at back of switch. If no continuity exists, replace panel switch. If good, check Lt. Blue wire at blockout switch, also between blockout switch and motor. If wire is good, replace blockout switch.

### TAILGATE WINDOW WILL NOT OPEN FROM TAILGATE KEY SWITCH, OTHERWISE OPERATES

Open tailgate door, turn key switch to "Down" position and check continuity of Tan/White wire between key switch and window motor. If open, replace key switch. **NOTE** – If window will not close, place switch in "Up" position and check Lt. Blue wire. If open, replace key switch.

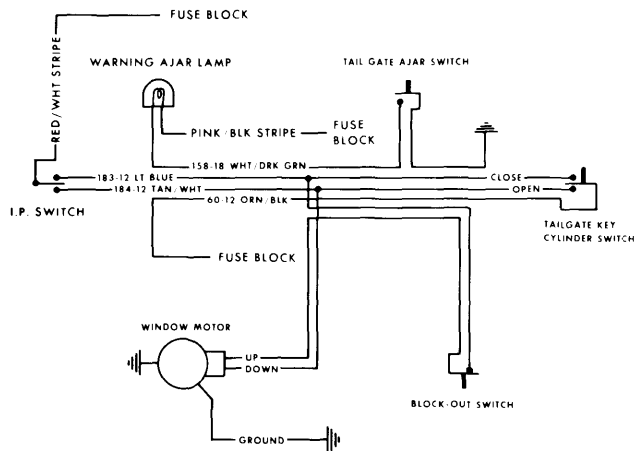

Fig. 2 General Motors Tailgate Power Window Wiring Diagram

## REMOVAL & INSTALLATION

### WINDOW MOTOR

**NOTE** – The electric motor can be removed on all models without removing the window regulator if the glass is intact and attached to the regulator.

1) Remove trim and panel from door. If glass is intact and attached to the regulator, drill out rivet attaching motor to door using a  $\frac{1}{4}$ " drill bit. Using left access hole, remove bolts attaching motor to regulator and remove motor. To install, insure motor drive gear properly engages sector teeth before installing bolts. Use a "U" nut (part no. 3916700 or equivalent) and a  $\frac{1}{4}$ -20x $\frac{7}{16}$ " screw to replace rivet. Install panel and trim.

2) If the window glass is broken or not attached to the regulator, the regulator and motor must be removed as a unit. Use above procedures except, do not remove bolts attaching motor to regulator. Installation will be as a unit.