

CHRYSLER CORP.

Chrysler Corp., All Models

CAUTION — Disconnect fusible link in engine compartment before servicing instrument panel.

DESCRIPTION & OPERATION

Fuel, temperature and oil pressure gauges operate on the constant voltage principle through a voltage limiter. On models equipped with Gauge Alert System, the fuel, temperature and ammeter gauges have a small light emitting diode mounted in gauge dial. Light will illuminate if gauge is functioning other than normal. The electronic sensor circuit is mounted on gauge housing and if gauge or sensor fail, replace as a unit.

Fuel Level Gauge — A hinged float arm in fuel tank raises or lowers depending on fuel level, and contacts a variable resistor in the gauge sending unit. This provides a change of resistance in the fuel gauge circuit. This resistance registers on instrument panel gauge in the form of a level reading.

Temperature & Oil Pressure — The operation of temperature and oil pressure indicating systems are identical in operation with the fuel system, with the exception of the method of varying resistance of sending unit.

In temperature, the resistance of the disc in sending unit varies with a direct relation to coolant temperature. When coolant temperatures are high, resistance is low, when coolant temperatures are low, resistance is high.

In oil pressure, the sending unit resistance is controlled by a diaphragm. The diaphragm is actuated as oil pressure increases or decreases.

Alternator Indicating System — Alternator gauge is an ammeter which senses the direction and rate of flow of electrical current to or from battery, thereby indicating whether battery is being charged or discharged.

TESTING

VOLTAGE LIMITER

To quickly test voltage limiter in vehicle, connect one lead of a voltmeter or test light to temperature sending unit and other lead to a good ground. Leave sending unit wire attached to sending unit. Turn ignition switch on. A fluctuating voltmeter or a flashing light indicates voltage limiter is operating.

FUEL GAUGE

1) Disconnect wire at fuel tank unit. Connect one lead of suitable gauge tester (C-3826) to wire terminal, and other

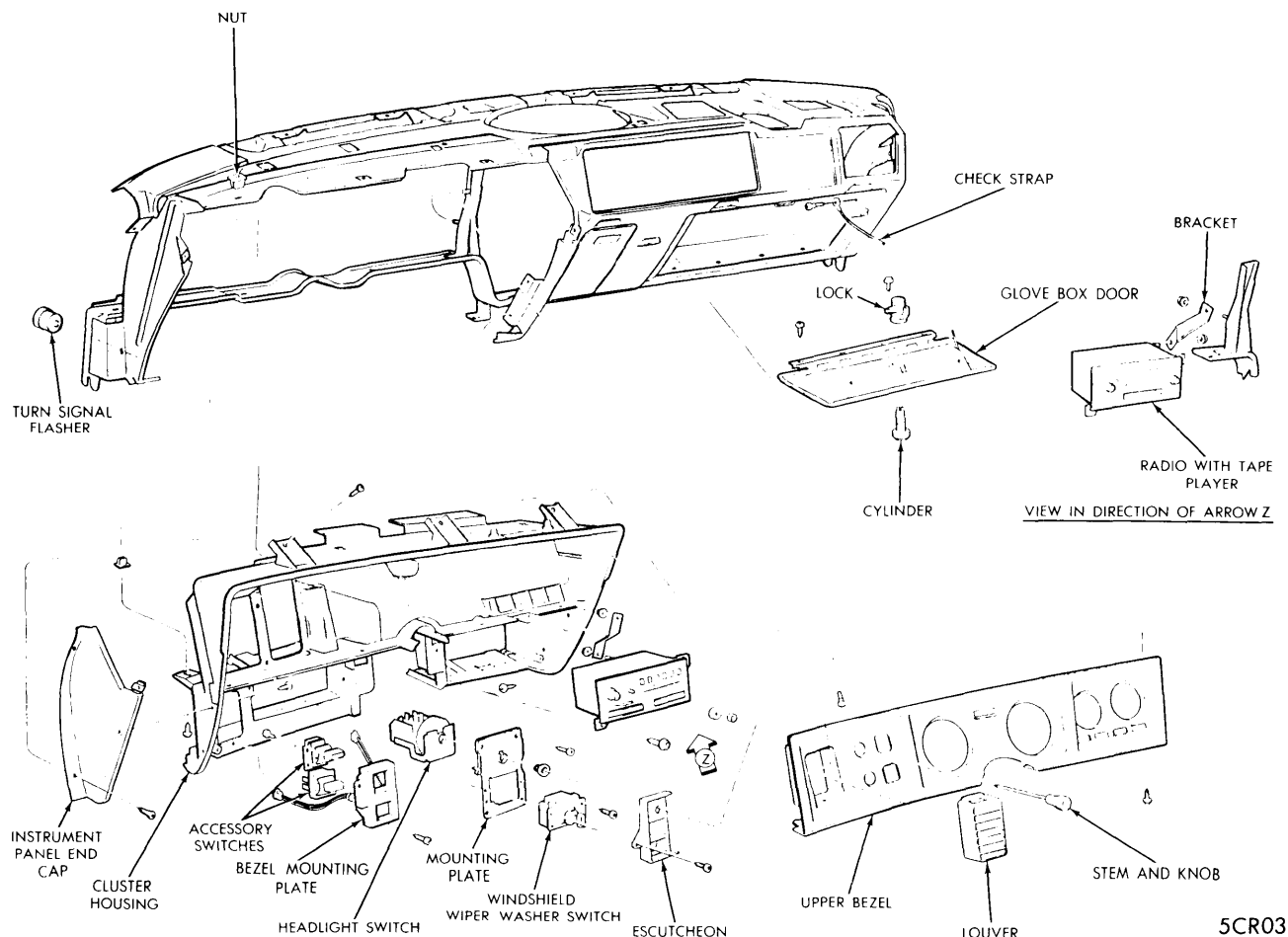

**FURY, CORONET, CORDOBA & CHARGER SE
INSTRUMENT PANEL**

CHRYSLER CORP. (Cont.)

wire and other lead to a good ground. Place tester knob in "L" position, and turn ignition on. Do not start engine. Oil pressure gauge should read "L" plus or minus $\frac{1}{8}$ ". Turn tester knob to "M" position, oil pressure gauge should advance to $\frac{1}{2}$ position on dial. With tester knob in "H" position, gauge should also advance to "H" position. Should gauge respond to the above tests, but fail to operate when connected to vehicle system, indications are of a defective sending unit. Should gauge fail to respond to above tests, indications are; loose connection, broken wire or a faulty gauge.

ADJUSTMENT

STOP LIGHT SWITCH

Switch is located on brake pedal bracket. Adjust switch so stop lights come on when brake pedal pad is depressed $\frac{3}{4}$ " for power brakes and 1" for manual brakes on Dart and Valiant models. For all other models, stop lights should come on when brake pedal is depressed $\frac{1}{2}$ " from released position.

REMOVAL & INSTALLATION

STEERING COLUMN LOWERING & RAISING

NOTE — This procedure is not for removal and installation of steering column and should be used only when necessary.

Lowering — Remove three toe plate bolts. Remove nut attaching horn ground strap to stud on instrument panel and remove ground strap. Remove gear shift pointer (all exc. Dart and Valiant). Remove nuts attaching steering column bracket to support bracket and lower column to seat.

Raising — Reverse lowering procedure insuring that wiring does not get pinched and that column attaching bracket nuts are torqued to 110 INCH lbs. and that toe plate attaching bolts are torqued to 200 INCH lbs.

INSTRUMENT CLUSTER

Dart & Valiant — Remove steering column cover and lower column. From under panel, disconnect speedometer cable. From face of panel remove cluster mounting screws. Pull cluster out from panel, disconnect electrical leads and remove cluster. To install cluster, reverse removal procedure.

Fury, Coronet, Cordoba, Charger SE — Remove trim pad, radio and heater or heater/air conditioner controls. Remove cluster housing reinforcement bracket and from under dash disconnect speedometer cable, all electrical leads and three wiring trough clips. Remove upper cluster bezel, instrument panel end cap and steering column-to-support bracket nuts. Remove nine screws mounting cluster housing to instrument panel and remove cluster housing. To install, reverse removal procedure.

Grand Fury, Monaco — Place gear selector in "L". Remove ash tray and its housing. Remove cigar lighter. Center cluster bezel switches and levers in their openings. Remove bezel mounting screws and pull top of bezel outward to release upper spring clips. Disengage cluster bezel locking tabs from bezel and remove cluster bezel. Remove sub-bezel using pliers to remove nylon attaching pins. To remove cluster lens, remove gear shift pointer. Remove lens-to-cluster housing attaching pins with pliers, then remove lens. To remove speedometer, remove instrument panel upper cover. Working through access

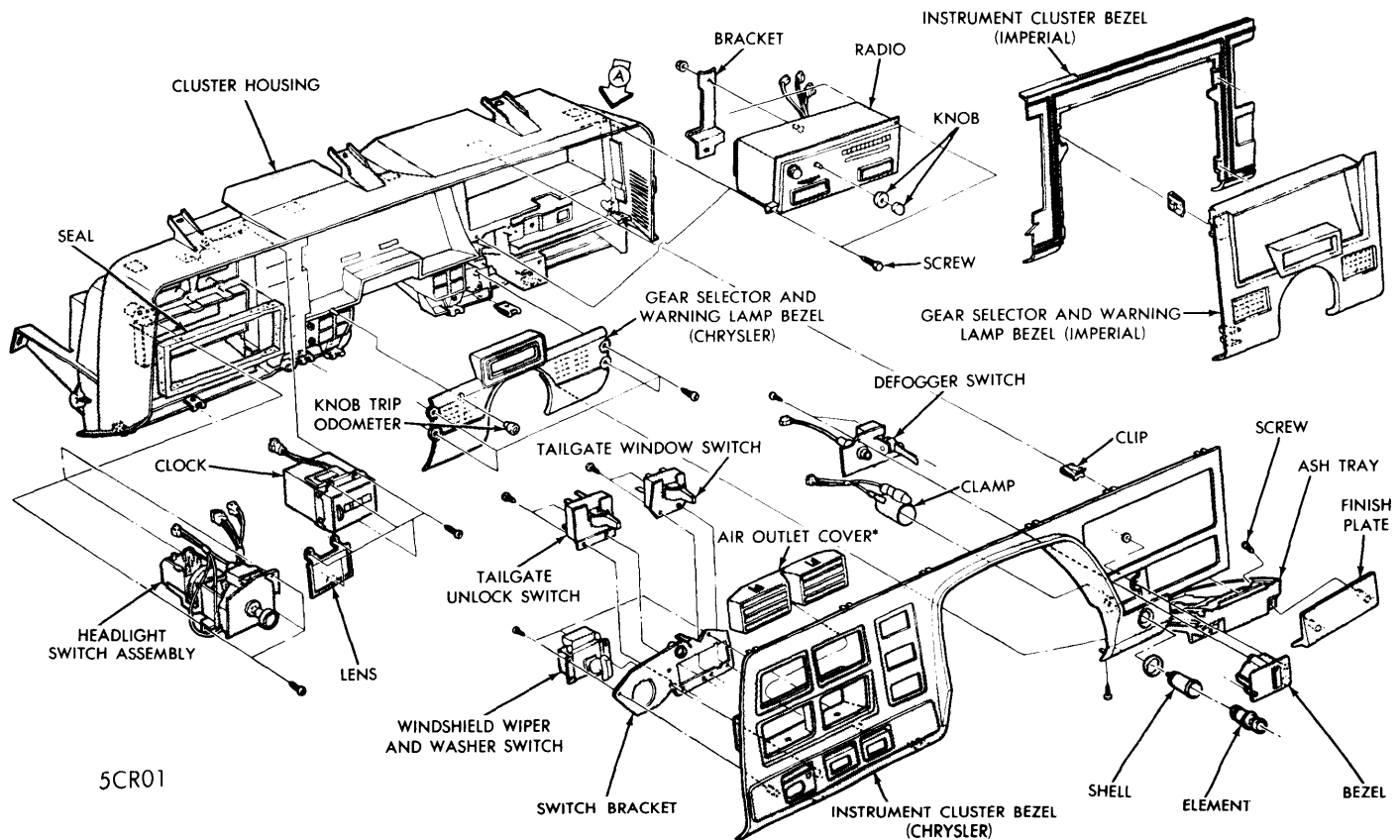

5CR01

CHRYSLER & IMPERIAL INSTRUMENT CLUSTER

CHRYSLER CORP. (Cont.)

hole in top of panel, disconnect speedometer cable. Remove speedometer assembly. Other cluster components may now be removed as required. To install cluster assembly, reverse removal procedure.

Chrysler, Imperial — Place gear selector in "L" position. Remove ash tray and while holding trip odometer reset shaft with needle nose pliers, remove reset shaft knob. Remove gear selector bezel by pulling it from the panel (Imperial) or removing bezel retaining screws (Chrysler). Remove screws along bottom edge of cluster bezel. Center temperature control lever. Disengage clips along top of bezel by pulling bezel out. Disconnect electrical lead and remove bezel. Remove instrument panel upper cover. Working through hole in top of panel, disconnect speedometer cable and round printed circuit board connector. Remove cluster lens by rolling it out from the top. Remove cluster housing-to-cluster carrier screws and pull cluster assembly out enough to disconnect lights, modules and wires. Remove cluster assembly. To install, reverse removal procedure.

SPEEDOMETER & GAUGES

Dart, Valiant — Remove instrument cluster and place it face down on bench. Remove headlight and windshield wiper switch and housing-to-bezel retaining screws. Separate housing from bezel, remove retaining screws from appropriate gauge and lift gauge from back of housing. To install, reverse removal procedure.

Fury, Coronet, Cordoba, Charger SE — Remove instrument panel lens and mask. Disconnect wires or cable from appropriate gauge and remove gauge retaining screws from front of panel. Pull gauge from cluster housing. To install, reverse removal procedure.

Grand Fury, Monaco, Chrysler & Imperial Speedometer — Remove cluster bezel and on Chrysler only, remove gear selector and warning lamp bezel. Remove instrument panel upper cover and working through hole in top of panel, remove speedometer cable, speedometer retaining screws and speedometer. To install, reverse removal procedure.

Grand Fury & Monaco Fuel or Ammeter Gauges — Remove speedometer and appropriate gauge-to-cluster mounting screws. Pull gauge from terminal clip on printed circuit and remove gauge. To install, reverse removal procedure.

Grand Fury & Monaco Oil or Temperature Gauges — Remove cluster bezel and appropriate gauge-to-cluster mounting screws. Pull gauge out, disconnect electrical leads and remove gauge. To install, reverse removal procedure.

Chrysler & Imperial Fuel, Ammeter and Temperature Gauges — Remove cluster bezel and on Chrysler only, remove gear selector and warning lamp bezel. *NOTE* — *Remove fuel and temperature gauges before removing ammeter.* Remove cluster lens and appropriate gauge from circuit board slip terminals. To install, reverse removal procedure.

PRINTED CIRCUIT BOARDS

Remove instrument cluster and all lamps, lamp sockets, switches and gauges which attach to or through printed circuit. Remove circuit board mounting screws (if used) and remove circuit board. To install, reverse removal procedure.

INSTRUMENT PANEL SWITCHES

Switches can be removed from front of instrument panel or from cluster bezel after removing bezel from cluster housing.