

## 1973 PONTIAC

### STOP LIGHT SWITCH

Check stop light whenever brake pedal height changes. Adjust by positioning the switch and bracket in relation to pedal arm.  
**CAUTION** — Be sure switch does not restrict pedal action.

### CLUTCH START SWITCH

Clutch must be fully depressed before car will start. To remove, remove wire connector and bracket retaining screw, then remove switch.

### HEADLIGHT SWITCH

Disconnect battery, pull control knob to full "ON" position. From under dash, depress switch shaft retainer button and remove knob and shaft from switch. Disconnect connector from switch and remove ferrule nut and switch from instrument panel.

### INSTRUMENT CLUSTER

**Ventura II Series** — Disconnect battery and remove steering column trim, remove three screws retaining heater or air conditioning control panel to instrument panel carrier. Remove radio knobs, bezels and nuts. **NOTE** — This permits radio to remain attached to instrument panel reinforcement. Remove screws at top, bottom and side of carrier securing it to instrument panel pad. Disconnect shift quadrant indicator cable at shift bowl (Auto. Trans.); remove two steering column to instrument panel nuts. Remove toe plate to cowl screws and lower steering column from instrument panel. Remove ground wire screw under left side of instrument panel pad above kick pad and disconnect speedometer cable from under dash. Tilt carrier and cluster assembly and rest assembly on top of column. Remove screws from cluster to carrier assembly and remove cluster.

**Catalina, Bonneville & Grandville Series** — Disconnect battery and remove upper and lower instrument panel trim plates. Remove transmission shifter indicator and speedometer cluster bezel. Remove cluster retaining screws, pull rearward, and disconnect speedometer cable and printed circuit. Remove cluster.

**Firebird Series** — Disconnect battery and remove upper instrument panel trim plate, then remove lower instrument panel trim and bracket at steering column. Loosen two steering column nuts to lower column, remove cluster screws, pull rearward and disconnect speedometer cable and printed circuit connector. Remove cluster.

**LeMans Series** — Disconnect battery and remove lower air conditioning duct (if equipped). Remove lower instrument panel trim and glove box, lower steering column and disconnect speedometer and heater cables. Remove three instrument panel screws at gauges, remove three upper right instrument panel nuts. Remove lower instrument panel bolts at right and left ends, and at steering column. Disconnect printed circuit, remove instrument panel harness retaining screws, cluster retaining screws and cluster.

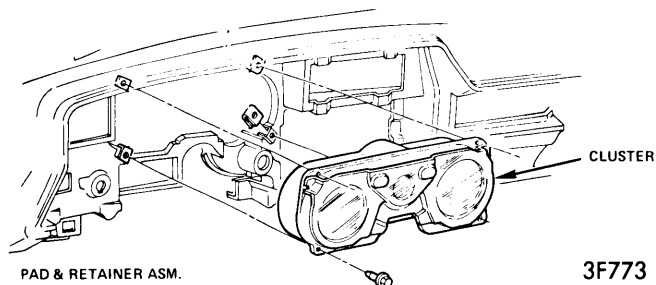

### LEMANS INSTRUMENT CLUSTER REMOVAL

**Grand Prix Series** — Disconnect battery and remove lower air conditioning duct (if equipped). Remove pillar post moldings and filler plate at window, remove lower instrument panel trim at steering column. Disconnect speedometer cable and radio antenna lead, lower steering column and remove upper air outlet and instrument panel attaching screws at steering column, console, ends and upper center. Remove lower defroster duct screw at heater case, position instrument pad outward on steering column. Disconnect printed circuit and remove wire harness retaining screw and cluster ground screw. Remove cluster mounting screws and cluster.

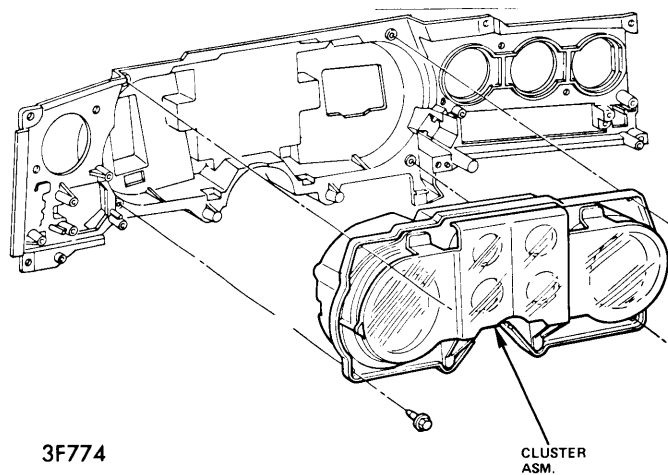

### GRAND PRIX, GRAND AM INSTRUMENT CLUSTER REMOVAL

### PRINTED CIRCUIT

**Ventura II Series** — With instrument carrier and cluster assembly tilted rearward as previously described, work from back of cluster to remove bulb sockets. Remove gauge nut and screws retaining printed circuit to cluster. **NOTE** — When installing, retaining screws must be tight to provide adequate ground.

**LeMans Series** — Disconnect battery. Remove ash tray and lower instrument panel trim plate. Lower steering column. Remove cluster mounting screws, disconnect speedometer cable and printed circuit connector.

**Catalina, Bonneville, Grandville & Firebird Series** — With speedometer cluster removed as previously described, remove cluster bulbs, nuts and printed circuit.

## 1973 PONTIAC (Cont.)

**Grand Prix & Grand Am Series** – Disconnect battery and remove lower air conditioning duct (if equipped), remove pillar post moldings and filler plate at windshield. Remove lower instrument panel trim at steering column, disconnect speedometer cable and lower steering column. Remove upper air outlet ducts and instrument panel attaching screws at steering column, console, ends and upper center. Remove lower defroster duct screws, position crash pad rearward on steering column, disconnect wire connector to printed circuit, remove bulbs, ground, screws, gauge terminal nuts retaining printed circuit to cluster, and remove printed circuit.

**INSTRUMENT PANEL PAD**

**Catalina, Bonneville & Grandville Series** – Disconnect battery and remove upper and lower instrument panel trim plates. Remove wiper and headlight switch bezel and disconnect connectors, remove heater or air conditioning bezel. Remove cluster bezel and speedometer cluster (includes removal of automatic shift quadrant). Remove glove box and radio, remove plastic upper panel and six upper panel to steel extension screws. Remove left and right pillar moldings, remove three left upper instrument panel pad screws, steering column brace, and center panel support. Disconnect parking brake cable at foot pedal bracket, remove instrument panel wire harness clips. *NOTE* – *Instrument panel wire harness remains in car.* Remove left and right instrument panel pad bolts, air conditioning duct extension, under steering column (if equipped), and lower steering column. With column protected tilt rearward and disconnect all miscellaneous connectors, and remove pad from car.

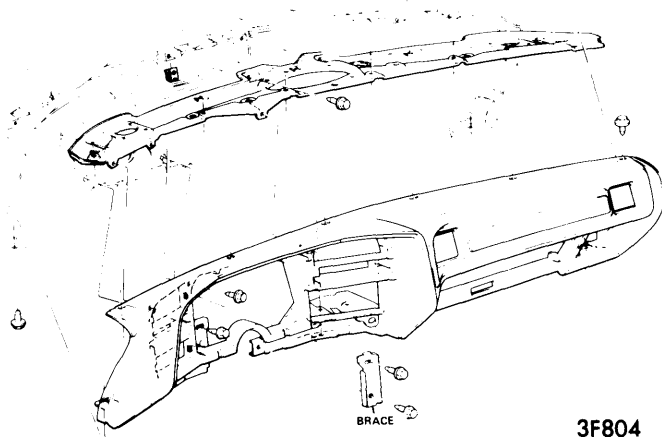

**CATALINA, BONNEVILLE, GRAND VILLE  
INSTRUMENT PANEL PAD REMOVAL**

**LeMans & Grand Prix Series** – Disconnect battery and remove ash tray, glove box and lower instrument panel trim. Remove upper instrument panel trim by removing two screws on top and one screw thru opening in glove box. Separate fuse block, disconnect dimmer switch, door jamb switch, neutral safety switch, back-up lamp switch, body harness and ignition switch. Disconnect vacuum harness and temperature control cable at control panel. Lower steering column and remove speedo cable. Remove instrument panel attaching bolts (four on top and four on bottom). Remove center instrument panel support brace. Remove entire assembly from car.

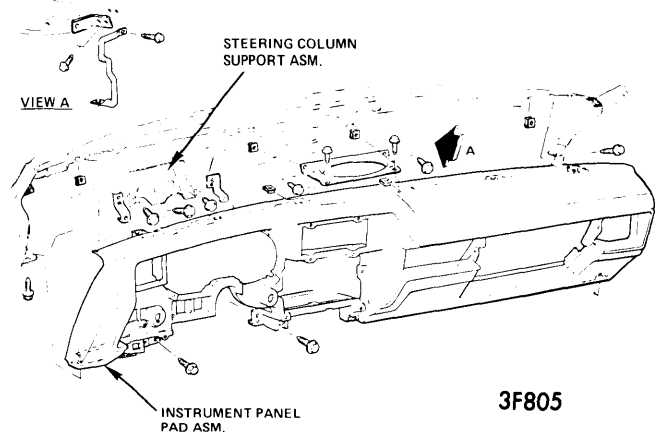

**LEMANS, GRAND AM INSTRUMENT  
PANEL PAD REMOVAL**

**Firebird Series** – Disconnect and separate fuse block from bulkhead. Remove upper and lower instrument panel trim plates. Remove left garnish molding, left lower instrument panel brace (under steering column), and remove toe plate. Remove left instrument panel pad bolts (one lower and three upper) and fuse block screws. Disconnect body connectors, dimmer, brake, and left door jamb switch. Remove speedo cable and lower steering column. Disconnect ignition, neutralizer, turn signal, and back-up switches. Remove glove box and door, and right garnish molding. Remove right lower instrument panel bolt, upper nuts and disconnect right door jamb switch connector, temperature cable and any miscellaneous connectors. Cover steering column and position complete pad rearward on column and disconnect any remaining connectors. Remove pad from vehicle.

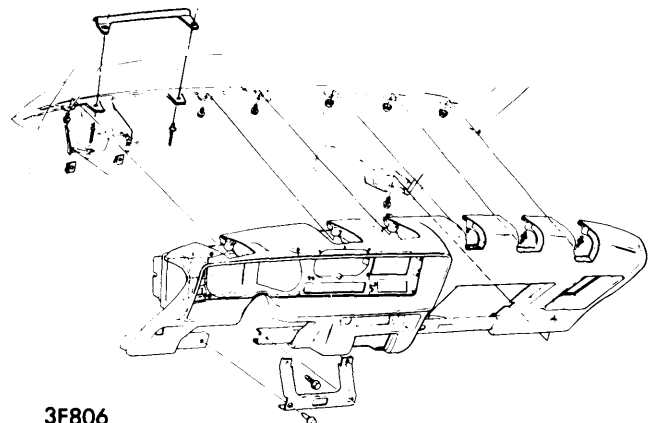

**FIREBIRD INSTRUMENT PANEL PAD REMOVAL**

**Ventura Series** – Disconnect battery and remove glove box. Remove four instrument panel pad nuts (above glove box and ash tray), then remove right side pad screw, near pillar post. Remove five upper carrier screws and left side carrier screw, near left pillar post, then remove steering column cover and disconnect shift quadrant indicator cable at shift bowl (Auto. Trans.). Remove two steering column nuts at instrument panel and remove two lower heater screws. Remove toe plate cover and five toe plate to cowl screws and lower steering column. Disconnect speedo cable, protect column, tilt carrier assembly rearward and rest on column. Remove upper left hand instrument panel pad screw and nut, then remove pad from car.