

# 4-122 Switches, Gauges & Speedometer

## 1974 DODGE & PLYMOUTH

### STOP LIGHT SWITCH

Switch is located on brake pedal bracket. Adjust switch so stop lights come on when brake pedal pad is depressed  $\frac{3}{4}$ " for power brakes and 1" for manual brakes on Dart and Valiant models. For all other models, stop lights should come on when brake pedal pad is depressed  $\frac{1}{2}$ " from released position.

### SPEEDOMETER & GAUGES

Speedometer and all instruments can be removed or serviced after instrument cluster has been removed.

### PRINTED CIRCUIT BOARD

Can be serviced after instrument cluster has been removed.

**CAUTION** — Disconnect fusible link in engine compartment before servicing instrument panel.

### STEERING COLUMN LOWERING & RAISING

When necessary to lower steering column, use the following procedure. **NOTE** — This procedure is not for removal and installation of steering column.

**Lowering Steering Column** — Disconnect fusible link. Loosen two "O" ring retainer plate bolts (Barracuda & Challenger only). Remove three tow plate bolts. Remove nut attaching horn ground strap to stud on instrument panel and remove ground strap. Remove gear shift pointer (all exc. Dart & Valiant). Remove nuts attaching steering column bracket to instrument panel steering column support bracket. Lower column to seat.

**Raising Steering Column** — Raise column against instrument panel support bracket and install nuts finger tight only. Check that all wiring is clear and not pinched. Torque bracket nuts to 110 INCH lbs. Slide toe plate into position, install attaching bolts and torque to 200 INCH lbs. **CAUTION** — On single coupling column (Valiant, Dart, Barracuda & Challenger) models, toe plate must not be forced to align. Bolts must start freely and clear sides of holes in toe plate. Torque "O" ring retainer plate bolts to 200 INCH lbs. (Barracuda & Challenger only). Install horn ground strap. Install gear shift pointer and adjust gear shift linkage. See Chrysler Corp. Transmissions in TRANSMISSION Section.

### INSTRUMENT CLUSTER REMOVAL

**Dart & Valiant** — Remove steering column cover and lower column. From under panel, disconnect speedometer cable. From face of panel remove cluster mounting screws. Pull cluster out from panel, disconnect electrical leads and remove cluster. To install cluster, reverse removal procedure.

**Challenger & Barracuda** — **NOTE** — Place a protective cover over top of instrument panel and steering column. Remove light panel mounting screws. Carefully slide light panel out and lay on top of instrument panel. It is not necessary to disconnect wiring harness. Remove switch bezel screws and let bezel hang loose. It is not necessary to disconnect switches. Lower steering column as previously outlined. From under panel, disconnect speedometer cable. Remove cluster bezel screws and angle bezel out to clear the clock reset button. Reach between bezel and panel and disconnect stereo control wiring harness (if equipped). With Rallye cluster, clock reset knob and odometer reset knob must be removed from cluster bezel to remove clock. Remove cluster-to-panel screws, disconnect necessary wiring harnesses and remove cluster. To install cluster, reverse removal procedure.

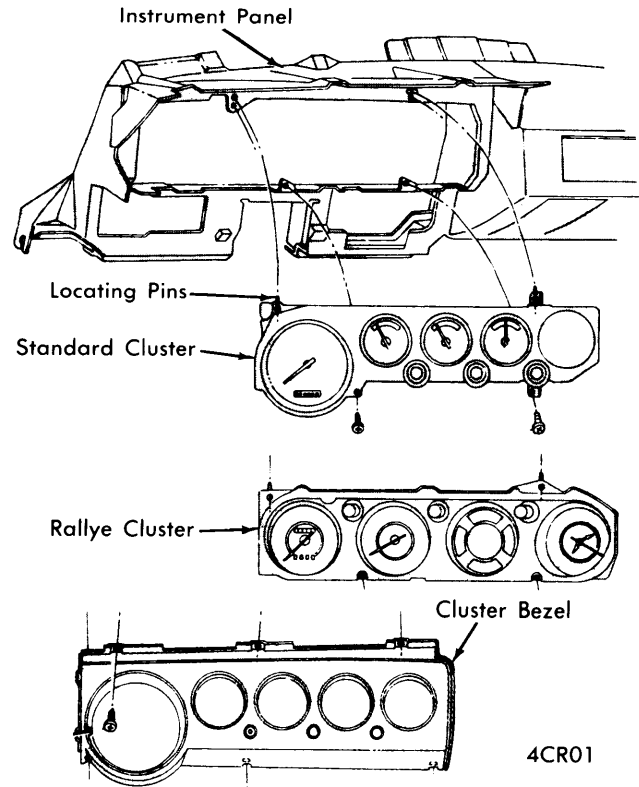

### BARRACUDA, CHALLENGER INSTRUMENT CLUSTER

**Charger, Coronet, Satellite (Std. Cluster)** — Remove radio. Remove heater and/or air conditioner control and allow to hang. Lower steering column as previously outlined. From under panel, disconnect speedometer cable, all electrical leads, and remove two screws attaching cluster housing to lower reinforcement. From face of panel, remove cluster-to-panel screws and remove cluster. To install, reverse removal procedure.

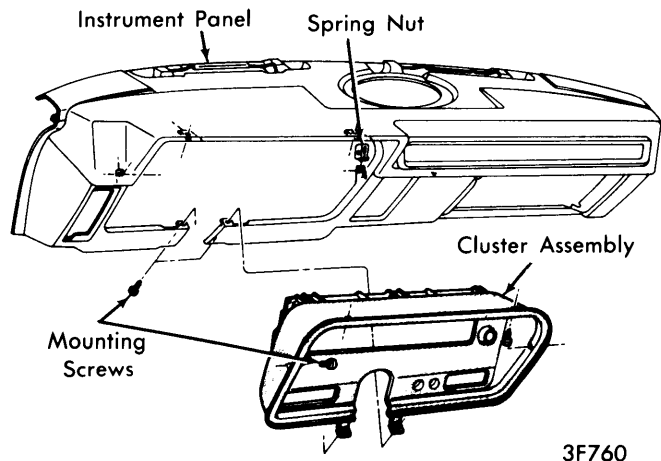

### CORONET, CHARGER, SATELLITE INSTRUMENT CLUSTER

# Switches, Gauges & Speedometer 4-123

## 1974 DODGE & PLYMOUTH (Cont.)

**Charger, Coronet, Satellite (Rallye Cluster)** — Remove radio. Remove electrical leads and lights from right rear of instrument cluster. Disconnect speedometer cable. Remove heater control support bracket mounting screw from rear of cluster housing. Remove heater control mounting nuts and allow control to hang. Lower steering column as previously outlined. From under panel, disconnect remaining electrical leads and remove lights from left rear of cluster. Remove screws attaching cluster to lower reinforcement. From face of panel, remove screws and cluster assembly. To install cluster, reverse removal procedure.

**Fury & Monaco** — Place gear selector in "L". Remove ash tray and its housing. Remove cigar lighter. Center cluster bezel

switches and levers in their openings. Remove bezel mounting screws and pull top of bezel outward to release upper spring clips. Disengage cluster bezel locking tabs from bezel and remove cluster bezel. Remove sub-bezel using pliers to remove nylon attaching pins. To remove cluster lens, remove gear shift pointer. Remove lens-to-cluster housing attaching pins with pliers, then remove lens. To remove speedometer, remove instrument panel upper cover. Working through access hole in top of panel, disconnect speedometer cable. Remove speedometer assembly. Other cluster components may now be removed as required. To install cluster assembly, reverse removal procedure.

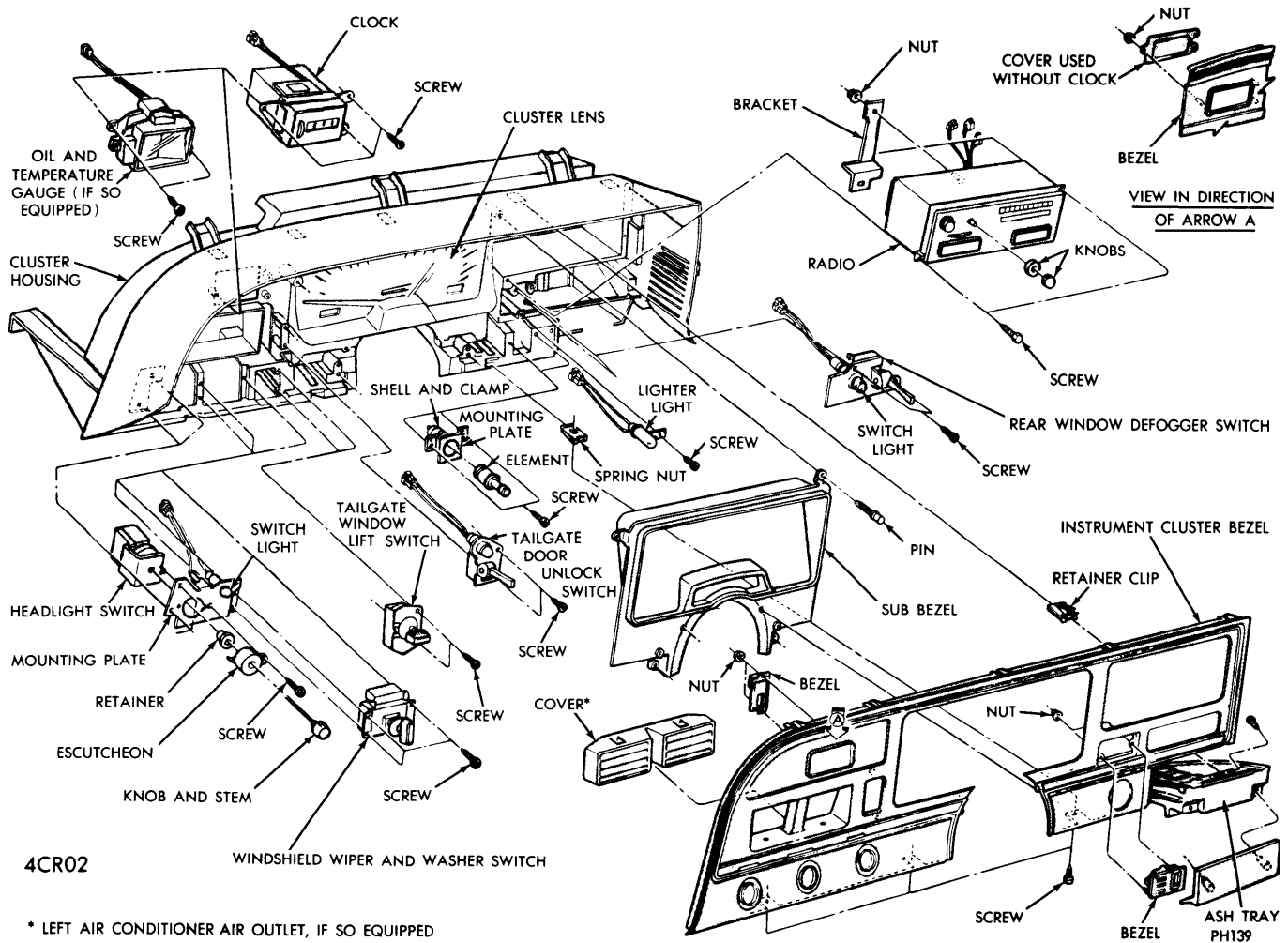

4CR02

\* LEFT AIR CONDITIONER AIR OUTLET, IF SO EQUIPPED

**FURY, MONACO INSTRUMENT CLUSTER**