

1969-72 CHRYSLER CORP. VACUUM

DESCRIPTION

A vacuum actuated lid lock releasing system, consisting of a vacuum tank (mounted over the right front wheel housing), a push button control switch (located in the glove box), and a vacuum actuator assembly (connected to the lock). Rubber hoses are used to connect components. Since this is only a releasing system, lid must be closed manually.

OPERATION

Engaging the push button switch actuates the vacuum from the tank and extends vacuum to the actuator assembly which in turn raises the lock from the striker.

DIAGNOSIS & TROUBLESHOOTING

If a system failure occurs and is accompanied with a rough engine idle, remove hose from manifold fitting tube and plug end of tube. If idle improves, inspect all hoses for leaks or breaks. If system fails entirely, remove vacuum hose at actuator assembly in deck lid and connect a vacuum gauge to hose. With engine running, engage switch in glove box and note reading on vacuum gauge. If no reading is obtained, inspect for a pinched hose. A reading of less than 16 inches will indicate a leak in system.

9F2027

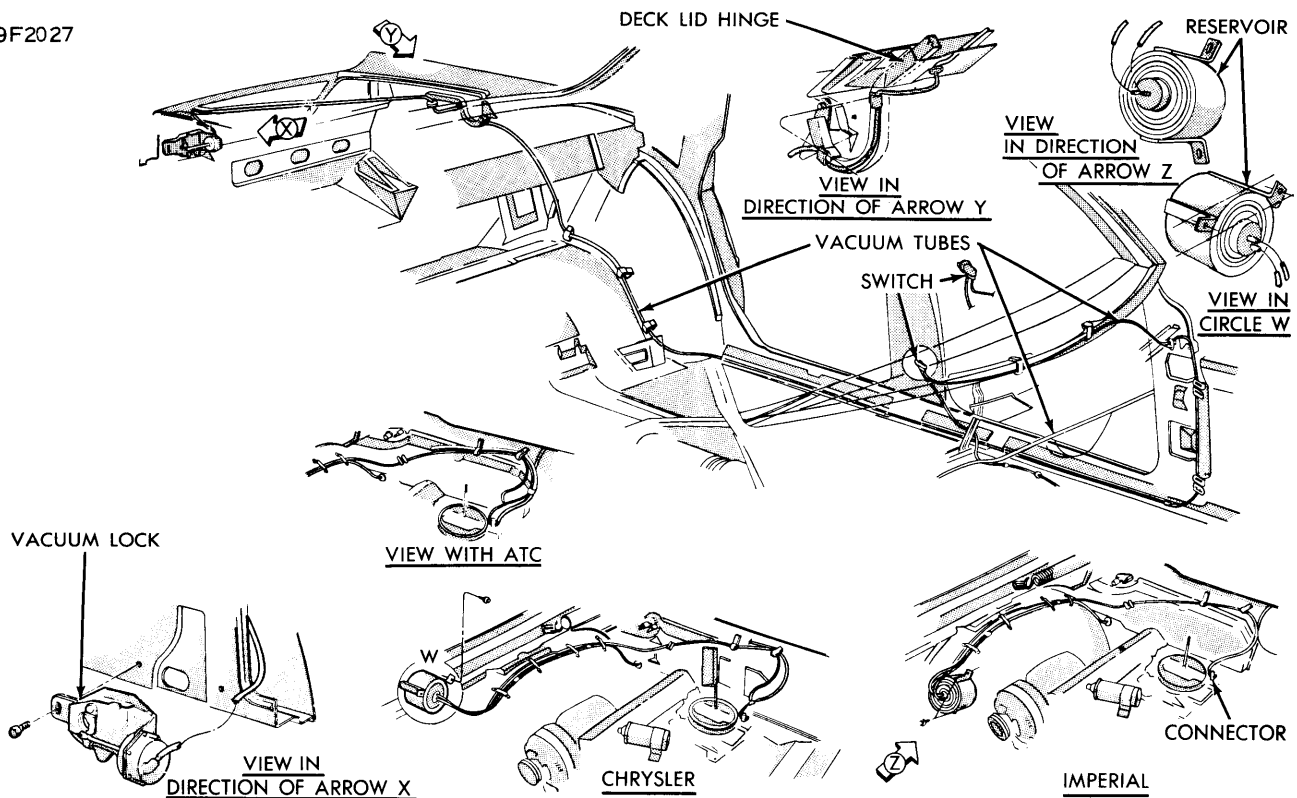

VACUUM ACTUATED LID LOCK ASSEMBLY CHRYSLER & IMPERIAL (OTHERS TYPICAL)