

## CHRYSLER CORP. STEERING COLUMNS

All Models (Except Tilt Wheel)

### DESCRIPTION

Chrysler steering columns are designed with impact-absorbing features to protect the driver in the event of a head-on collision. The column housing is made of slotted steel mesh and will deform upon impact. The steering shaft and shift shaft (column shift vehicles) are each made of telescoping 2-piece shafts, interconnected by plastic inserts. These shafts will collapse on impact. The steering column-to-instrument panel mounting bracket is designed to let the column compress or collapse away from the driver, but prevents rearward movement toward the driver.

**CAUTION** — When working on a collapsible steering column, do not hammer on or bump column components. With column removed from mounts, it is extremely susceptible to impact damage. A slight impact on column end may collapse steering shaft or loosen plastic injections that maintain column rigidity. When removing steering wheel, use a puller, but do not hammer or pound on any components to aid in removal.

### REMOVAL & INSTALLATION

**Removal** — 1) Disconnect battery ground cable. Remove steering wheel. Disconnect any wiring harness connectors from

steering column. Disconnect shift linkage from steering column (if applicable). On RWD models, disconnect intermediate shaft from steering gear by driving roll pin out of lower coupling. On FWD models, equipped with and under-dash "U" joint, drive lower roll pin from upper "U" joint.

2) On all models, remove any trim panels, wiring harness and cowl seals that may interfere with column removal. Disconnect shift indicator pointer from column (if applicable). Remove steering column attaching bolts. Pull column gently into passenger compartment, using care not to damage any adjoining components or trim. On FWD models, without under-dash "U" joint, replace anti-rattle clip into lower coupling assembly. On all column shift models, remove and discard shift lever grommet.

**Installation** — To install, reverse removal procedure and note the following: Lubricate all wear surfaces with chassis lubricant. Make sure to align all shafts and readjust shift linkage and pointer (if applicable). Do not crush break-away capsles when retightening. Always replace shift linkage bushing whenever shift rod is removed.

### DISASSEMBLY & REASSEMBLY

**Disassembly** — 1) Remove trim schrouds and covers. Remove all column-mounted switches and lock cylinder. See *Steering*

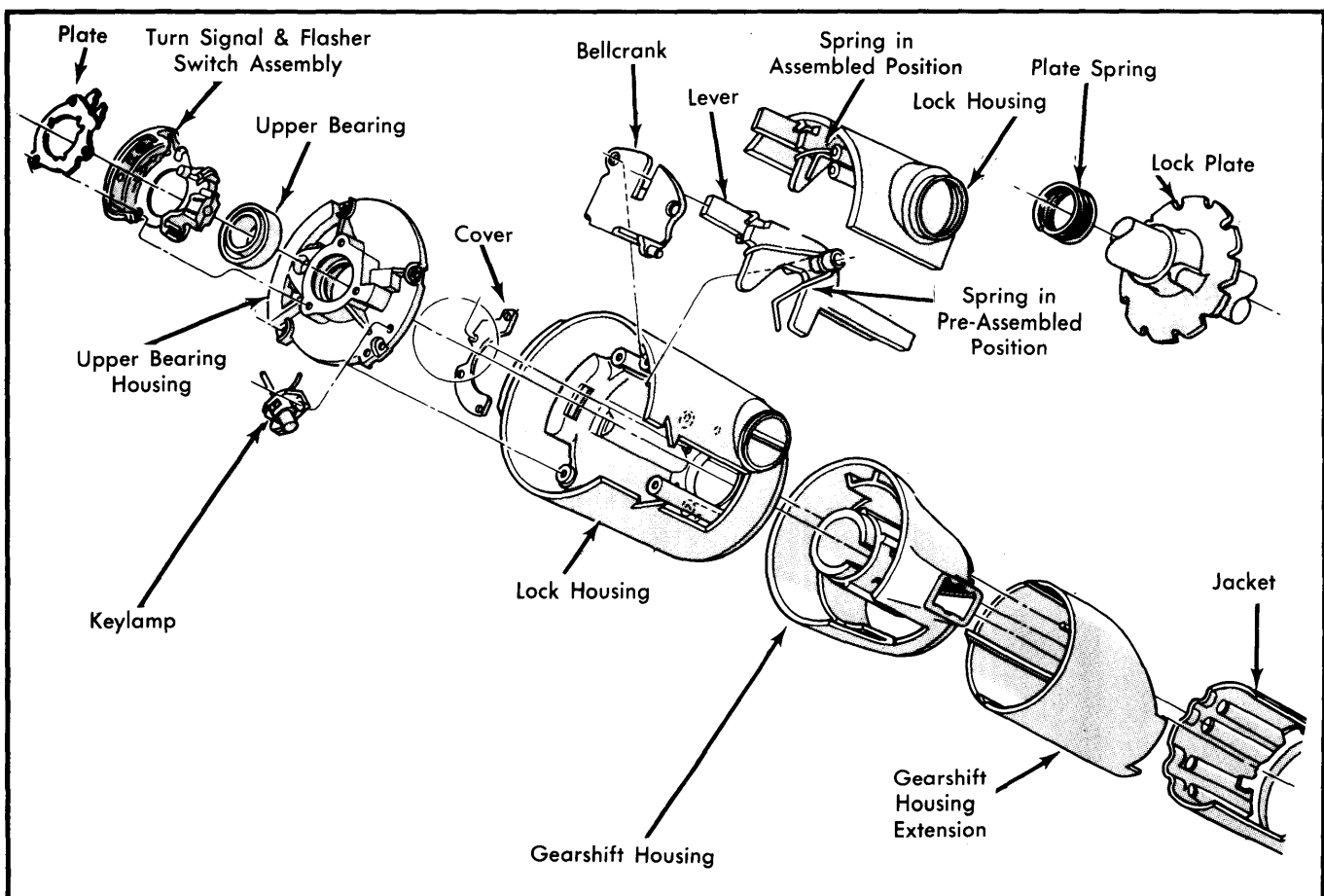

Fig. 1 Chrysler Corp. (Exc. Horizon, Omni & Rampage) Steering Column Upper End

# Steering Columns

## CHRYSLER CORP. STEERING COLUMNS (Cont.)

Column Switches article in this Section. Remove key lamp and wiring from column.

2) Remove bearing housing attaching screws (if applicable). Remove snap ring from upper end of steering column. Remove bearing housing, lock spring and lock plate from steering shaft. Remove steering shaft through lower end of column.

3) Remove upper and lower column bearings from housing. On models equipped with a separate lock housing, remove 2 screws attaching bellcrank. Slide bellcrank up into lock housing until it can be disconnected from ignition switch actuator rod. Remove lock housing retaining screws. Remove lock housing plate and housing from jacket.

4) On column shift models, remove set screw (if equipped) from shift housing. If shift housing is not equipped with a set

screw, it will be necessary to press shift tube out of housing, using a puller (C-4584).

**Reassembly** — To reassemble, reverse disassembly procedure and note the following: Lubricate all wear surfaces with chassis lube prior to assembly. Check operation of all switches and lock cylinder after reassembly. On column shift models, check operation of shifter.

| TIGHTENING SPECIFICATIONS      |                    |
|--------------------------------|--------------------|
| Application                    | Fr. Lbs. (N·m)     |
| Steering Wheel Nut .....       | 45 (61)            |
| Column Support Bracket Nut     |                    |
| Rear Wheel Drive Models .....  | 17 (23)            |
| Front Wheel Drive Models ..... | 105 INCH Lbs. (12) |

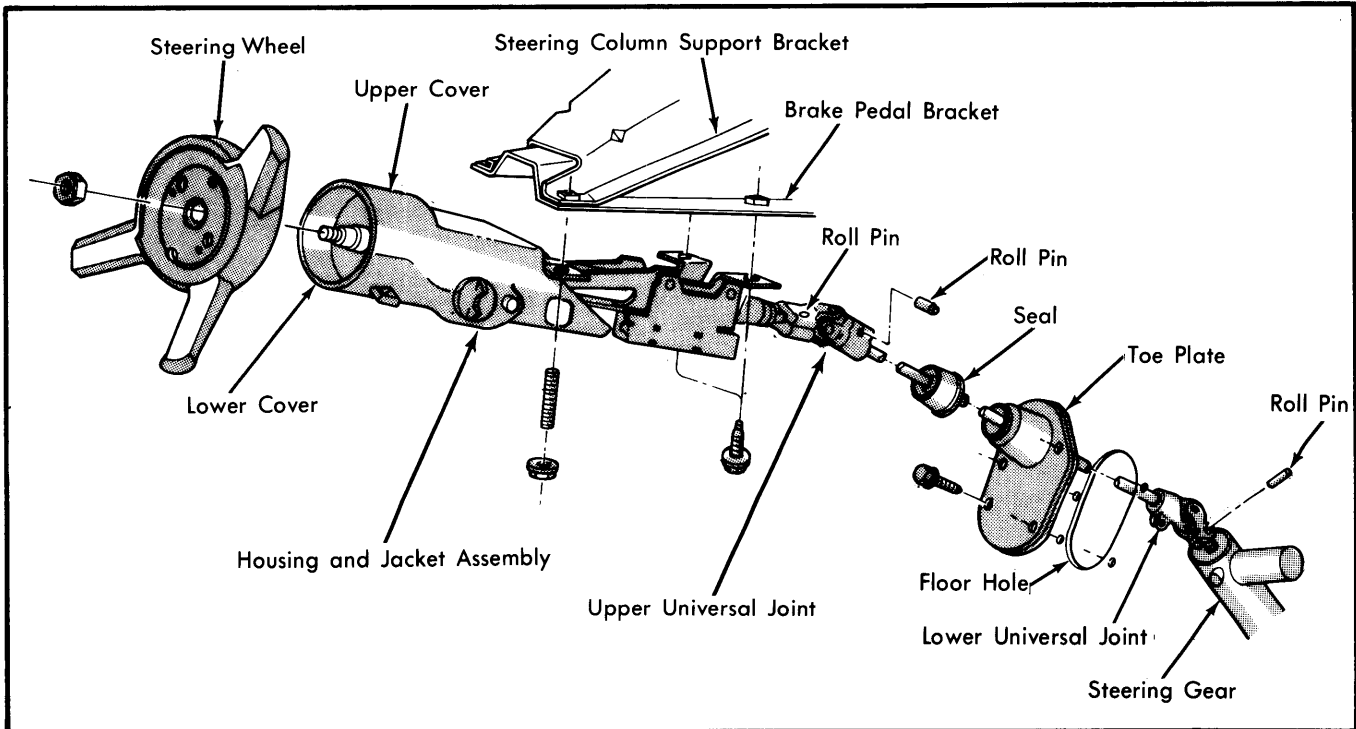

Fig. 2 Chrysler Corp. (Horizon, Omni & Rampage) Steering Column Assembly