

# Front & Rear Suspension

## FORD, MERCURY, THUNDERBIRD, CONTINENTAL, MARK IV REAR

Ford  
Mercury  
Cougar  
Meteor  
Torino  
Montego  
Thunderbird  
Continental  
Mark IV

### ADJUSTMENT

#### RIDING HEIGHT

See *Riding Height Adjustment and Specifications* in **WHEEL ALIGNMENT** Section.

#### PINION ANGLE

See *Propeller Shaft Alignment* in **REAR AXLE** Section.

### DESCRIPTION

Rear axle housing is suspended from frame by upper and lower control arms and shock absorbers. Cougar, Torino, Montego, Thunderbird and Mark IV have two upper and two lower control arms. All other models have one upper arm and two lower arms and a track bar. Each coil spring is mounted between lower seat on axle housing and upper seat which is integral with frame. On single upper arm units, arm attaches to right side of axle housing through eccentric pivot bolt and to frame crossmember. Track bar connects between upper arm bracket and mounting bracket at left frame side rail. Rear stabilizer bar is standard on Mark IV and Thunderbird. On Torino, Montego and Cougar models stabilizer bar comes optional with special handling equipment.

### REMOVAL & INSTALLATION

#### COIL SPRING

**Removal** — Raise vehicle on hoist (supporting axle) and place jack stands under side rails. Disconnect lower shock absorber mounting. On Ford, Mercury, Meteor, and Continental, disconnect brake hose from brake tube and remove hose bracket clip. Lower hoist and axle housing until coil springs are released. Remove springs and insulators from vehicle.

**Installation** — Reverse removal procedure and tighten nuts and bolts.

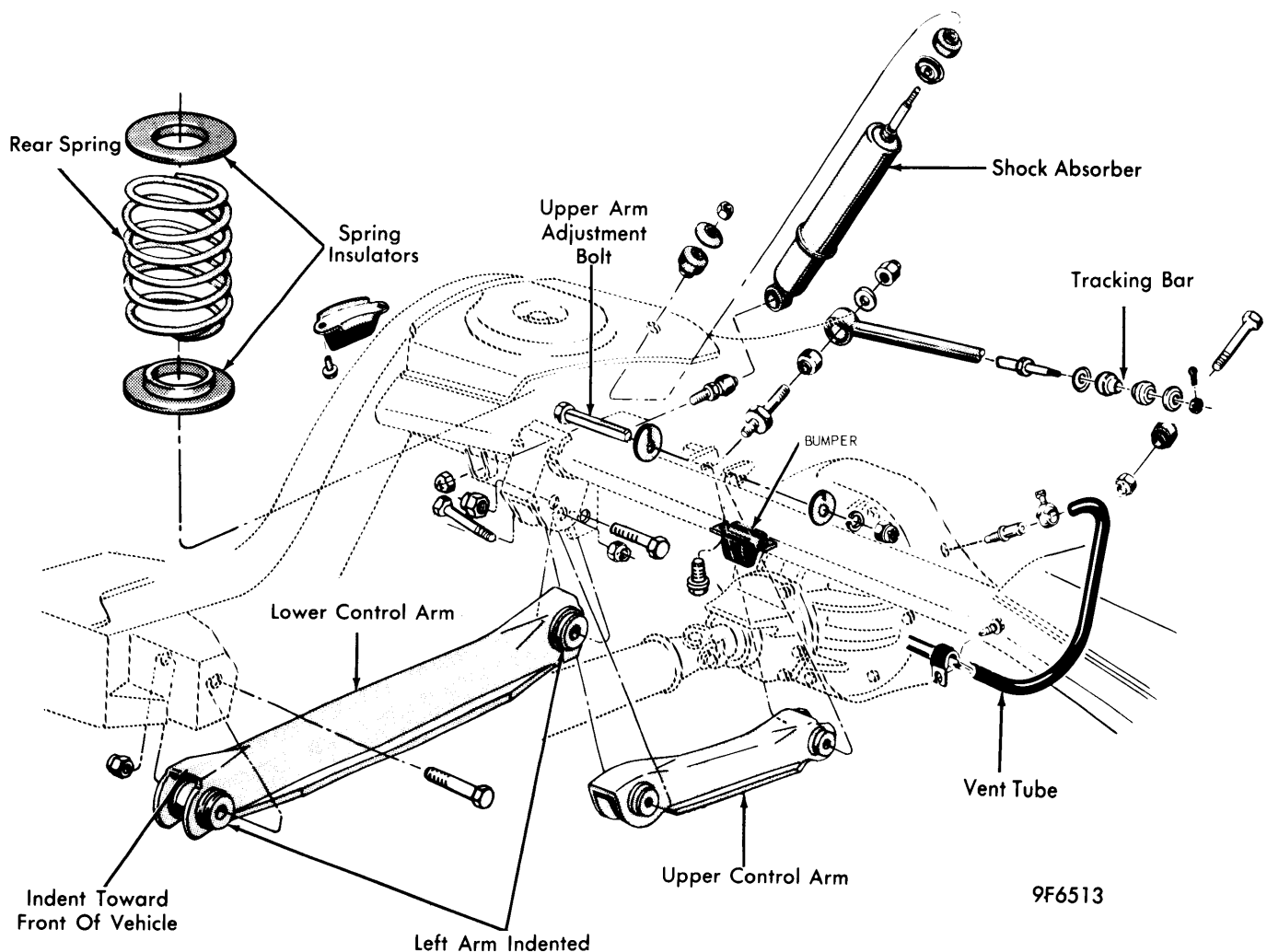

**REAR SUSPENSION ASSEMBLY**

## FORD, MERCURY, THUNDERBIRD, CONTINENTAL, MARK IV REAR (Cont.)

### LOWER CONTROL ARM

**Removal** — *NOTE* — When one lower control arm requires replacement, both lower control arms must be replaced. Raise vehicle on hoist and place jack stands under frame side rails. Detach track bar from frame mounting bracket. Lower axle enough to relieve spring pressure. Support axle under pinion nose and under axle housing, unbolt lower arm from axle bracket, and disengage arm from mounting. Remove pivot bolt from frame bracket and withdraw control arm from vehicle.

**Installation** — Reverse removal procedure, noting the following: Do not torque pivot bolts until both are in place and axle is raised to proper position.

### UPPER CONTROL ARM

**Removal** — *NOTE* — On Cougar, Torino, Montego, Thunderbird and Mark IV models, if one upper control arm requires replacement, other upper control arm must also be replaced. Raise vehicle and support frame side rails with jack stands. Support axle. Remove track bar (if equipped) from frame bracket. Lower and support axle under housing and differential pinion nose. Detach upper arm from axle housing. Unbolt arm from crossmember. Remove arm from vehicle.

**Installation** — Reverse removal procedure, noting the following: Do not torque bolts until arm is in place, track bar installed, and axle raised to proper position. Adjust pinion angle.

### TRACK BAR (CONTINENTAL, FORD, MERCURY, & METEOR)

**Removal** — Raise vehicle on axle contact hoist. Remove rubber cover at axle attachment on track bar. Detach track bar from upper arm bracket. Unbolt track bar from frame side rail. Remove bar from vehicle.

**Installation** — Reverse removal procedure, using new attaching nuts and bolts.

### STABILIZER BAR

**Removal** — Raise vehicle, with floor jack, at axle housing. Unbolt stabilizer bar from link assemblies at both sides. Remove nuts retaining mounting bracket to lower mounting clamp. Remove stabilizer bar from vehicle.

**Installation** — Place new axle insulators on stabilizer bar and position bar in vehicle. *NOTE* — Colored coded end of bar must be on left hand side. Install new nuts retaining mounting brackets to lower clamps. Tighten nuts and bolts. Install new bolts and nuts retaining rear link assemblies to stabilizer bar. *NOTE* — Bolts must be installed from outboard side.

### TIGHTENING SPECIFICATIONS

Application	Ft. Lbs.
Shock Absorber (Upper).....	14-26
Upper Arm-to-Axle, Nut	
Ford, Merc., Meteor, Cont. Only .....	65-85
Upper Arm-to-Axle, Bolt	
Ford, Merc., Meteor, Cont. ....	100-130
T-Bird, Mk IV, Torino, Montego .....	90-120
Track Bar-to-Axle Bar Stud	
Ford, Merc., Meteor .....	70-90
Continental.....	85-100
Track Bar Stud-to-Axle	
Ford, Merc., Meteor, Cont. ....	90-150
Track Bar-to-Frame	
Ford, Merc., Meteor, Cont. ....	70-90
Shock Absorber (Lower) .....	50-85
Lower Arm-to-Axle	
Bolt — Ford, Merc., Meteor, Cont. ....	90-120
Nut — Ford, Merc., Meteor, Cont. ....	80-100
Nut — T-Bird, Mk IV, Torino, Montego .....	100-130
Lower Arm-to-Frame	
Bolt — Ford, Merc., Meteor, Cont. ....	90-120
Nut — Ford, Merc., Meteor, Cont. ....	70-90
Nut — T-Bird, Mk IV, Torino, Montego .....	100-130
Stabilizer Bar Mounting	
T-Bird, Mk IV, Torino, Montego Only .....	12-20
Rear Link Assembly-to-Bracket	
T-Bird, Mk IV, Torino, Montego Only .....	6-12