

1969-73 MIDLAND-ROSS POWER UNITS

Chrysler Corp. (1969 & 1971-73)

Ford Motor Co. (1970) ①

① — Single diaphragm application only.

DESCRIPTION

Unit may be identified by band clamp method of joining front and rear housing. Unit mounts on engine side of cowl panel and is externally connected to the brake system by linkage to brake pedal, vacuum line to intake manifold, and to master cylinder, bolted to front of unit. Power assist is supplied by a combination of manifold vacuum (introduced through a check valve) and atmospheric pressure. Master cylinder is same as standard type except for a special push rod, which is an integral part of the power unit.

from check valve. Unscrew nut attaching brace and support to unit. Detach linkage from pedal (under instrument panel). Remove nuts and washers attaching power unit to firewall. Remove unit from vehicle.

Installation — Install new dash panel-to-power unit gasket. Position unit on firewall, install nuts and washers and torque to 150 in. lbs. Using suitable lubricant, coat bearing surface of pedal linkage-to-pedal connecting bolt. Install bolt and nut and torque to 30 ft. lbs. Connect vacuum hose to power unit check valve. Attach brace, support, and master cylinder, torquing respective bolts and nuts to 150 in. lbs. With unit attached to firewall and vacuum supplied, the master cylinder should compensate (force fluid up through front chamber compensation port). Check stop light operation.

OVERHAUL

REMOVAL & INSTALLATION

Removal — Remove nuts attaching master cylinder to power unit. Position master cylinder aside. Disconnect vacuum hose

NOTE — Chrysler Corp. & Ford Motor Co. applications, as listed, do not recommend overhaul of this unit. Earlier year applications give overhaul procedures. See Power Brake Unit Index for appropriate article.

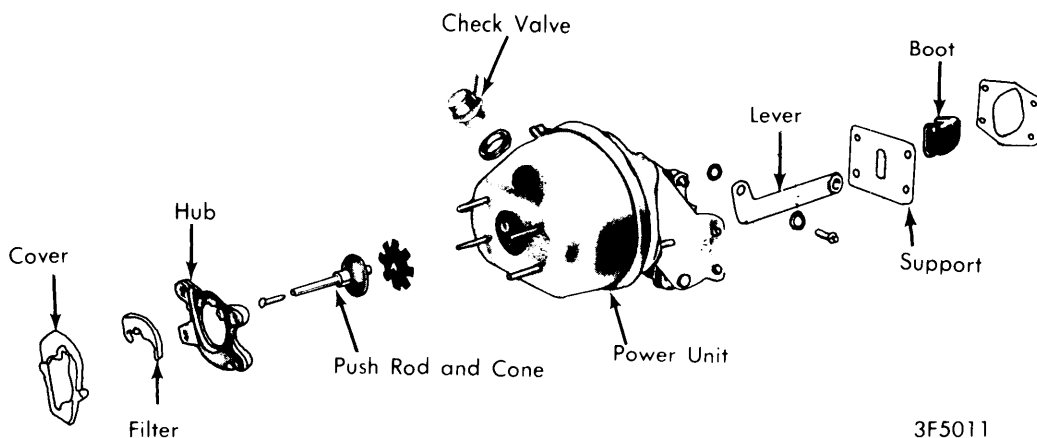

MIDLAND-ROSS SMALL SINGLE DIAPHRAGM

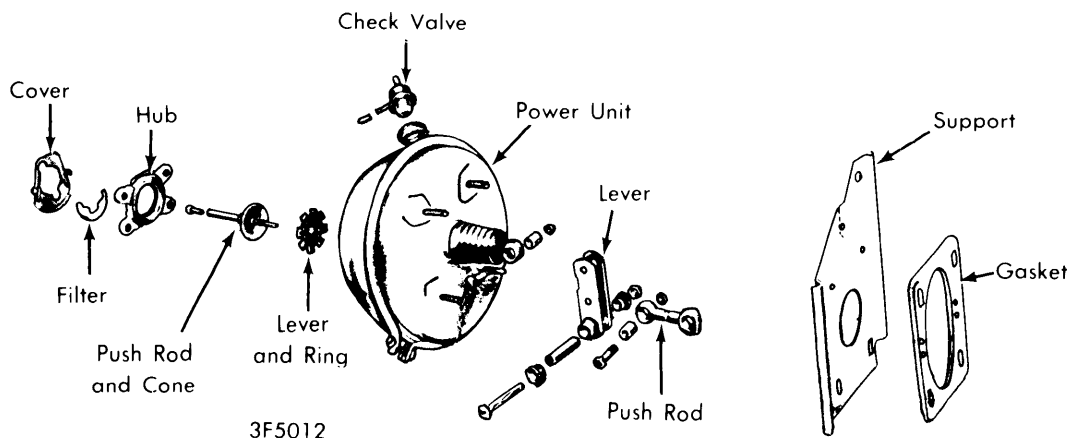

MIDLAND-ROSS LARGE SINGLE DIAPHRAGM