

JEEP SINGLE ANCHOR — CABLE ADJUSTER

“CJ” Models, Scrambler

DESCRIPTION

Automatic adjuster brakes are 2 shoe, self-centering type with brake shoe anchor at upper end of shoes above wheel cylinder. Single cylinder is double acting. Automatic adjuster device is cable operated.

ADJUSTMENT & SERVICING

BRAKE SHOE ADJUSTMENT

Brake shoes adjust automatically as brakes are applied when vehicle is operated in reverse. Brake shoes can be manually adjusted by rotating adjuster screw.

Remove access slot cover. Using a small blade screwdriver, push in on adjustment lever to separate from adjustment screw. Turn adjustment screw until brake drum is locked tight, then back screw off until wheel rotates freely. It may also be necessary to back shoes off a few notches to remove drum.

PARKING BRAKE ADJUSTMENT

Rear Wheel Integral

Adjustment is not necessary in normal service; automatic service brake adjustments also adjust parking brake. In case of brake overhaul or to compensate for

stretched cables, adjust as follows: Check first for binds, kinks or any frayed condition of cables.

Check that brake shoes are in proper adjustment before proceeding. Release parking brake. Loosen lock nuts at equalizer under vehicle. Tighten cables until wheels drag slightly when rotated by hand. Loosen cables until wheels rotate freely and no drag is felt. Tighten lock nut and check operation of parking brake.

BLEEDING SYSTEM

See *Hydraulic Brake Bleeding in this Section.*

REMOVAL & INSTALLATION

BRAKE SHOES

Removal

1) Raise and support vehicle and remove wheels and drums. Grasp adjusting lever with pliers and remove tang from hole in secondary shoe. Place clamping device over wheel cylinder to retain pistons during further disassembly.

2) Remove secondary return spring, adjuster cable, primary return spring, cable guide, adjuster lever and adjuster springs. Remove hold-down springs and brake shoes. Disengage parking brake cable from parking brake lever.

Installation

1) Lubricate support plate ledges, anchor pin, self-adjusting cable guide, adjuster screw threads, and

Fig. 1: Exploded View of Jeep Brake Assembly With Cable Operated Adjuster

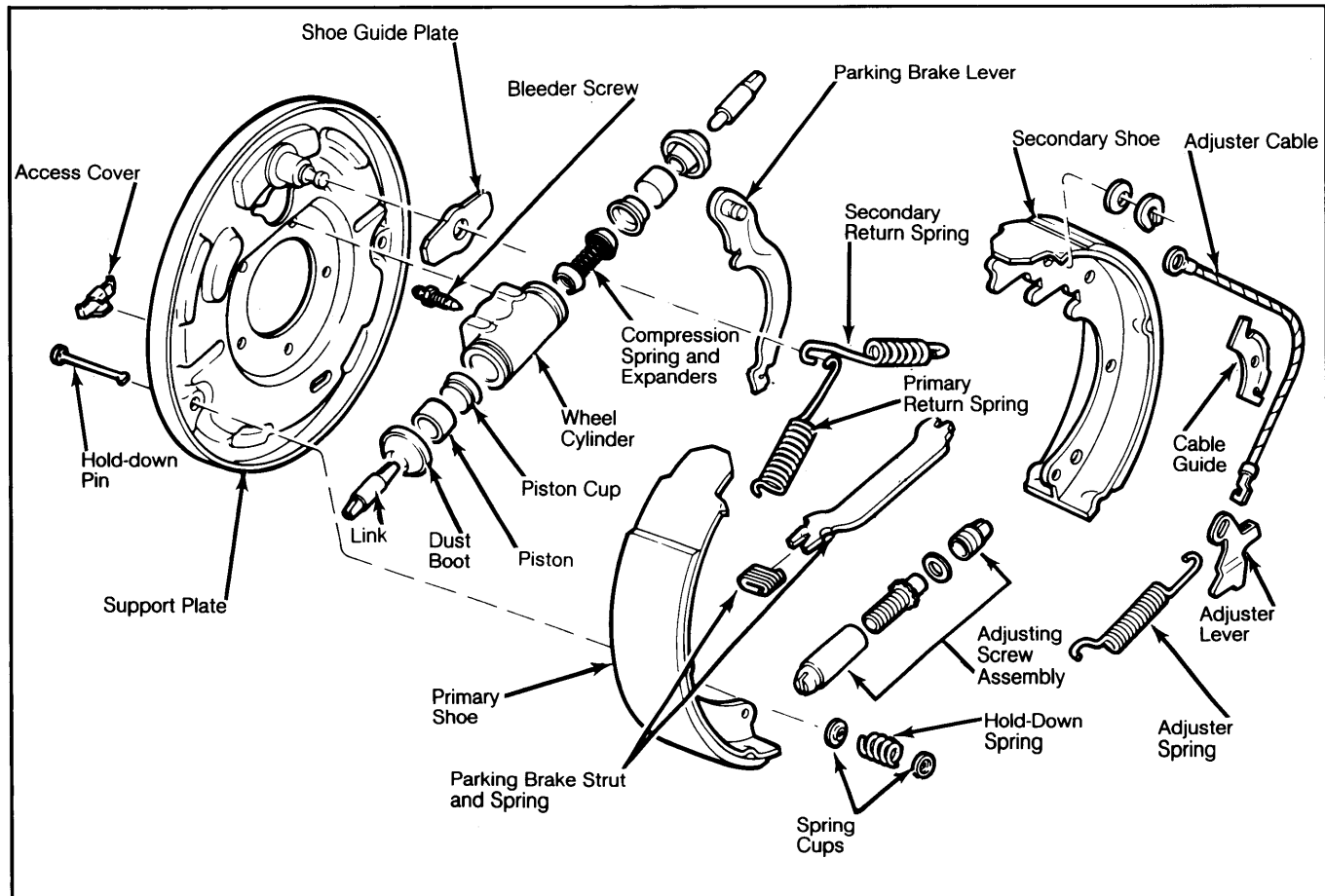

Brake Systems

JEEP SINGLE ANCHOR - CABLE ADJUSTER (Cont.)

pivot with molydisulphide grease or chassis lubricant. Lubricate parking brake cable lever and install on secondary brake. Install washer and replacement lever retaining "U" clip. Crimp ends of clip to retain it on pivot.

2) Position brake shoe on brake support plate and install hold-down springs. Install parking brake cable in lever, and install parking brake strut and positioning spring. Place adjuster cable eyelet on anchor pin and install primary return spring. Install cable guide to secondary brake shoe and install secondary return spring.

3) Install adjuster screw and spring on brake shoes and insert small hooked end of spring into large hole in primary brake shoe. Install large hooked end of spring in adjuster lever. Position adjuster cable in cable guide groove. Insert hooked end of cable in adjuster lever.

4) Grasp adjuster lever with pliers and hook adjuster lever tang in large hole in bottom of secondary shoe. Initially adjust brakes using clearance gauge (J-21177) or manual adjustment procedure outlined in this story. See *Brake Shoe Adjustment*.

5) Install brake drums and, if brake lines were disconnected, bleed system. Install wheels and lower vehicle. Apply and release brakes 10-15 times while driving forward and backward. This adjusts and balances brake system. Road test vehicle.

WHEEL CYLINDER

Removal

Remove wheels, brake drums, and brake shoes. Disconnect brake line at each wheel cylinder. DO NOT bend line away from cylinder. When cylinder is moved away from support plate, line will separate easily. Remove cylinder-to-support plate bolts and remove cylinder.

Installation

To install, reverse removal procedure noting the following: Start brake line fitting into cylinder before installing cylinder to support plate.

OVERHAUL

WHEEL CYLINDER

NOTE: Vehicle manufacturer recommends that cylinders NOT be honed.

Disassembly

1) Remove brake shoe links and dust boots. Push pistons, piston cups and expander spring out of bore. Discard piston cups. Clean all cylinder parts with clean brake fluid or brake solvent. Inspect cylinder bore and piston for pitting, wear or other damage and replace if necessary.

2) Light discoloration may be removed by polishing with crocus cloth only. Polish by rotating cylinder around crocus cloth supported on fingers. DO NOT polish in a lengthwise direction.

Reassembly

1) Lubricate cylinder bore and internal components with brake fluid. Do not lubricate dust boots. Position replacement piston cups on spring expanders and install assembled parts into cylinder bore.

2) Ensure expanders are seated in piston cups and that cups are installed with lips facing one another. Install pistons with flat sides facing interior of bore. Install dust boots and brake shoe links.

TIGHTENING SPECIFICATIONS

Application	INCH Lbs. (N.m)
Bleeder Screw 1/4"-28	40-50 (4.5-5.7)
Bleeder Screw 3/8"-24	40-140 (4.5-15.9)
Brake Line	120-200 (13.6-22.7)

Application	Ft. Lbs. (N.m)
Support Plate	30-35 (41-48)
Brake Cylinder-to-Support Plate	18 (24)

DRUM BRAKE SPECIFICATIONS

Application	Drum Diam. In. (mm)	Drum Width In. (mm)	Max. Drum Refinish Diam. In. (mm)	Brake Cyl. Diam. In. (mm)	Master Cyl. Diam. In. (mm)
"CJ" and Scrambler	10.00 (254.0)	1.75 (44.5)	10.06 (255.5)	.88 (22.2)	1.00 (25.4)
Cherokee, Wagoneer and J-10 Pickup	11.00 (279.4)	2.00 (50.8)	11.06 (280.9)	.94 (23.8)	1.13 (28.6)
J-20 Pickup	12.00 (304.8)	2.50 (63.5)	12.06 (306.3)	1.13 (28.6)	1.13 (28.6)