

BENDIX MASTER VAC

Dodge
All Models Exc. M400, 500 & 600
International Harvester
Plymouth

NOTE — For other units used, see Power Brake Index.

DESCRIPTION

Power brake unit is a dual diaphragm type, mounted on firewall (all models except Dodge M300) or frame rail (Dodge M300). Unit is actuated by brake pedal through a pedal link or a pivot arm (Dodge "B" models or Plymouth "PB" models). Vacuum is supplied by a line connected to intake manifold. Vacuum line is connected at unit through a check valve. Master cylinder push rod is integral with power brake unit. Rod is adjustable on all International Harvester models.

REMOVAL & INSTALLATION

DODGE "D" & "W" MODELS

Removal — Remove nuts securing master cylinder to power brake unit and pull master cylinder forward slightly. Disconnect vacuum hose at unit. From under instrument panel, remove nut and bolt securing unit push rod to brake pedal. Remove four nuts securing unit to firewall and remove power brake unit.

Installation — To install, reverse removal procedure.

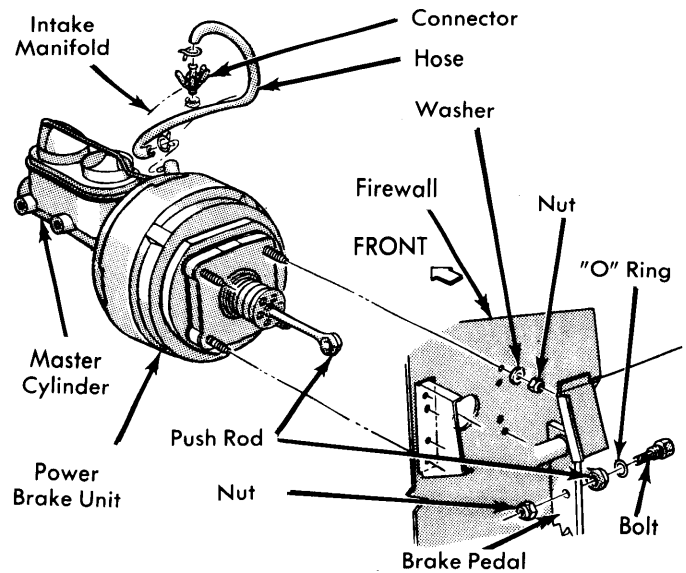

Fig. 1 Power Brake Unit Mounting
Dodge "D" and "W" Models

DODGE "B" & PLYMOUTH "PB" MODELS

Removal — Disconnect vacuum hose at check valve. Remove nuts securing master cylinder to power brake unit. Remove pivot arm bolt. Remove nuts from power brake unit mounting bracket and remove unit.

Installation — To install, reverse removal procedure.

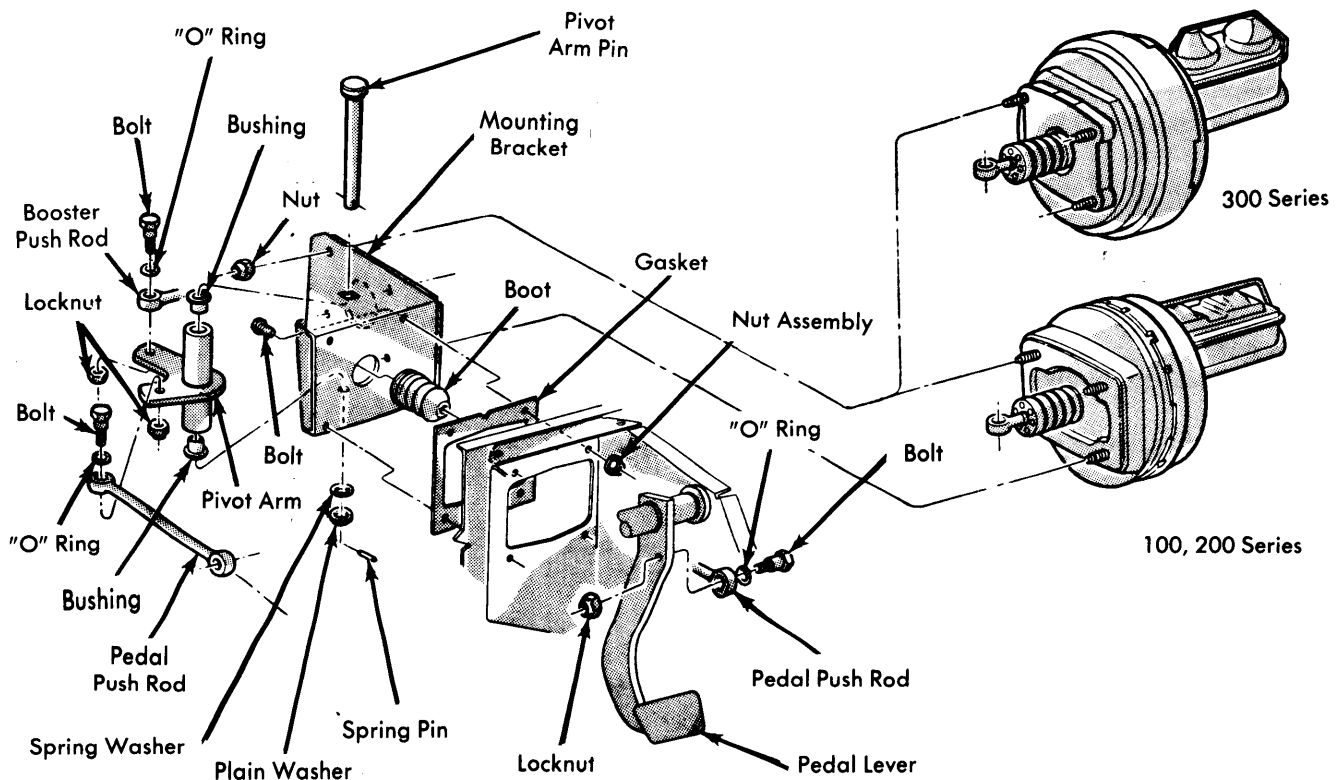

Fig. 2 Power Brake Unit Mounting
Dodge "B" Models and Plymouth "PB" Models

Power Brake Units

BENDIX MASTER VAC (Cont.)

DODGE MOTOR HOME CHASSIS

Removal — Disconnect brake lines at master cylinder. Remove master cylinder from power brake unit. Disconnect vacuum line from check valve and line to filter. Remove nut and bolt from unit push rod and lower brake pedal lever. Remove unit mounting nuts and separate unit from mount.

Installation — To install, reverse removal procedure. Bleed brake system. See *Hydraulic Brake Bleeding* in this Section.

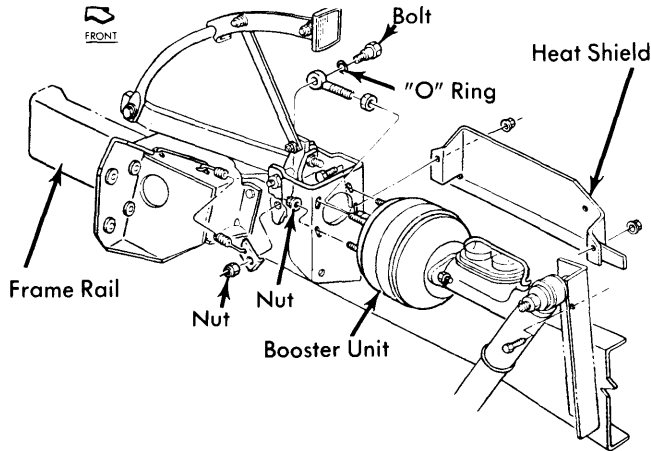

Fig. 3 Power Brake Unit Mounting Dodge Motor Home Chassis

INTERNATIONAL HARVESTER

Removal — 1) Disconnect vacuum line from check valve at front of power brake unit. Disconnect brake lines at master cylinder. Disconnect pedal link from brake pedal inside of vehicle.

2) Remove nuts securing power brake unit mounting bracket to firewall. Clean exterior of unit and master cylinder. Drain master cylinder reservoir. Remove master cylinder from unit. Remove mounting bracket and pedal linkage from unit.

Installation — To install, reverse removal procedure. Install new check valve and grommet. Check push rod height and adjust as necessary. See *Push Rod Adjustment*.

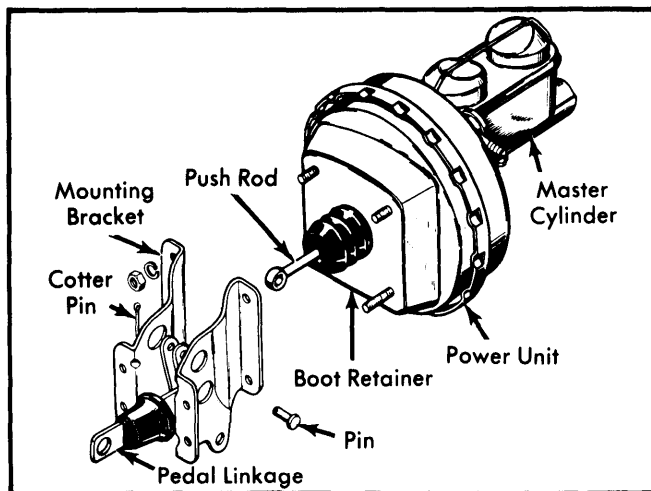

Fig. 4 Power Brake Unit Mounting Components International Harvester

OVERHAUL

NOTE — Chrysler Corp. does not recommend overhaul of this unit. Replace unit if defective.

ADJUSTMENT

PUSH ROD

Dodge & Plymouth — Push rod is preadjusted at factory.

International Harvester — 1) Construct a measuring gauge from No. 15 or No. 16 gauge steel using dimensions shown in illustration (see Fig. 5).

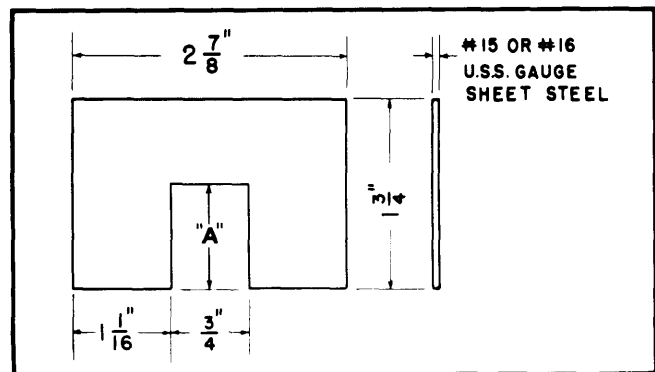

Fig. 5 International Harvester Measuring Gauge

2) Using gauge, check distance from unit mounting surface to end of push rod as shown in illustration (see Fig. 6). If push rod does not contact gauge, adjust screw in end of push rod until it contacts. To determine dimension "A", see following application chart.

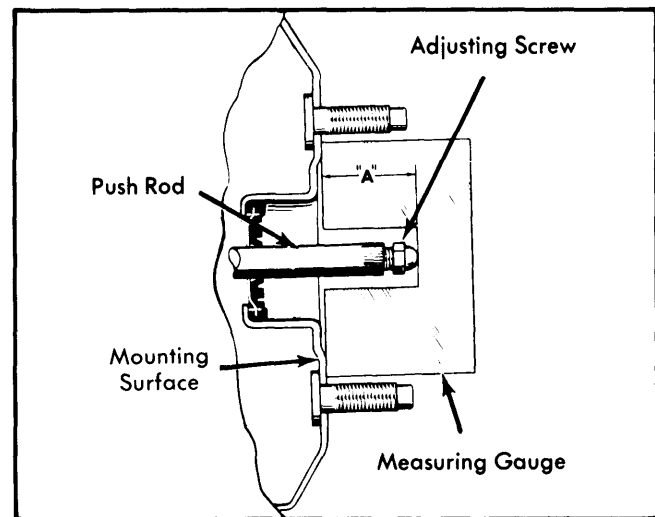

Fig. 6 Checking International Harvester Push Rod Height

PUSH ROD ADJUSTMENT CHART

Application	Dimension "A"
Drum Brakes.....	.980-.995"
Disc Brakes.....	1.185-1.200"