

JEEP

Cherokee
"CJ" Models
"J" Models
Wagoneer

DESCRIPTION

The Wagoneer, Cherokee, and "J" models use a collapsible column that is available with a tilt wheel option if vehicle is equipped with an automatic transmission. The "CJ" models use a non-collapsible column only. Both types of column have the anti-theft locking feature.

REMOVAL & INSTALLATION

"CJ" MODELS

Removal & Installation — Disconnect negative battery cable, then disconnect steering column wiring connector under instrument panel. Mark steering shaft and shaft coupling for reassembly reference, then remove coupling clamp bolt. Remove steering plate and clamp at floor pan, and remove rubber grommet attaching screws. Remove support bracket at instrument panel, and remove column from vehicle. To install, reverse removal procedure, aligning marks in shaft and coupling made at time of removal.

CHEROKEE, WAGONEER
& "J" MODELS

Removal — Disconnect negative battery cable, then disconnect steering column wiring harness under instrument panel. On vehicles without power steering, mark steering shaft and upper-to-lower shaft coupling for reassembly reference, then remove coupling clamp bolt. On vehicles with power steering, remove flexible coupling-to-flange clamp bolts. On vehicles with column mounted transmission controls, disconnect control rods at steering column. Remove seal and clamp between steering column and floor pan. Remove lower instrument panel trim plate, then remove upper column support bracket. Remove column assembly from vehicle.

Installation — Attach clamp bracket to steering column, and position steering column in vehicle. Loosely install upper column support bracket to instrument panel. On vehicles without power steering, align marks on steering shaft and steering shaft coupling, made during removal, and install coupling clamp bolt. On vehicles with power steering, connect steering shaft and flexible coupling. Install floor pan clamp and seal, then pull upward on steering column while tightening upper column support bolts. Connect steering column wiring harness under instrument panel, install instrument panel trim plate, and connect transmission control rods (if removed). Connect battery cable to battery.

OVERHAUL

"CJ" MODELS

Disassembly — Loosen clamp connecting universal joint coupling cover to lower shaft, and remove cover. Separate upper shaft, lower shaft, and center coupler. Remove steering wheel, then withdraw upper steering shaft from steering column jacket. Remove horn wire and contact ring from upper shaft. Remove horn contact brush from jacket, then remove upper shaft bearing assembly, and lower bushing assembly.

Reassembly — Install horn contact brush in column jacket, then install upper bearing assembly and lower bushing assembly. Install horn wire and contact ring on upper steering shaft, then insert shaft into jacket. Install steering wheel. Install center coupler on upper shaft, then install lower shaft to coupler. Install universal joint coupling cover on lower shaft, and install clamp.

ALL MODELS (EXC. "CJ")
WITHOUT TILT WHEEL

Disassembly — 1) Using suitable holding fixture (J-23074), mount steering column assembly in a vise. Remove steering wheel, and anti-theft device cover. Using suitable tool (J-23653), depress lock plate and remove steering shaft snap ring. Remove lock plate compressor tool, directional switch canceling cam, upper bearing preload spring, and thrust washer from steering shaft. Remove steering shaft through lower end of steering column.

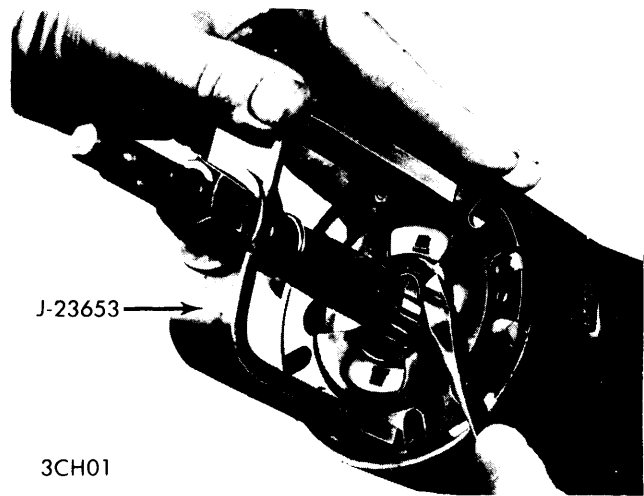

LOCK PLATE SNAP RING REMOVAL

2) Place directional switch control lever in right turn position, and remove lever from actuator. Remove hazard warning light switch button. On vehicles with column mounted transmission controls, remove shift lever pivot pin, and remove lever from housing. Disconnect directional switch harness from column harness, and remove harness protector from column jacket. Carefully remove harness from column.

3) With key ignition switch in "ON" position, remove key warning buzzer contacts. Place switch in "LOCK" position, depress lock cylinder retaining tab, and remove lock cylinder. Remove ignition switch from lower column. Remove upper housing, lock bolt, and rack.

4) Remove nylon bearing from upper end of jacket. Remove directional switch shroud. Carefully remove inhibitor lever and spring from shroud. Remove lock rod, rack, lock bolt, and spring.

5) On vehicles with column mounted transmission controls, remove lower bearing retainer, lower bearing, preload spring, nylon washer, neutral safety switch, shift levers, lever spacer, shift tube bearing retainer, and shift tube. On vehicles with floor mounted transmission controls, remove lower bearing retaining ring, and lower bearing.

JEEP (Cont.)

Reassembly - 1) Install lower bearing, bearing retainer, and lock ring. On vehicles equipped with column mounted transmission controls, install shift tube, nylon bearing, preload spring, lower bearing, bearing retainer, lock ring, and neutral safety switch.

NOTE - Apply thin coat of lubricant to all friction-bearing surfaces prior to any further assembly.

2) On vehicles with floor mounted transmission controls, install rack preload spring into housing from lower end. Install lock bolt, rack, and remote rod into housing. Position inhibitor spring over lever pivot on housing, and install lever. Install shroud onto housing.

3) On vehicles with column mounted transmission controls, install upper nylon bearing in column jacket. Install shift bowl on shift tube splines, and install rack preload spring into upper housing. Install shift lock gate, then install quadrant light and cover. Install quadrant indicator, and install lock bolt and rack assembly. Install nylon thrust cup into upper housing.

4) Install upper housing on column. Install key warning buzzer switch, and directional signal switch into housing. Install wiring harness into column and install wiring protector. Install turn signal lever and steering shaft. Position thrust washer, spring, and directional switch canceling cam on steering shaft.

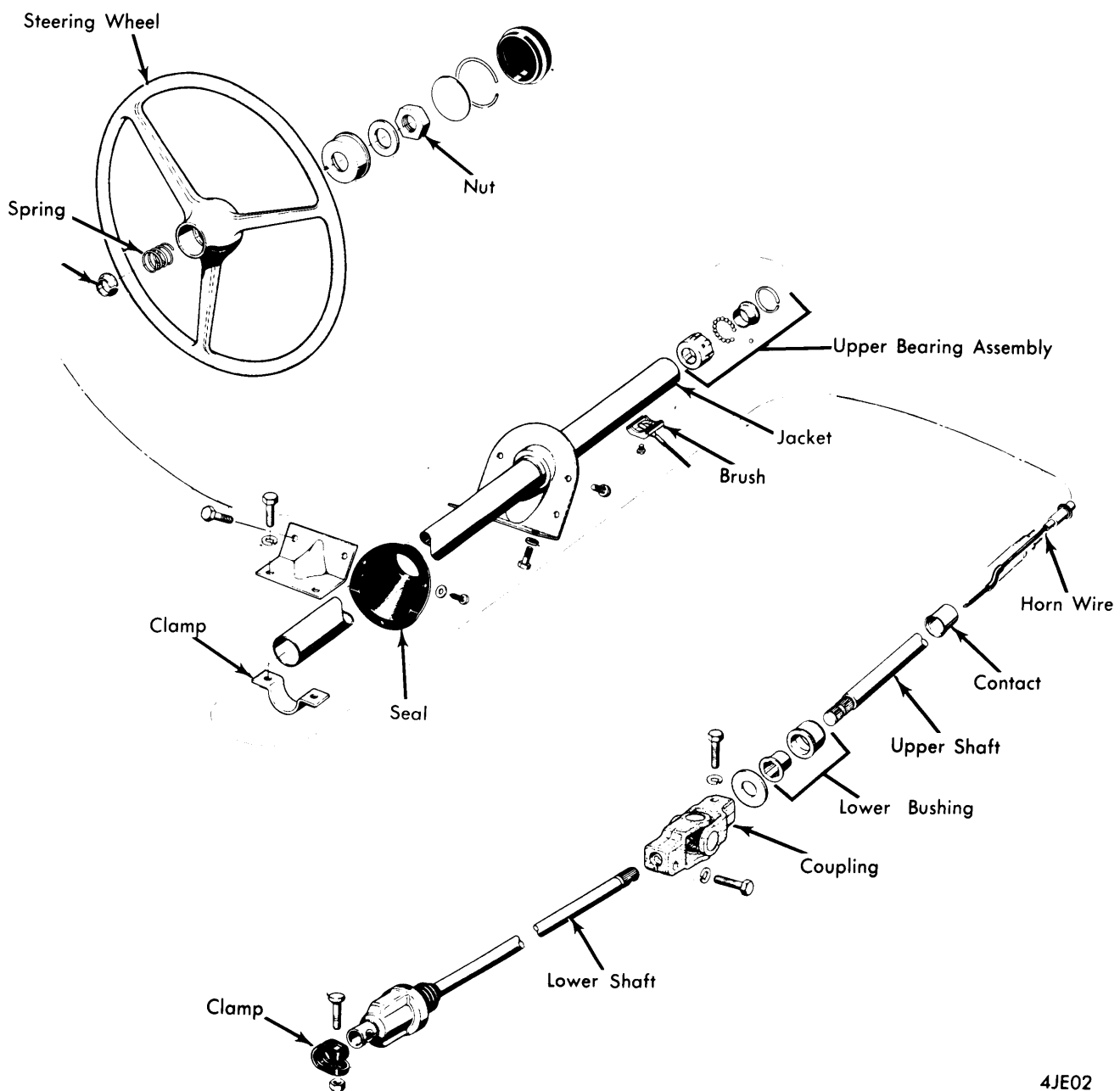

"CJ" STEERING COLUMN ASSEMBLY

4JE02

Steering Columns

JEEP (Cont.)

5) Align lock plate splines with steering shaft splines, and install lock plate. Install steering shaft lock ring. Install anti-theft device cover, then install steering wheel.

6) Install hazard warning light switch button. On vehicles equipped with column mounted transmission controls, install column shift lever. Install key lock cylinder, and ignition switch.

ALL MODELS (EXC. "CJ") WITH TILT WHEEL

Disassembly - 1) Remove steering wheel, and remove gear shift lever retaining pin and shift lever (if equipped with column mounted transmission controls). Remove anti-theft device cover, and install suitable lock plate compressor tool (J-23653). Using suitable holding fixture (J-23074), clamp steering column in a vise. Depress lock plate, remove steering column lock ring, and remove compressor tool.

2) Remove lock plate, directional signal switch canceling cam, upper bearing preload spring, bearing race seat, and bearing race. Place directional signal switch in right turn position, and remove lever. Depress hazard warning light switch, and remove switch button. Remove steering column wiring harness, and remove directional signal switch. Turn key ignition switch to "ON" position, remove key warning buzzer contacts. Turn switch to "LOCK" position, and remove lock cylinder from column.

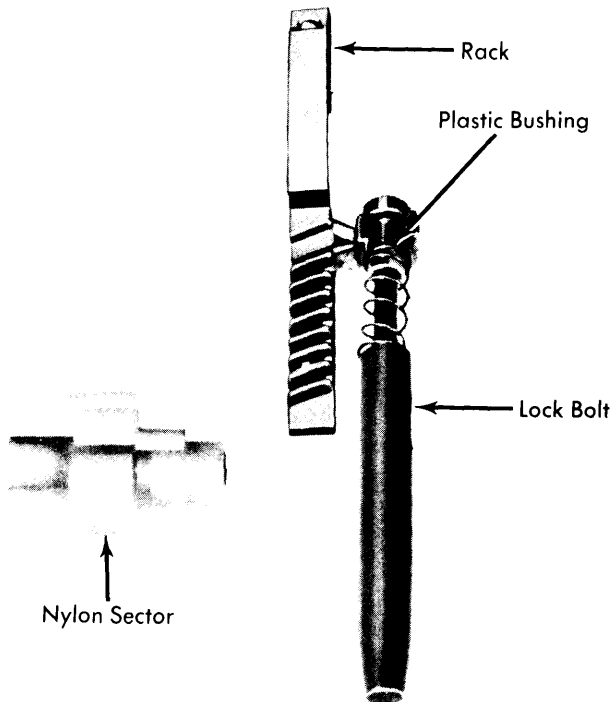

5JE08

LOCK BOLT, RACK & SECTOR

3) On vehicles equipped with automatic transmission, remove shift quadrant, quadrant mounting bracket, and light socket. Remove upper cover from column, then remove sector tension spring. Remove lock sector and shaft. Install wheel tilt lever, and position upper steering shaft in full UP position. Remove tilt spring retainer, and tilt spring. Position upper shaft in center position, and remove two pivot pins. Lift release handle to disengage lock shoes, and remove housing assembly. Remove tilt release lever.

4) Remove steering shaft from top of column, and fold centering joint over 90° to disassemble. Remove ignition switch, neutral safety switch, lock rack and rod, lower bearing retainer, and lower bearing. On vehicles with column mounted transmission controls, remove shift gate pin, shift gate, shift tube thrust washer, and shift tube. Remove bowl retainer plate, wave washer, tube spring, and shift bowl from column.

NOTE - Lubricate all friction-bearing surfaces with a thin coat of lithium base grease prior to assembly.

Reassembly - 1) Place shift bowl (if equipped) onto steering column, and install bowl retaining parts. Install shift tube through lower end of jacket assembly, ensuring splines of tube are aligned with splines of bowl. Install suitable shift tube installer (J-23073-2 and J-23073-4) into shift tube, and tighten spring tension nut to obtain snug fit. Position receiver tool (J-23073-3 and J-23073-4) into shift bowl, and pull tube fully into bowl. Install shift tube thrust washer and retainer ring.

2) Install lower shaft bearing, bearing retainer, and retainer ring. Install pin and shift gate on upper support, and install upper support on column. Assemble upper and lower steering shaft with centering sphere, and install shaft assembly in column from top. Install ball bearings in upper housing, and install wheel tilt lever. Install ignition switch remote rod, and place lock rack on rod. Carefully install upper housing over steering shaft and rack, making sure lock shoes engage in upper support.

3) Align upper housing and upper support pivot pin holes, and install pins. Install lock shoes, lock shoe pins, and shoe springs in upper housing. Install lock sector and sector shaft. Install lock sector tension spring, then install tension spring retaining screw. Position upper housing in full UP position, and install tilt spring and seat. Install upper housing cover.

4) Install key warning buzzer switch, quadrant light, and tilt release lever. Install shift quadrant. Install directional switch assembly, and column wiring harness. Install directional switch control handle. Install upper bearing race, bearing seat, preload spring, and directional switch canceling cam onto steering shaft. Align lock plate splines, and install lock plate. Compress lock plate, and install steering shaft retaining ring. Install anti-theft device cover, then install gear shift lever (if equipped). Install key lock cylinder.

Steering Columns

JEEP (Cont.)

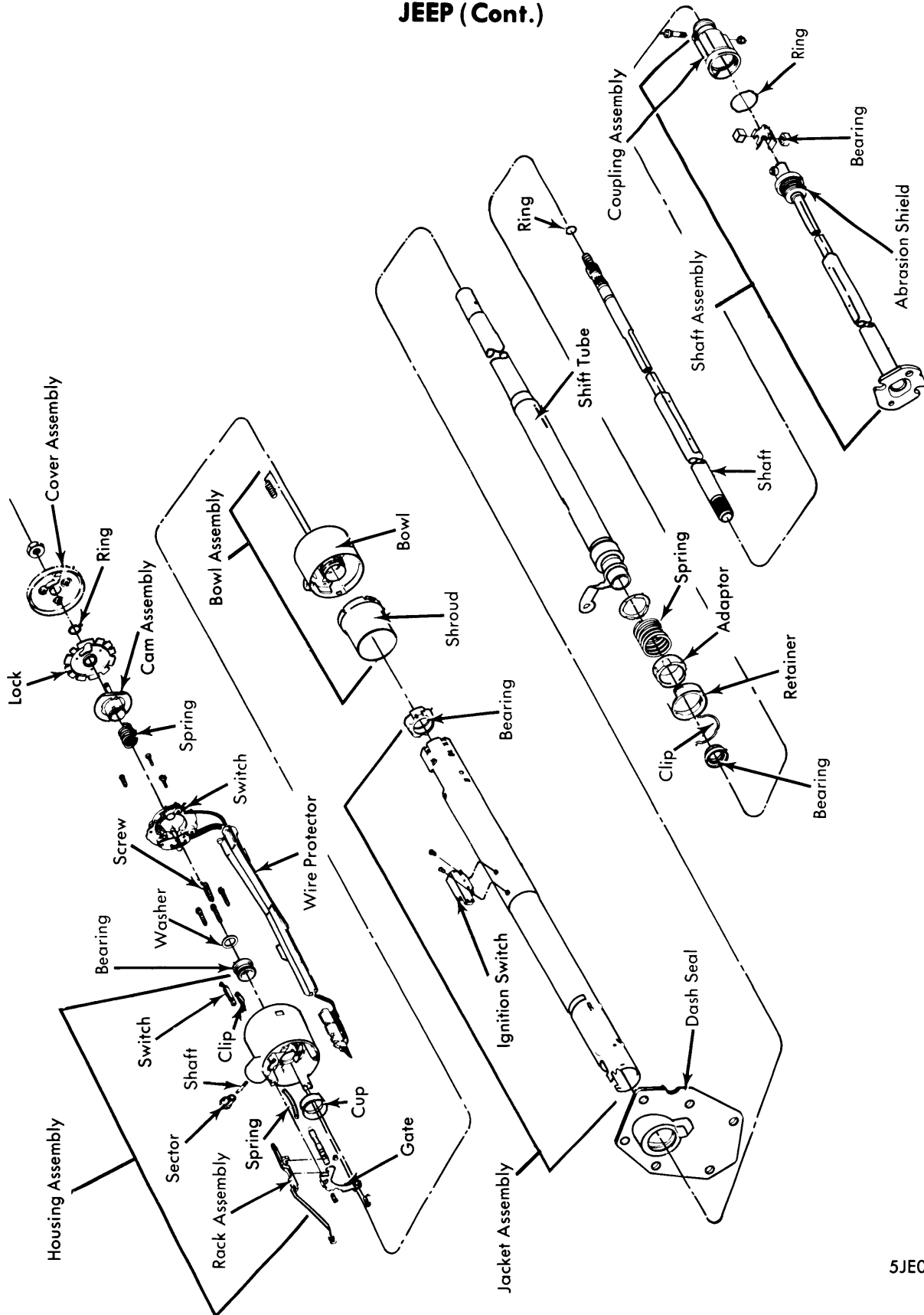

5JE07

**NON-TILT WHEEL STEERING COLUMN ASSEMBLY
CHEROKEE, "J" MODELS & WAGONEER (AUTO. TRANS. SHOWN)**

Steering Columns

JEEP (Cont.)

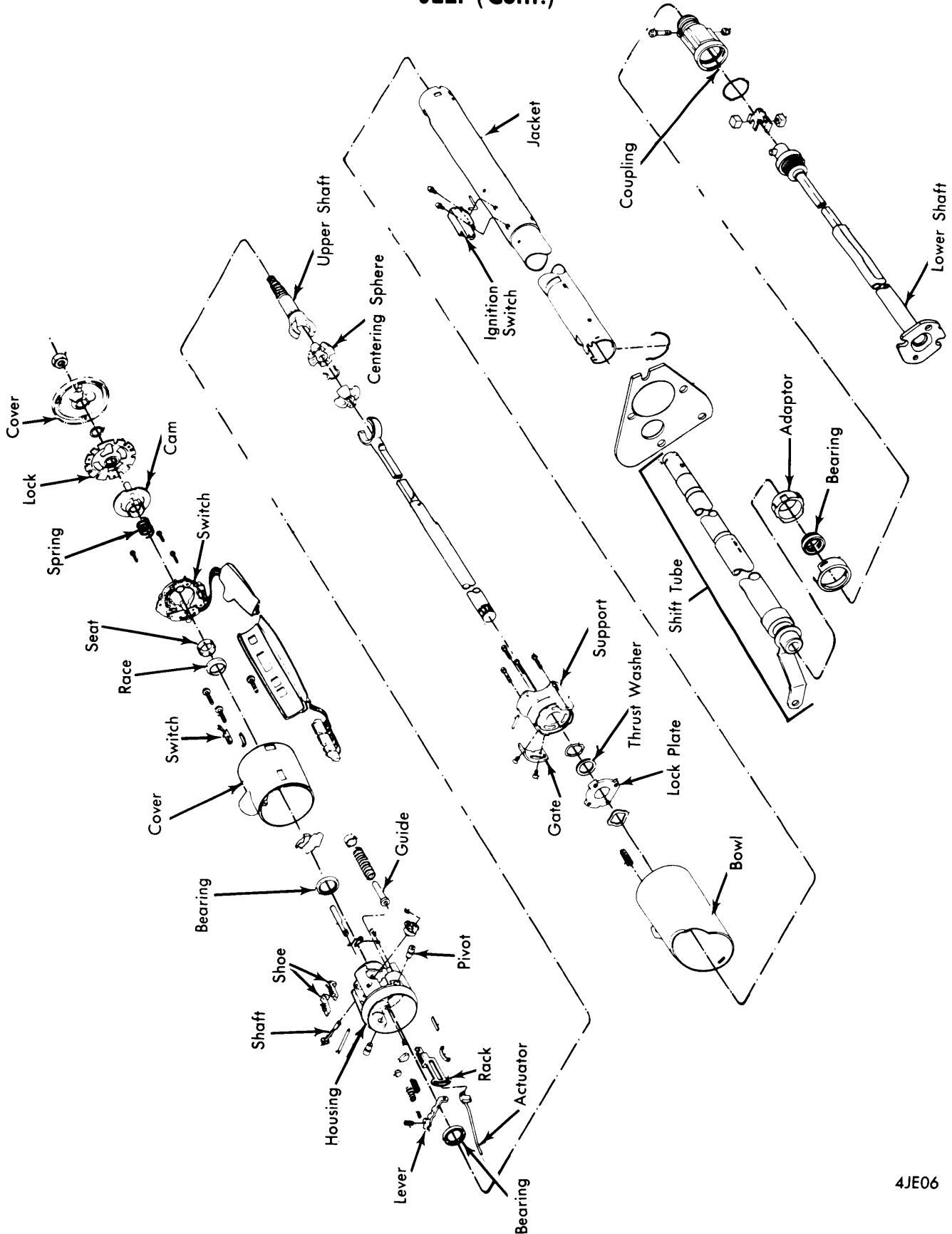

TILT WHEEL STEERING COLUMN ASSEMBLY

4JE06