

Front Suspension

CHRYSLER CORP. LEAF SPRING TYPE

Dodge — Motor Home Chassis

REMOVAL & INSTALLATION

DESCRIPTION

Front axles used on Dodge Motor Home chassis are the Elliot type. Axles are mounted to frame by semi-elliptical leaf springs. Steering knuckles are connected to axle by solid, constant diameter kingpins. Both bronze and nylon type bushings are used to provide bearing surfaces for kingpins. Bushings are press fit into axle. Hydraulic shock absorbers are double-action type, mounted between frame and axle assembly.

4DO01

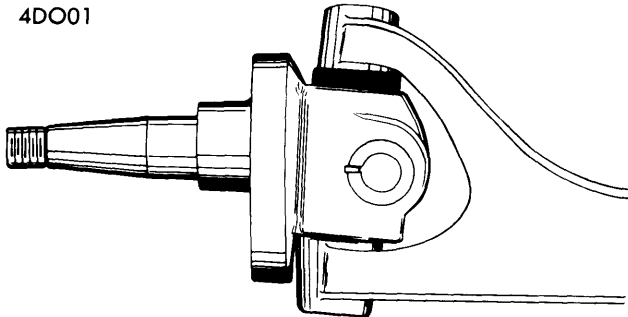

ELLIOT TYPE AXLE END

ADJUSTMENT

WHEEL ALIGNMENT SPECIFICATIONS & PROCEDURES

See *Wheel Alignment Specifications & Procedures* in *WHEEL ALIGNMENT* Section.

WHEEL BEARING ADJUSTMENT

See *Wheel Bearing Adjustment* in *WHEEL ALIGNMENT* Section.

STEERING KNUCKLE

Removal — Raise vehicle and support under frame. Remove wheel and tire. If equipped with drum type brakes, remove brake drum, then remove brake assembly from steering knuckle. Support brake assembly to prevent damage to brake hose. If equipped with disc brakes. Remove caliper and insert a block of wood between brake pads to prevent hydraulic fluid leak. Support caliper to prevent damage to brake hose. Remove rotor taking care not to damage seal. Remove caliper adapter from steering knuckle. On all models, remove kingpin lock pin and upper kingpin seal plug. Drive kingpin down and out of axle, forcing out lower seal plug. Remove steering knuckle and thrust washer from axle.

Installation — To install, reverse removal procedure. Make sure flat portions of kingpins are aligned with lock holes. Install new grease seal plugs, and stake into axle at four points around seal plugs.

KINGPIN BUSHINGS

Removal — *NOTE* — Nylon type bushings are not serviced, if bushings are found defective, replace with bronze type bushings. Nylon type bushings are easily removed by hand. To remove bronze bushings, use a suitable bushing removal and installation tool (C-328A). Remove upper bushing through top and lower bushing through bottom.

Installation — Install bushings using same tool as used for removal. Make sure grease holes in bushings are aligned with grease holes in axle. Ream bushings to obtain .002" clearance with kingpin. Inspect kingpin, if pitted or worn, it must be replaced. Fill grease grooves in bushings with chassis lubricant and install steering knuckle as previously outlined.

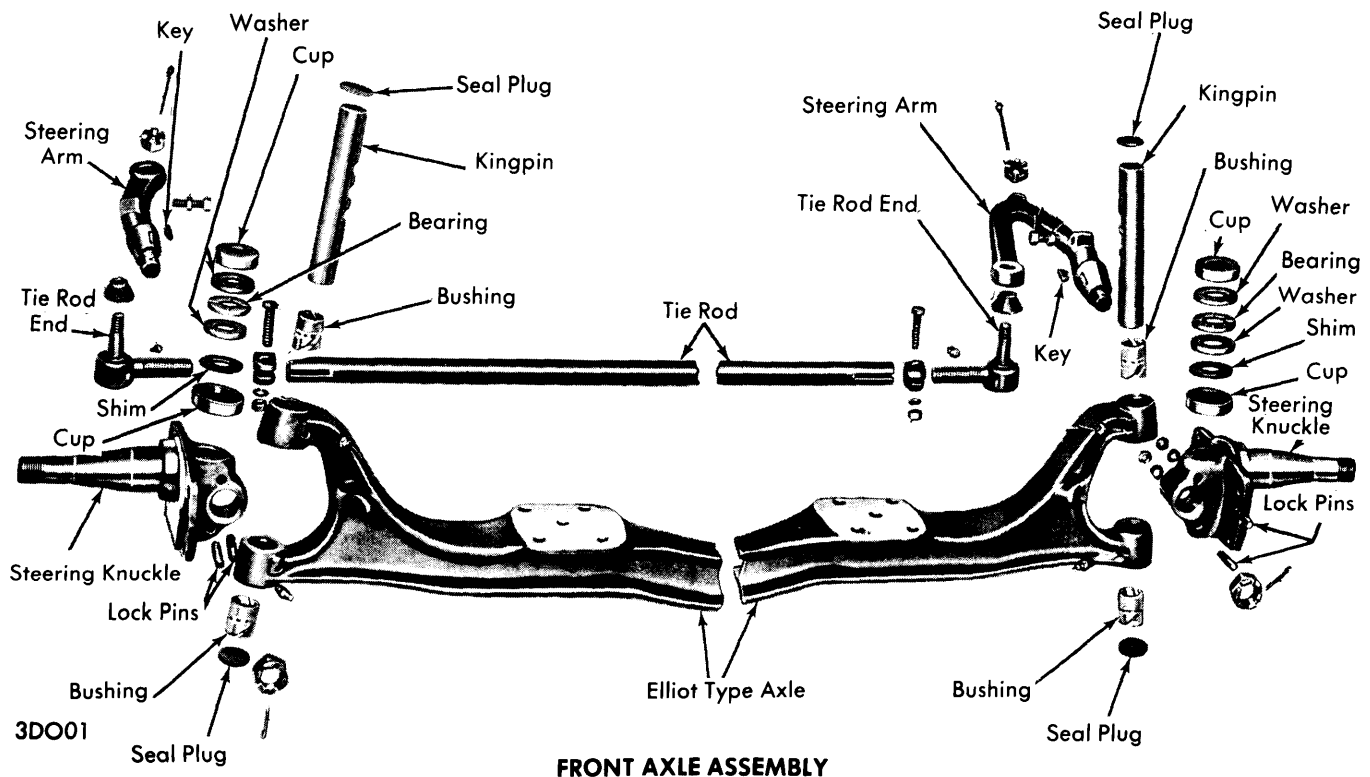

FRONT AXLE ASSEMBLY