

Steering Linkage

11-63

FORD MOTOR CO.

1965-74 All 4X4 MODELS

Center Link Service — 1) Raise vehicle on hoist and disconnect drag link from center link. Disconnect right then left center link ends from steering knuckle arms. Remove center link from vehicle and place in vise. Loosen center link end clamps and remove link ends from tube. Clean and oil all threads on components that are to be reinstalled.

2) Install link ends into center link, but do not tighten clamps. Install dust seals on link ends and install center link in vehicle. Install center link end attaching nuts and tighten to specifications, then continue tightening until slots are aligned with hole in stud. Install cotter pins.

3) Install seals on drag link ball stud, and install drag link end onto center link. Tighten nut to specification and continue tightening until slots are aligned with hole in stud. Install cotter pin. Adjust tire pressures and lower vehicle. Check and adjust toe-in and tighten center link end clamps.

NOTE — If drag link, center link, or pitman arm should become bent, no attempt should be made to straighten them; replace them instead.

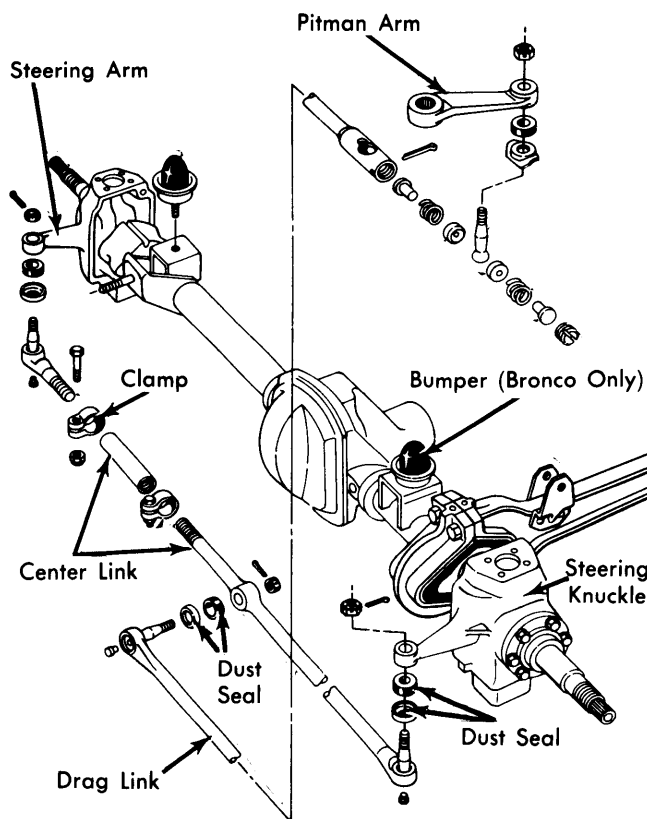

7FO01

STEERING LINKAGE 4X4 MODELS

1965-68 ECONOLINE

Pitman Arm Service — 1) Raise front of vehicle and position safety stands under front axle. Disconnect clutch pedal return spring. Remove clutch pedal-to-pivot attaching bolt and washer, and pull pedal from pivot shaft so that pedal will not obstruct removal of pitman arm.

2) Remove cotter pin and nut and disconnect drag link from pitman arm using suitable tool (3290-C). Remove bolt and nut that clamps pitman arm to sector shaft of steering gear. Spread pitman arm with a thin chisel and remove arm from shaft. To install, reverse removal procedure.

Drag Link Service — Raise front of vehicle and install safety stands under axle. Remove cotter pin and nut, and disconnect rear end of drag link from spindle steering arm using suitable tool (3290-C). Remove cotter pin and nut, and disconnect front end of drag link from pitman arm using suitable tool (3290-C). To install, reverse removal procedure.

Spindle Steering Arm Service — Raise vehicle and install safety stands. Remove cotter pin and nut, and disconnect center link from arm using suitable tool (3290-C). On left arm also disconnect drag link using same tool. Remove cotter pin and retaining nut and drive arm from spindle using a soft-faced hammer. To install, reverse removal procedure.

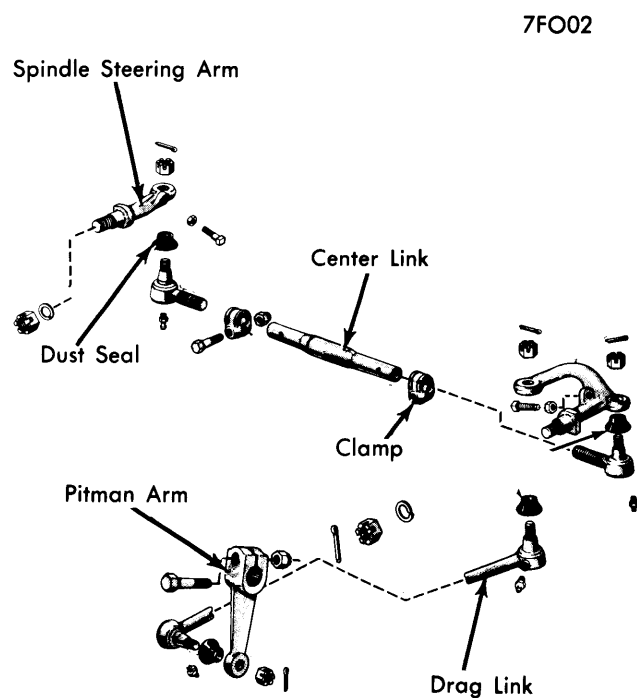

7FO02

STEERING LINKAGE ECONOLINE

Steering Linkage

FORD MOTOR CO. (Cont.)

1969-74 ECONOLINE

Pitman Arm Stops Adjustment (Pwr. Str. Only) - Loosen lock nut on both pitman arm stops and turn adjusting screws inward several turns. Turn steering wheel to right until right spindle steering arm contacts its stop. Adjust pitman arm stop outward until it contacts pitman arm. Tighten lock nut. Repeat procedure on left hand wheel and left pitman arm stop.

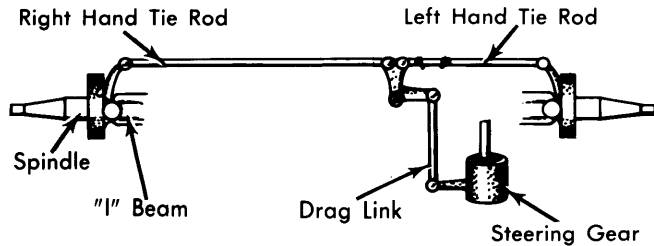

4FOA03

STEERING LINKAGE ECONOLINE (1969-74)

ALL MODELS W/STRAIGHT "I" BEAM AXLE

Center Link End Replacement - 1) Remove cotter pin and nut from link end ball stud. Remove ball stud from spindle arm. Loosen clamp and turn link end out of link. Lubricate threads of new link end and screw into link about same distance as old unit to approximate original toe-in setting.

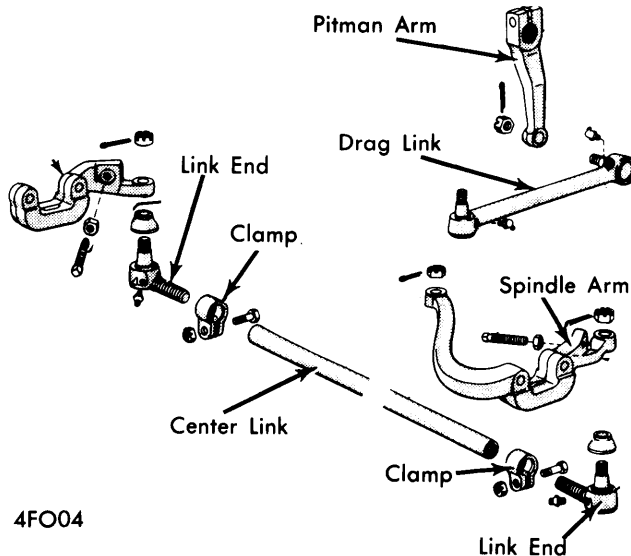

4FO04

STEERING LINKAGE W/STRAIGHT "I" BEAM AXLE

2) Install ball stud in spindle arm, tighten nut to specifications, and install cotter pin. Check toe-in and adjust as required. Check that link end clamps are $\frac{3}{16}$ " from end of link with clamp bolt at right angles to slot in end of link. Check that clamp does not interfere with steering movement from full-left to full-right positions.

ALL MODELS W/TWIN "I" BEAMS (EXC. ECONOLINE)

Tie Rod Service - Right tie rod is connected between right spindle and pitman arm of steering gear. Left tie rod is connected between left spindle and center of right tie rod. Should a tie rod, pitman arm, or steering spindle arm become bent or damaged, it should be replaced, not straightened or repaired.

4FOA05

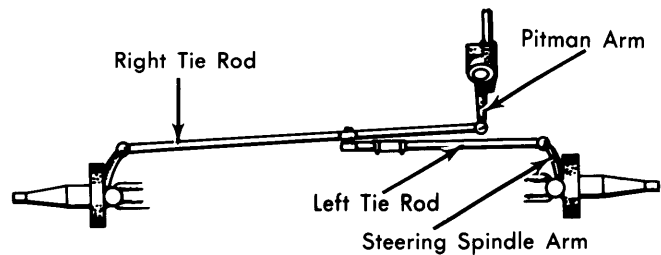

STEERING LINKAGE W/TWIN "I" BEAMS (EXC. ECONOLINE)

TIGHTENING SPECIFICATIONS

Application	Ft. Lbs.
Steering Gear To Frame	
All (Exc. F-350, "P" Models, F-250 4X4)	60-80
F-350, "P" Models, F-250 4X4	50-65
Pitman Arm To Steering Gear	
Bronco & F-100 4X4	105-135
F-100 to F-350	170-230
F-250 4X4 & "P" Models	130-170
Econoline	230-280
Drag Link Studs	
E-100 & E-200	45-55
All Others	60-75
Spindle Connecting Rod Studs	
F-100 to F-350	60-75
"P" Models, E-300	60-75
E-100 & E-200	45-55
Rod Clamps	
All (Exc. E-300 & F-350)	35-45
E-300 & F-350	40-60
Idler Arm to Support Bracket	105-145
Steering Damper To Bracket	15-25
Steering Damper To Frame	10-15