

# Front Suspension

## 1965-73 JEEP LEAF SPRING TYPE

Jeep (1965-73)

**NOTE** — Some models use other units. See Jeep Torsion Bar Type in this Section.

### DESCRIPTION

Front axle on 2-Wheel drive vehicle is reverse Elliot type, mounted to frame by semi-elliptical leaf springs. Steering knuckles are mounted to axle by solid, constant diameter kingpins. Bronze kingpin bushings are pressed into knuckles to provide bearing surface for kingpins. Hydraulic shock absorbers are double-action type, mounted between frame side rail and axle assembly.

### ADJUSTMENT

#### WHEEL ALIGNMENT SPECIFICATIONS & PROCEDURES

See Wheel Alignment Specifications & Procedures in WHEEL ALIGNMENT Section.

#### WHEEL BEARING ADJUSTMENT

See Wheel Bearing Adjustment in WHEEL ALIGNMENT Section.

#### STEERING STOP SCREW

See Steering Stop Screw in STEERING Section.

### REMOVAL & INSTALLATION

#### STEERING KNUCKLE

**Removal** — Raise and support vehicle under frame, and remove wheel. Remove grease cap from hub, and remove hub and drum assembly from vehicle. Remove brake backing plate from steering knuckle, and support to prevent damage to brake hose. Pry out plug at bottom of steering knuckle, and remove lock ring at top of kingpin. Drive tapered pin out of axle, and remove tie rod end from steering arm. Drive kingpin out of axle and remove steering knuckle from vehicle.

**Installation** — To install, reverse removal procedure, being sure that slot in kingpin is aligned with tapered pin hole in axle tube.

#### KINGPIN REPLACEMENT

**Removal** — With steering knuckle removed from vehicle, press bushings out of bores in knuckle. Clean all parts in solvent and blow dry with compressed air.

**Installation** — Press new bushings into bores in steering knuckle, being sure that grease holes in bushings and grease holes in knuckle are properly aligned. Ream new bushings to obtain correct slip fit between bushing and kingpin. Install steering knuckle to axle, using new kingpin. Place a suitable jack under steering knuckle and raise knuckle until clearance between knuckle and bottom of axle is eliminated. Measure clearance between top of axle and steering knuckle. Add or subtract shims as necessary to obtain clearance of less than .015".

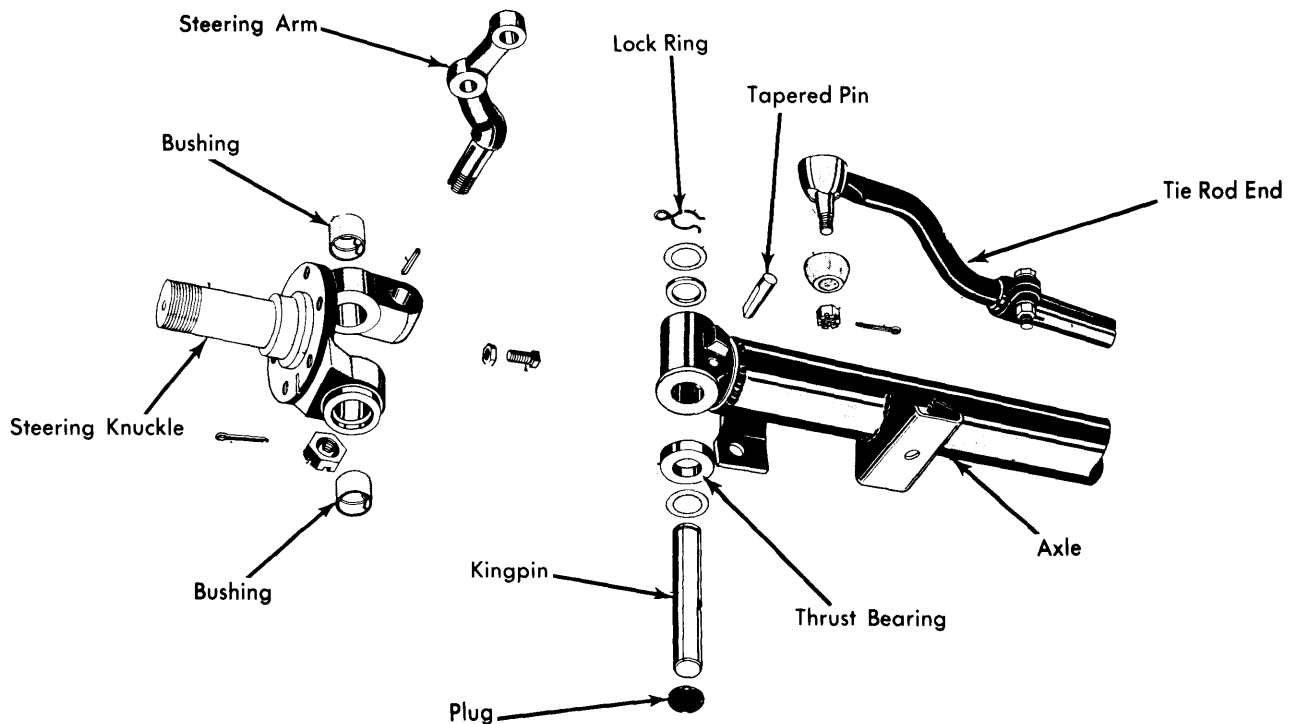

4JE01

### TWO-WHEEL DRIVE FRONT AXLE ASSEMBLY