

HONDA RACK & PINION

DESCRIPTION

Rack and pinion type steering is mounted by rubber insulators to crossmember. Adjustment is provided for pinion gear preload.

Pinion shaft is coupled to the steering shaft and tie rods connect end of rack to steering arms of front wheels.

ADJUSTMENT

NOTE: Rack piston must be adjusted whenever steering gear assembly is removed and installed.

STEERING WHEEL TURNING FORCE

1) Raise and support front of vehicle, so front wheels are off ground. Attach spring gauge to steering wheel spoke, near wheel rim.

2) Turn wheel with spring gauge and note reading. If reading is more than 3.3 lbs. (1.5 kg), adjust rack piston adjusting screw until turning force is to specifications.

Fig. 1: Steering Gearbox Adjustment

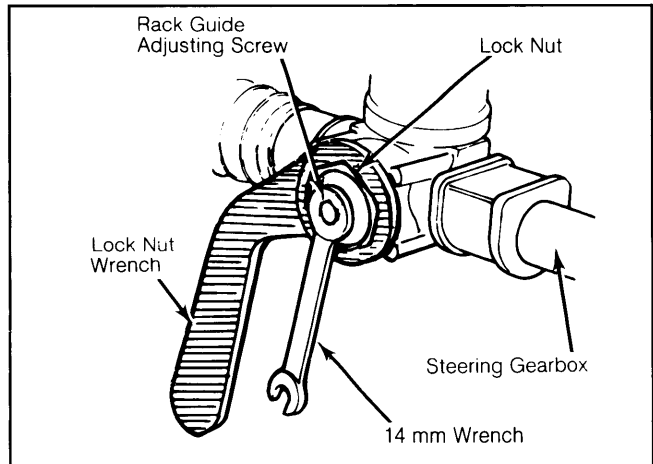

RACK PISTON ADJUSTMENT

Loosen rack screw lock nut. Tighten rack screw until lightly bottomed then back off screw 45° from

Fig. 2: Exploded View of Honda Rack & Pinion Steering Gear Assembly

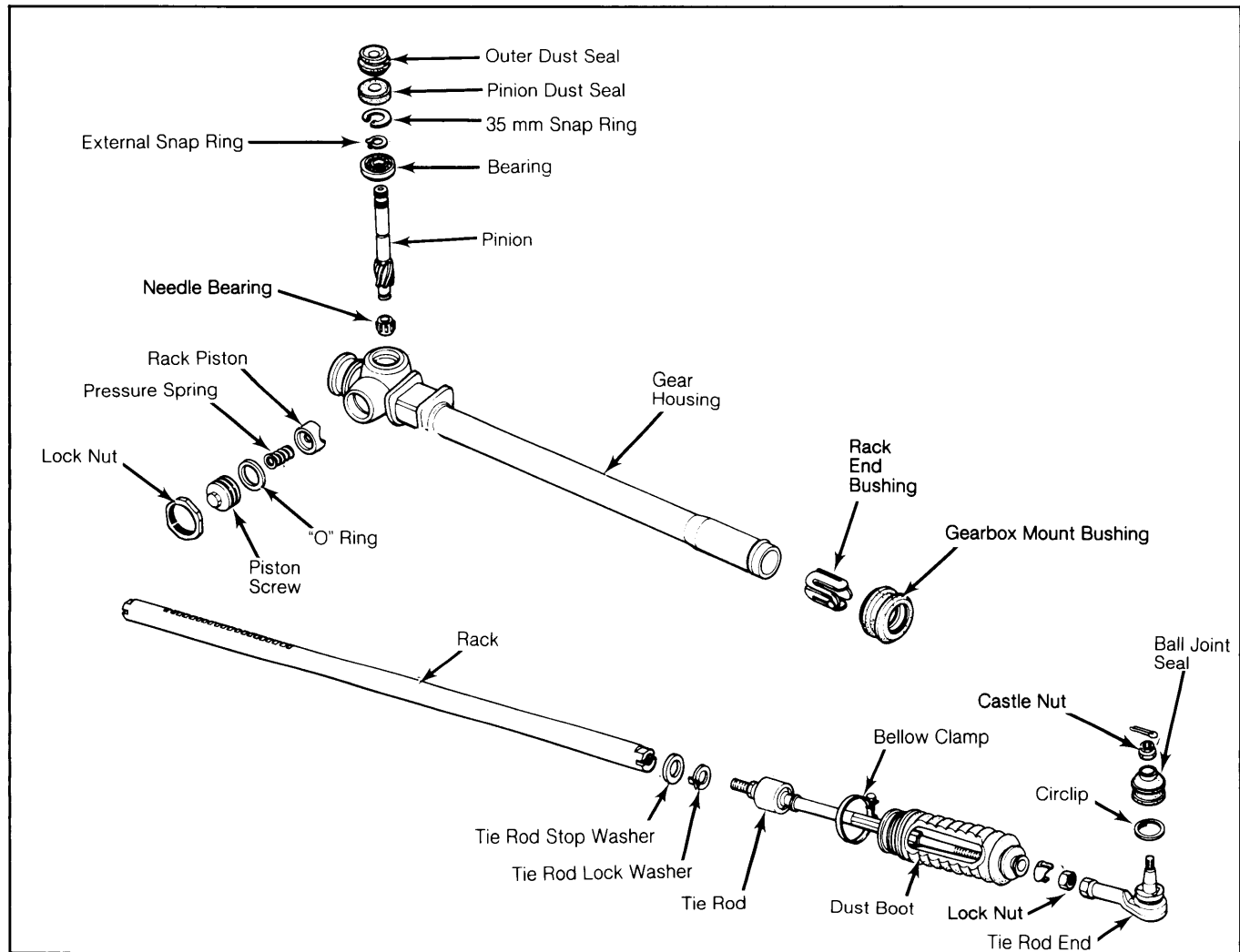

Steering Gears & Linkage

HONDA RACK & PINION (Cont.)

bottomed position. Tighten lock nut and recheck steering wheel turning force.

REMOVAL & INSTALLATION

STEERING GEAR

Removal (Accord)

1) Raise and support front of vehicle. Remove front wheels. Remove the bottom bolt in the steering shaft connector. Pull connector off pinion shaft. Remove cotter pins and ball joint nuts and remove tie rod ends out of steering knuckles.

2) Place manual transmission in 1st or 3rd and remove shift rod yoke bolt. Remove engine crossmember. Disconnect shift lever torque arm at transmission. On automatic transmission models, remove center engine mount and splash guard, then disconnect shift cable.

3) Remove the nuts connecting the exhaust pipe to the manifold. Push the rack all the way to the right (simulate a left turn). Remove gearbox brackets. Lower the gearbox so the end of the pinion shaft comes out of its hole in the frame.

4) Rotate the gearbox 180° forward until the pinion shaft is pointing to the rear. Move gear right to clear exhaust pipe and remove through the left side of the vehicle.

Removal (Civic & Prelude)

1) Raise and support front of vehicle. Remove front wheels. Remove cotter pins and ball joint nuts and remove tie rod ends out of steering knuckles.

2) Remove bottom bolt from connector. Remove gearbox mounting bracket and bolts. Drop gearbox straight down until pinion is free of connector.

3) Rotate gearbox 180° and remove it through opening in left side of vehicle.

Installation (All Models)

To install steering gear, reverse removal procedures. Check operation of steering gear for smoothness and binding after installation.

OVERHAUL

STEERING GEAR

Disassembly

1) Place steering gear in a vise. Disconnect air tube and dust boot clamps. Push dust boots out of way, bend up lock washer tabs and remove tie rods from rack.

2) Remove rack adjusting screw lock nut, adjusting screw, washer, spring and rack piston. Remove pinion boots, dust seal and snap ring, then pull pinion gear out of steering housing. Remove rack and rack bushing.

Inspection

Check all components for wear or damage, replace as necessary.

Reassembly

Coat sliding surfaces with grease, then reassemble in reverse order of disassembly. Use new lock washers on tie rods and adjust steering after installation in vehicle.

TIGHTENING SPECIFICATIONS

Application	Ft. Lbs. (N.m)
Adjusting Screw Lock Nut	18 (25)
Ball Joint Nut	32 (42)
Tie Rod Lock Nut	32 (42)