

Steering Columns

TOYOTA CELICA, CORONA, CRESSIDA, LAND CRUISER, PICKUP & SUPRA — TILT WHEEL

DESCRIPTION

Tilt steering wheels incorporate an upper steering shaft attached, by a universal joint, with an intermediate steering shaft. These shafts are held in place by upper and lower brackets.

Brackets are pinned together so that the upper bracket will move up or down. Upper bracket is locked in place by a pawl attached to a lever. Steering columns, on passenger vehicles, are of the collapsible type while the Land Cruiser and Pickup steering column is non-collapsible.

REMOVAL & INSTALLATION

STEERING COLUMN

Removal

1) Remove steering wheel pad. Mark steering shaft and wheel for installation. Remove steering wheel. Remove dash panels and pads, if necessary. On models with air conditioning, remove air duct under steering column.

Fig. 1: Exploded View of Passenger Car Tilt Steering Column

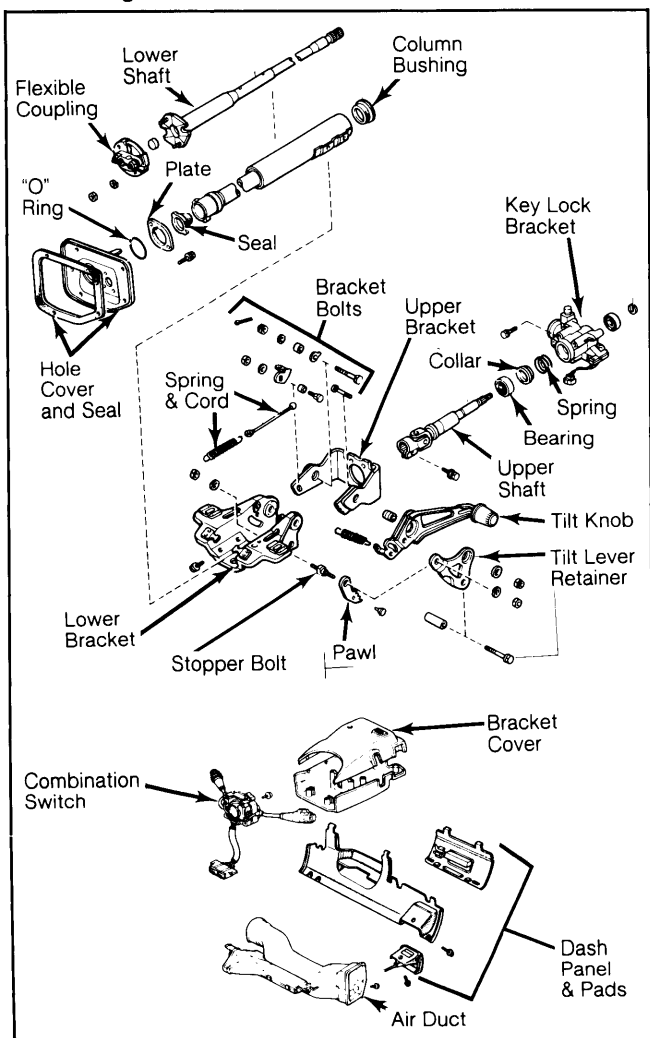

2) Remove column bracket covers. Remove turn signal or combination switch. From under hood, disconnect steering shaft universal joint from steering gear (on passenger vehicles) or from lower steering shaft (on Land Cruiser and Pickup models).

3) Be sure to mark universal joint and shaft for installation. Remove bolts from column hole cover. Remove column support bracket bolts. Remove steering column from vehicle.

Installation

1) Install steering column in vehicle and tighten column bracket bolts finger tight. Install column hole cover bolts. Tighten column bracket bolts.

2) Make sure alignment marks are aligned on universal joints, then tighten clamp bolts. Install turn signal or combination switch. Install bracket covers, dash panels and pads. Install air ducts (if equipped).

3) Install steering wheel and steering wheel pad. Make sure alignment marks on steering shaft and steering wheel are aligned.

Fig. 2: Exploded View of Land Cruiser & Pickup Tilt Wheel Steering Column

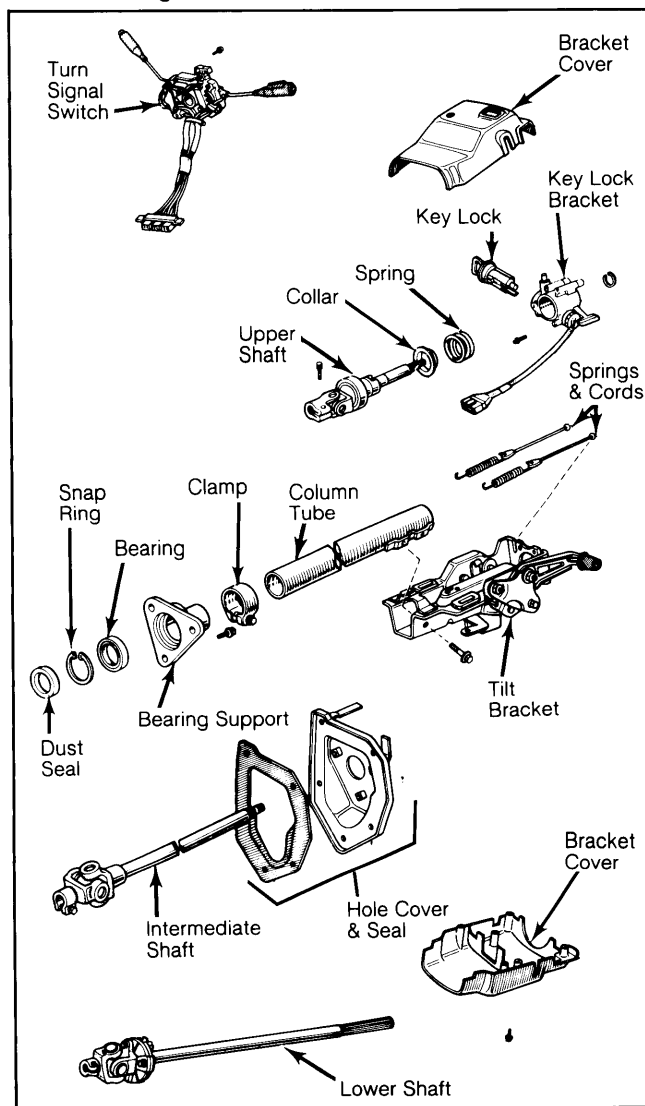

Steering Columns

TOYOTA CELICA, CORONA, CRESSIDA, LAND CRUISER, PICKUP & SUPRA — TILT WHEEL (Cont.)

OVERHAUL

STEERING COLUMN

Disassembly

1) On Land Cruiser and Pickup models, remove ignition key cylinder. On all models, remove tension springs and cords. Mark universal joint and lower steering shaft.

2) Remove clamp bolt and lower steering shaft. Remove hole cover from column. Remove snap ring from upper steering shaft.

3) Remove reclining pawl release pin and steering pawl. Drive out serrated bolt with soft mallet. Remove reclining pawl set bolt.

Fig. 3: Exploded View of Tilt Wheel Bracket

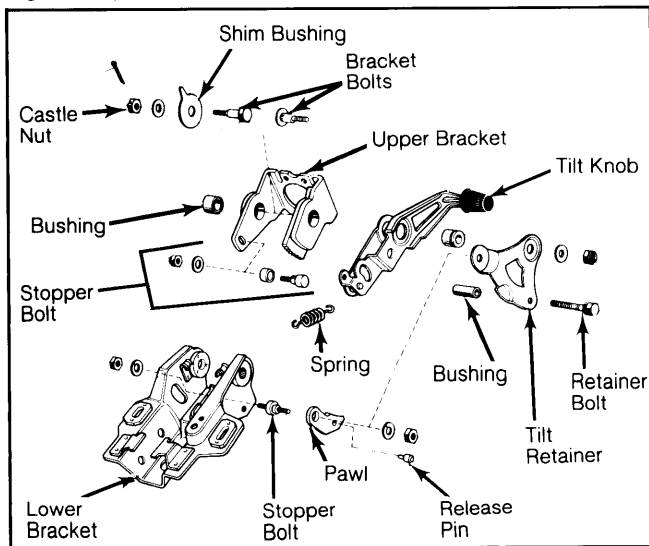

Inspection

1) Check upper bracket for damage. Check upper bearing for rotating smoothness. Check steering shafts for bending, damaged splines or damaged universal joints.

2) Check tilt bracket for worn bushings, damaged pawl, broken or damaged breakaway brackets. Check column tube for bending or other damage. Repair or replace components as necessary.

Reassembly

Reassemble in reverse order of disassembly procedures. Make sure all bushings, bearings, shims and bolts are not damaged or worn.

TIGHTENING SPECIFICATIONS

Application	Ft. Lbs. (N.m)
Castle Nut	11-21 (15-28)
Flexible Coupling	15-21 (20-28)
Steering Wheel Nut	22-28 (30-38)
Support Bracket	
Land Cruiser & Pickup	11-15 (15-20)
All Others	14-22 (19-30)
Support Bracket-to-Column	11-15 (15-20)
Tilt Lever Retainer Bolt	11-15 (15-20)
Tilt Steering Support Stopper Bolt	6-8 (8-11)
Universal Joint Clamp Bolt ¹	15-21 (20-28)

¹ — Tighten clamp bolt at steering gear on Land Cruiser and Pickups to 22-32 ft. lbs. (30-44 N.m).