

## TOYOTA COROLLA & CORONA

### DESCRIPTION

Columns used on Corolla and Corona models are collapsible 2-piece design. Columns use plastic shear pins to absorb collision impact. A flexible coupling connects steering shaft to steering gear.

### REMOVAL & INSTALLATION

#### STEERING COLUMN

##### Removal

1) Disconnect battery ground cable. Remove steering wheel. See *Toyota in Steering Wheel & Column Switches* article in this Section. On Corona, remove fuse block cover.

2) On both models, remove instrument panel cover (under column). On Corona, remove heater duct below column.

**Fig. 1: Proper Installation of Steering Column Locating Pin**

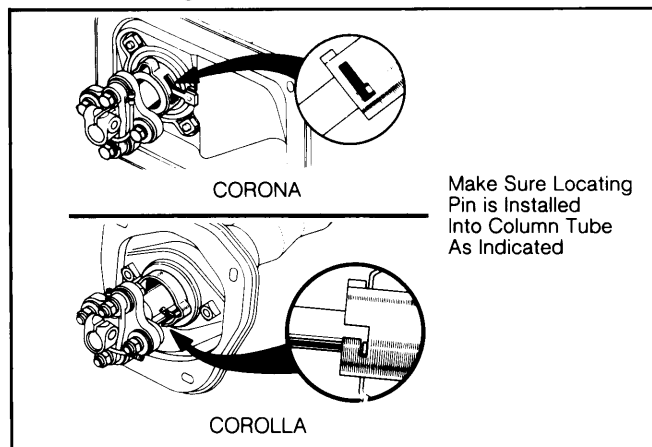

3) Remove upper and lower column covers. Remove combination switch. Remove flexible coupling bolt connecting steering shaft with gear (mark flexible coupling-to-gear shaft before removing).

**Fig. 2: Exploded View of Corolla and Corona Steering Column**

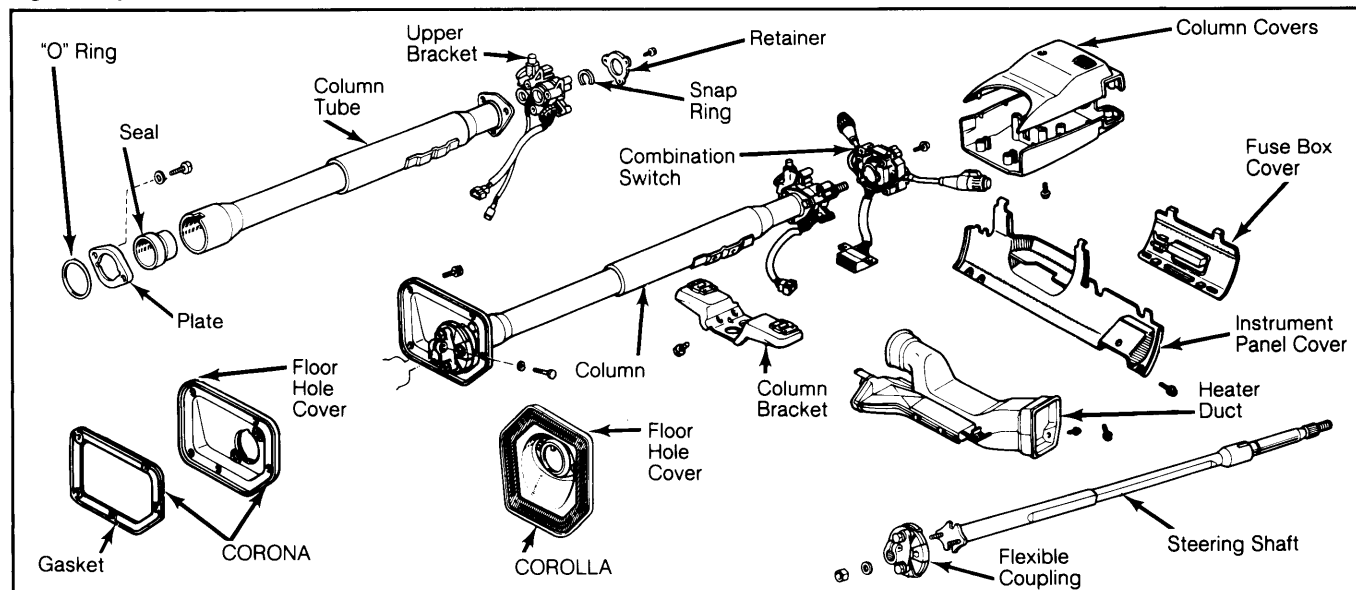

4) Remove column bracket bolts and floor hole cover bolts. Remove steering column from inside vehicle.

##### Installation

To install, reverse removal procedures. Make sure marks on flexible coupling and gear shaft are aligned. Make sure steering wheel is horizontal when wheels are in straight-ahead position.

### OVERHAUL

#### STEERING COLUMN

##### Disassembly

1) Remove retainer and snap ring from upper end of steering column. Remove flexible coupling from steering shaft. Remove hole cover, ring, plate and seal from lower end of steering shaft.

2) Pull column tube off steering shaft from upper end of shaft. Remove upper bracket from column tube.

##### Inspection

1) Check all components for damage or wear. Check steering shaft for bend or damage. Check column for sheared plastic pins.

2) Check upper bracket for proper operating lock mechanism. If necessary, upper bracket bearing can be replaced.

##### Reassembly

1) To reassemble steering column, reverse disassembly procedures. Make sure to grease steering shaft, bushings and bearings.

2) Also make sure lock on upper bracket operates properly and steering shaft is not binding in column tube.

#### TIGHTENING SPECIFICATIONS

Application	Ft. Lbs. (N.m)
Column Bracket (Breakaway)	
Corolla .....	22-33 (30-45)
Corona .....	14-22 (19-30)
Flexible Coupling Bolt .....	15-22 (20-30)
Steering Wheel .....	22-29 (30-39)