

Steering Columns

RENAULT 18i, FUEGO, FUEGO TURBO & LE CAR

DESCRIPTION

Vehicles are equipped with an energy absorbing collapsible column. The steering column is designed in 2 separate sections, which are joined by a universal joint.

The upper portion of the column is designed with a sliding section which compresses on vehicle impact. At the lower end of the bottom section, the steering column is connected to the pinion flange of the steering gear through a flexible rubber coupling.

REMOVAL & INSTALLATION

STEERING COLUMN

Removal

1) Disconnect battery. Unclip speedometer cable in engine compartment. Remove instrument cluster cowl. Pry clips on sides of cluster inward and pull cluster forward.

2) Disconnect wiring and speedometer cable. Remove cluster. Remove steering wheel pad and steering wheel. Detach lower column cover. Remove screws and lift off combination switch from column.

3) Disconnect wiring from switch. Remove fuse box screws and place box to one side. Disconnect universal joint.

Fig. 1: Exploded View of Renault Steering Column

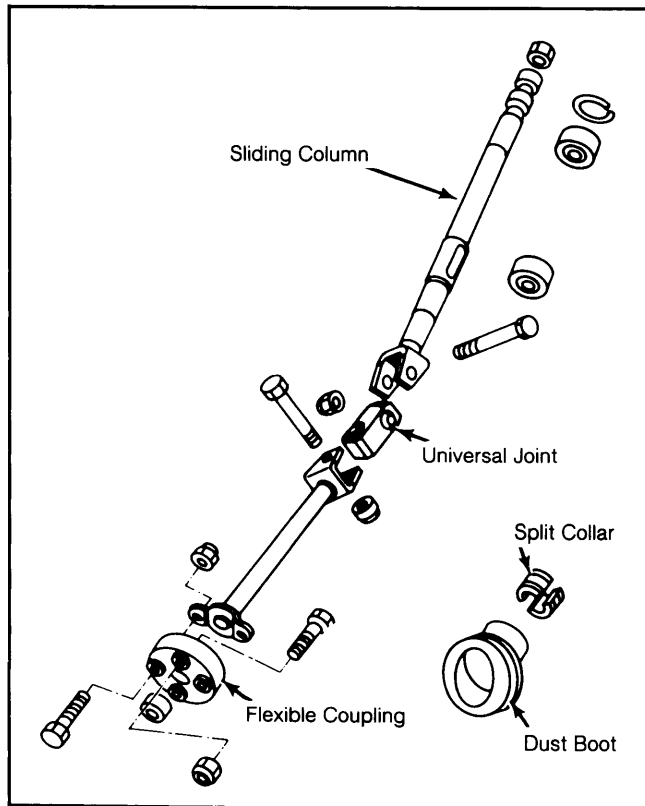

4) Mark column clamp position. Remove shaft flexible coupling at steering box. Remove clamps from column tube. Pull column assembly free from dashboard.

Installation

1) To install, reverse removal procedures. Tighten upper column clamp at the end of installation. Set

gear at center position before connecting universal joint in the following manner:

2) With front of vehicle raised, set steering box at center point. Tighten bottom joint pin. Turn steering 1/4 turn to left or right, then tighten upper universal joint pin.

3) Lower vehicle and reconnect all wiring, tighten bolts securely and check shaft for binding or rubbing.

OVERHAUL

REPLACING COLUMN BUSHINGS

Disassembly

Tap upper end of steering shaft until lower bushing comes out of column tube. Remove snap ring from top of column tube and carefully pry out bushing with screwdriver. See Fig. 2.

Fig. 2: Removing Upper Column Bushing

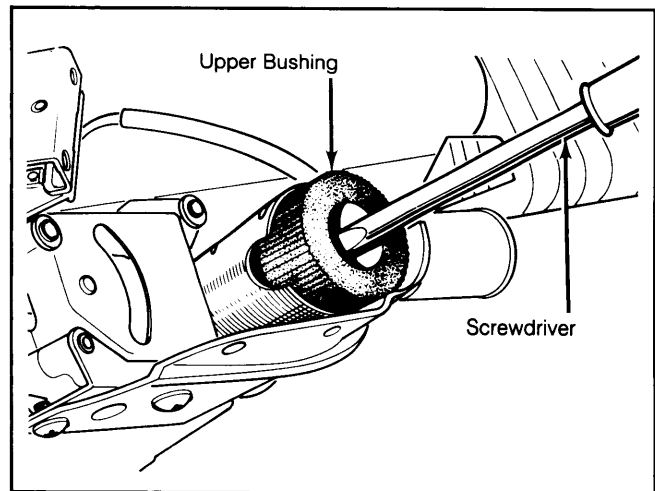

Pry equally on all sides when removing bushing.

Reassembly

1) Coat new bushing with grease. Position lower split bushing on steering shaft and fit an old bushing below it which has been turned down .079" (2 mm) in diameter.

2) Insert lower bushing by pulling steering shaft upward. Push shaft back slightly to recover used bushing. Using a sleeve, replace upper bushing. Insert snap ring and install column in vehicle.