

Steering Columns

ISUZU P'UP & LUV

DESCRIPTION

Column is fastened to steering gear through a flexible coupling. The energy absorbing shaft will collapse during impact under predetermined loads, by shearing plastic pins.

REMOVAL & INSTALLATION

NOTE: Before beginning removal and installation, inspect steering shaft shear pins. If steering shaft plastic pins have been sheared, shaft will rattle when struck lightly from side.

STEERING COLUMN

Removal

1) Disconnect battery ground cable. Remove horn cover and spring. Remove steering column shrouding and hazard warning light switch. Remove combination switch. Remove steering wheel. See *LUV in Steering Wheel & Column Switches* article in this Section.

2) Working inside engine compartment, remove upper coupling clamp pinch bolt from steering shaft flexible coupling.

3) Scribe a reference mark across steering shaft and coupling clamp to ensure proper installation. Disconnect combination and ignition switch wiring at harness connector.

4) Remove steering column-to-instrument panel bolts. Separate rubber coupling from steering shaft.

5) Slide steering column toward inside of passenger compartment and remove from vehicle.

Installation

To install, reverse removal procedures. Make sure to align reference mark on steering shaft to mark on coupling clamp.

FLEXIBLE COUPLING

Removal

1) Raise vehicle and support with safety stands. Remove coupling through bolts and lock nuts. Remove pinch bolts on upper and lower flanges of coupling.

2) Remove column bracket retaining bolts. Pull steering column rearward approximately 2.0" (51 mm). Remove upper coupling flange, coupling, and lower coupling flange.

Installation

Install lower coupling flange. Install coupling and upper coupling flange. To complete installation, reverse removal procedure.

TIGHTENING SPECIFICATIONS

Application	Ft. Lbs. (N.m)
Column-to-Instrument Panel	11 (15)
Column-to-Worm Shaft Clamp	20 (27)
Coupling Through Bolts	18 (24)
Shaft Coupling Clamp	20 (27)
Steering Wheel Nut	22 (30)

Fig. 1: Exploded View of P'UP & LUV Steering Column Assembly

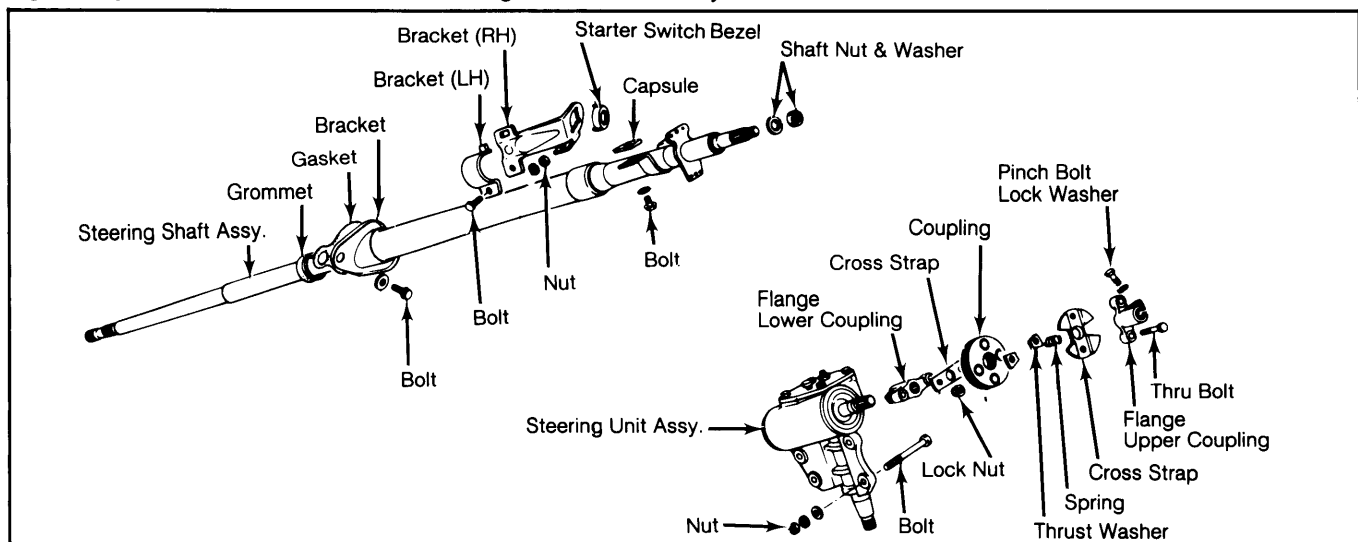

Avoid impact to steering wheel at all times.