

## HONDA ACCORD, CIVIC & PRELUDE

### DESCRIPTION

Steering columns are mounted with an impact absorbing plate on the upper bracket that deforms under pressure.

A plastic bracket collar at the lower end of the column allows the assembly to slide, and double universal joints absorb impact without the need for a collapsing column.

### REMOVAL & INSTALLATION

#### STEERING COLUMN

##### Removal (Civic & Prelude)

1) Remove steering wheel. See *Honda in Steering Wheel & Column Switches* article in this Section. Disconnect steering joint at splines by removing clamp bolt.

2) Remove wire connectors below column. Remove retaining bolts (upper bolts first) and take entire assembly out of vehicle.

##### Installation

To install, reverse removal procedures. Ensure that front wheels are straight-ahead when steering wheel is installed.

##### Removal (Accord)

1) Remove steering wheel. Disconnect wire harness. Remove middle clamp bolt in universal joint shaft. Detach lower dash panel.

2) Remove nuts retaining column to mounting brackets (remove upper nuts first). Remove column from vehicle.

**NOTE:** If steering wheel has been removed, ignition switch must be in "LOCK" position to retain steering shaft during column removal.

##### Installation

1) Insert column in vehicle. Slide upper half of connector on bottom end of steering shaft. Install top bolt across flat part of shaft. Loosely install upper bracket nuts.

2) Pull down on column to seat bending plate against hook. Connect bottom connector to gearbox shaft, install bolt and tighten. Loosely install lower bracket.

3) Tighten upper and lower bracket nuts. To complete installation, reverse removal procedures.

### OVERHAUL

#### STEERING COLUMN

##### Disassembly

1) Remove steering wheel and column switches. See *Honda in Steering Wheel & Column Switches* article in this Section.

2) Remove rubber bands, bending plate and upper mounting plate. On Civic and Prelude models, remove snap ring and steering shaft washer from upper end of steering shaft.

3) Turn ignition switch to "I" position on Prelude or "ACC" position on Civic. On all models, remove plastic collar, shaft bushing and column hanger bushing.

4) Pull steering shaft out from bottom end of column. Remove thrust ring, bushing and horn ring from top end of column.

Fig. 1: Exploded View of Civic and Prelude Steering Column

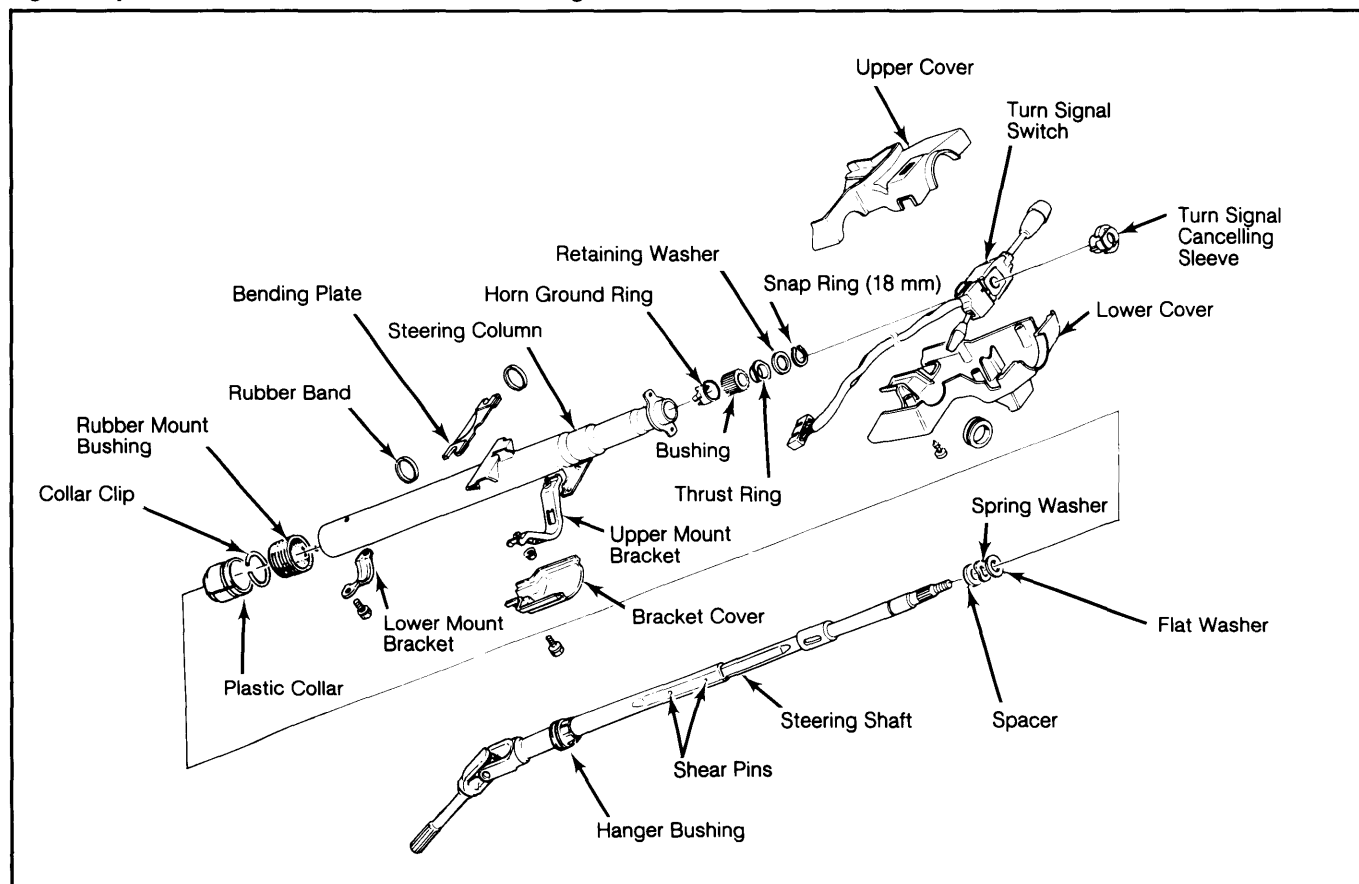

# Steering Columns

## HONDA ACCORD, CIVIC & PRELUDE (Cont.)

Fig. 2: Exploded View of Accord Steering Column

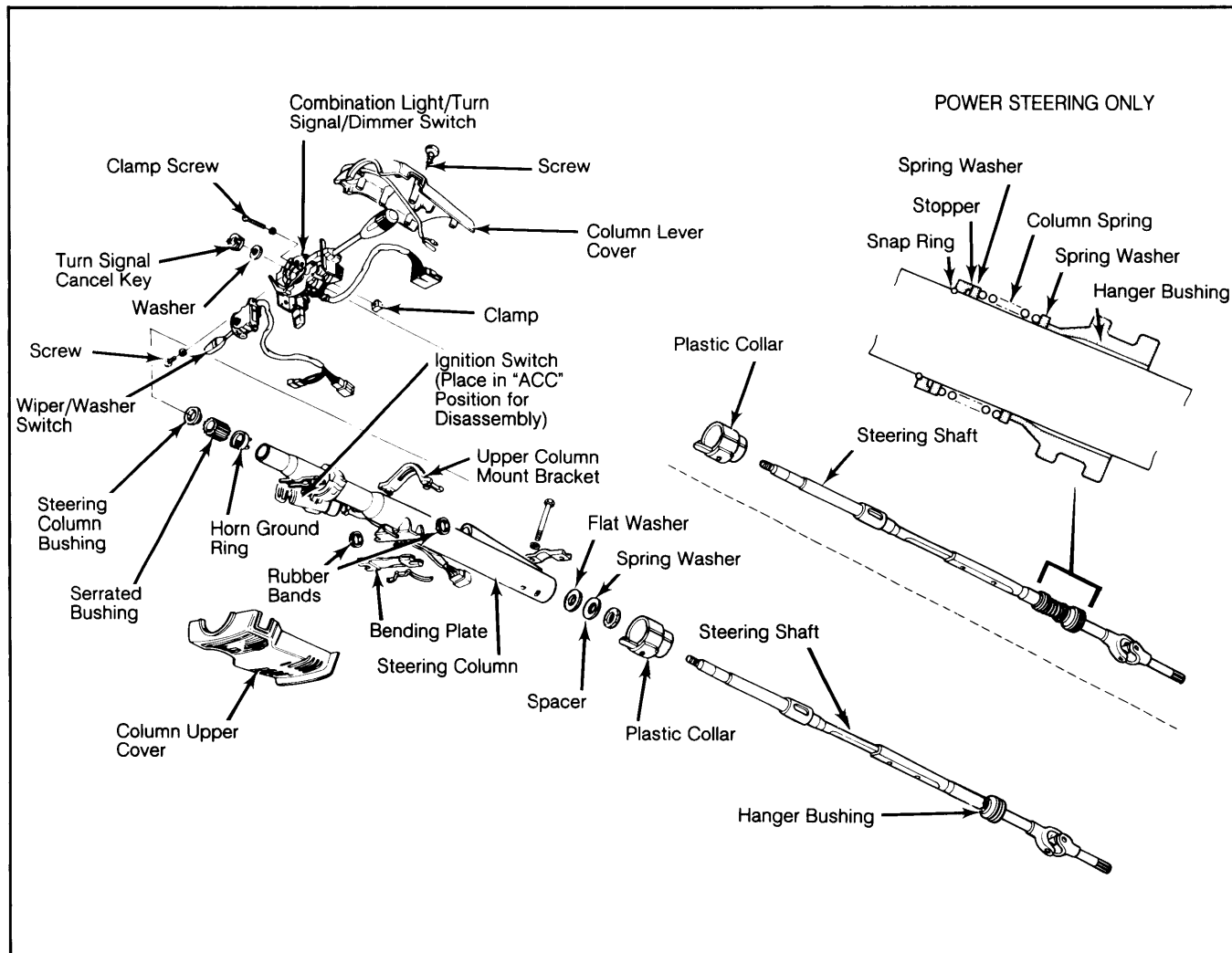

5) On Accord models with power steering, remove rubber stop, plastic collar, washer, spring, washer and snap ring before pulling steering shaft out of bottom end of steering column.

### Reassembly

1) Install horn ground ring, serrated bushing and thrust ring in steering column. Flat sides of thrust ring should be aligned with slots in steering column.

2) Grease top end of steering shaft and carefully insert in column. Be careful not to bend horn ground ring. Fill bottom of column with grease and install plastic hanger bushing.

3) Align tab in column with cut-away in bushing. On Accord models with power steering, install snap ring, washer, spring and washer before installing plastic hanger bushing.

4) On all models, install plastic collar to bottom of column, align round projection on inside of collar with hole in column. On Accord models with power steering, install rubber stop. On Civic and Prelude models, install snap ring to top end of steering shaft.

5) On Accord models, attach connector shaft universal joint to steering shaft so clamp bolt rests at bottom of machined flat of steering shaft. Tighten clamp bolt.

**NOTE:** On Accord models, place ignition switch in the "O" position to prevent shaft from sliding out during installation.

6) Install column switches. Use rubber bands to assemble upper bracket and bending plate to steering column. Bending plate should fit under hook on column with arrow mark facing out and pointing down. Install upper and lower covers.

### TIGHTENING SPECIFICATIONS

Application	Ft. Lbs. (N.m)
Column Bracket Bolts	
Upper .....	9 (12)
Lower .....	16 (22)
Universal Clamp Bolts .....	22 (30)