

# Steering Wheel & Column Switches <sup>12-11</sup>

## ISUZU (Cont.)

### Installation

To install, reverse removal procedures.

### STEERING LOCK & IGNITION SWITCH

#### Removal (I-Mark)

Remove steering wheel and column covers.

Remove snap ring, washer and retaining bolts on column flange. Remove ignition switch and steering lock assembly.

### Installation

To install, reverse removal procedures.

#### Removal (P'UP)

Remove steering wheel. Remove upper and lower column covers. Disconnect ignition switch wiring connector. Remove switch cover. Remove ignition switch ring nut and switch.

### Installation

To install, reverse removal procedures.

Fig. 1: I-Mark Disassembled Steering Wheel Assembly

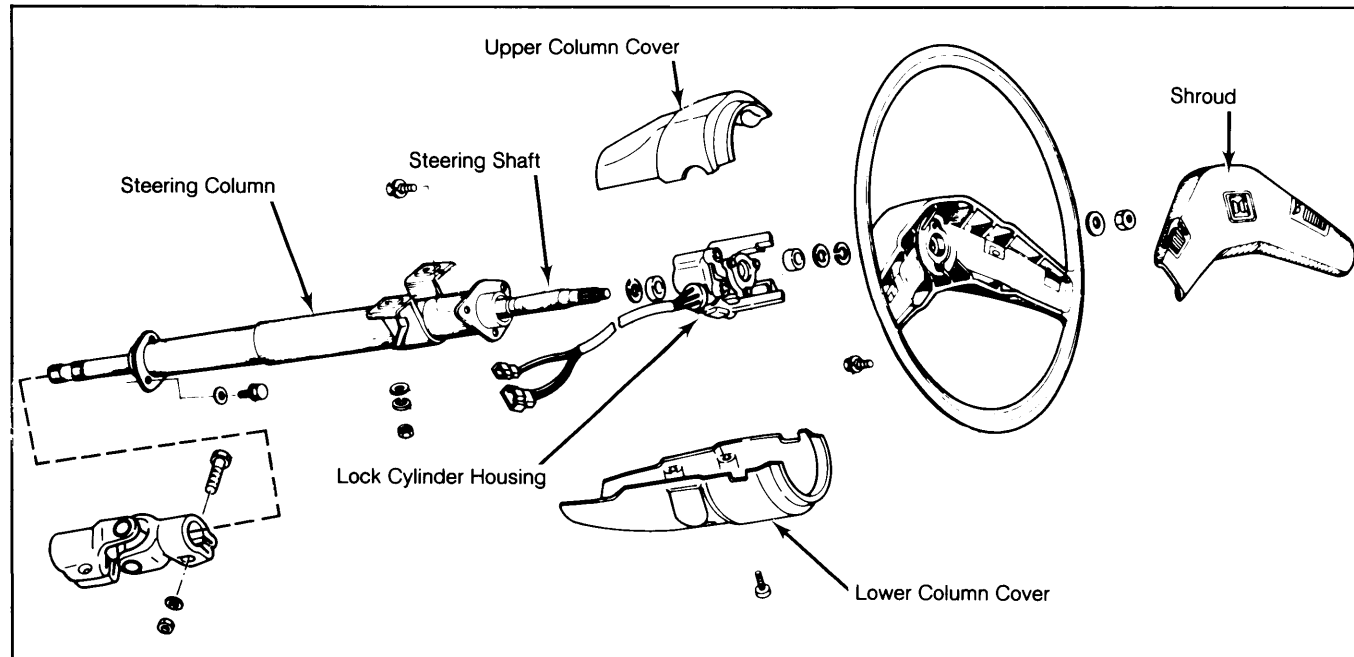

P'UP steering wheel assembly is similar.

## JAGUAR

### REMOVAL & INSTALLATION

#### HORN PAD & STEERING WHEEL

##### Removal

1) Set front wheels in straight-ahead position.

Mark position on steering wheel and column shaft. Remove screws retaining lower switch cover. Detach cover.

2) Working from below, remove clamp bolt retaining split collet adapter to steering column. See Fig. 1. Loosen lock nut on set screw and loosen screw 2 turns. Remove steering wheel, complete with hand lock nut, impact rubber bumper, collet adapter and shaft.

##### Disassembly

1) Remove self-tapping screws from lower face of steering wheel boss and lift off padded horn contact. Unscrew nylon nut from top of steering wheel shaft and carefully remove it. Remove horn contact tube.

2) Remove self-locking nut and plain washer which retain steering wheel. Carefully pull steering wheel from shaft. Collect both halves of split cone.

##### Reassembly

To reassemble, reverse disassembly procedures.

##### Installation

To install, reverse removal procedures. Be sure that front wheels are always kept in a straight-ahead position. When tightening collet clamp, tighten grub screw finger tight. Snug down lock nut and tighten clamp bolt.

#### STEERING LOCK

##### Removal

Take off upper column shrouding. Using a center punch, make several dimples in shear bolt and rotate bolt out.

##### Installation

To install, reverse removal procedure.

# 12-12 Steering Wheel & Column Switches

## JAGUAR (Cont.)

Fig. 1: Components Located Behind Steering Wheel

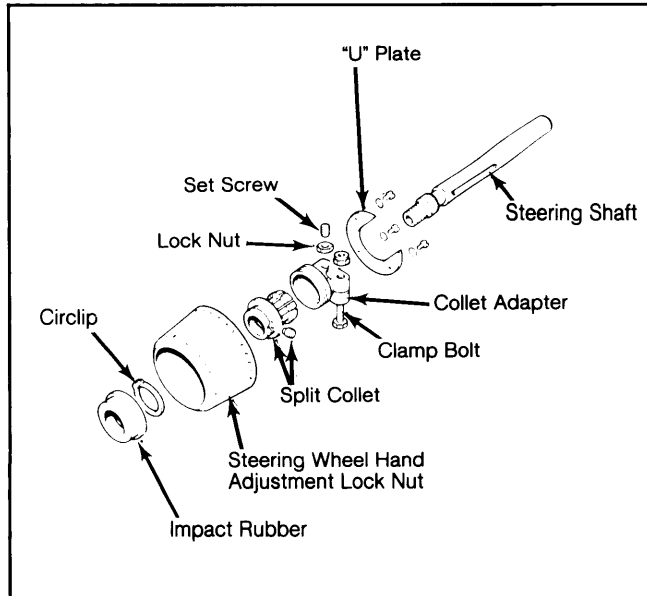

Collect split collet and save for reassembly.

### IGNITION SWITCH

#### Removal

Disconnect battery ground cable. Separate column shrouding from switch side. Disengage retaining ring holding ignition switch in housing. Disconnect ignition switch wiring at multi pin connector. Remove switch and harness.

#### Installation

To install, reverse removal procedure.

### COMBINATION SWITCH

#### Removal

1) Disconnect battery cable. Take off steering column lower shroud. Remove steering wheel as previously outlined. Remove steering column upper shroud and cover from below instrument panel.

2) Loosen pinch bolt and pull combination switch assembly from steering column. Disconnect electrical wiring. Hazard flasher can now be separated by disconnecting wires, depressing tangs and pushing switch through mounting plate.

#### Installation

To install, reverse removal procedures.

Fig. 2: Combination Switch Location and Assembly

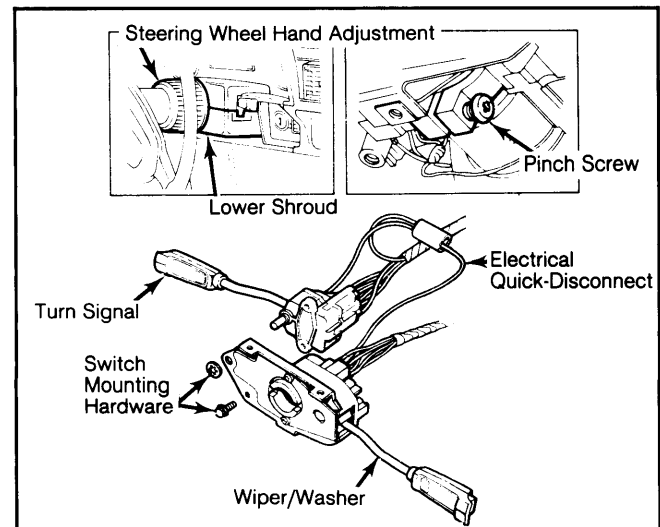

## LUV

### REMOVAL & INSTALLATION

#### HORN BUTTON & STEERING WHEEL

##### Removal

1) Disconnect battery ground cable. Remove retaining screws and horn pad. Disconnect horn wires from pad.

**CAUTION:** Steering shaft is an energy absorbing unit. During any service operation, avoid jarring or leaning on any portion of column.

2) Unscrew steering wheel retaining nut. Mark position of steering wheel on column shaft. Remove retaining screws to column cowling. Remove cowling.

3) Using a puller (J-24292-A), remove steering wheel.

##### Installation

To install, reverse removal procedures.

#### COMBINATION SWITCH

##### Removal

1) Remove steering wheel. Disconnect battery ground cable. Remove retaining screws and remove cowling.

2) Disconnect wire connectors from switch. Remove retaining screws. Remove switch from column flange.

#### NOTE:

**Combination switch has the following functions: Turn signal, headlight dimmer, hazard warning, and windshield wiper/washer.**

#### Installation

To install, reverse removal procedure.

#### IGNITION SWITCH

##### Removal

Disconnect battery cable. Remove retaining screws and remove cowling. Disconnect wiring connector at switch. Remove switch ring nut and remove switch.

##### Installation

To install, reverse removal procedures.