

12-10 Steering Wheel & Column Switches

HONDA

REMOVAL & INSTALLATION

HORN PAD & STEERING WHEEL

Removal

1) Disconnect battery ground cable. Pull out and remove steering wheel horn pad. With wheels in straight-ahead position, mark position of steering wheel to shaft. Remove retaining nut.

2) Remove steering wheel with puller. Steering wheel components should be disassembled and replaced, if necessary.

Installation

To install, reverse removal procedures. Ensure wheels are straight-ahead and marks made at removal are aligned.

COMBINATION SWITCH

Removal

1) Remove steering pad. Remove column shrouding. Disconnect electrical connectors and remove steering wheel. Remove retaining screws and lift out combination switch.

2) Washer/wiper switch can be separated from turn signal switch. Do not drop or lose turn signal cancel cam key when removing combination switch.

Installation

To install, reverse removal procedures. Insert lug on turn signal switch assembly into recess in steering column. Turn signal cancel key lugs must fit into recess in steering wheel. Horn switch spring terminal must touch contact ring.

HAZARD SWITCH

Switch is located in the top column shrouding. Remove top shrouding, disconnect electrical wires and remove switch from mounted position.

NOTE: Accord models also have an indicator light switch located in the upper column shrouding. The switch, when depressed, will allow

all indicator lights to function. Procedures for Hazard switch apply.

Fig. 1: Exploded View of Steering Column Components

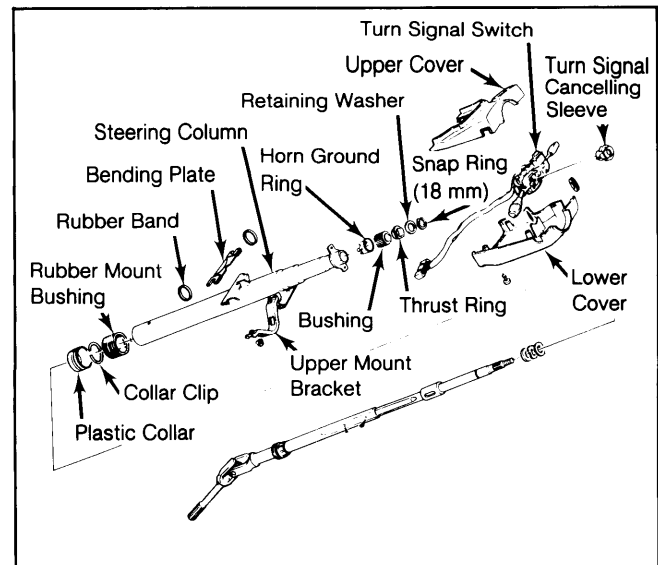

Civic model is shown; others are similar.

STEERING LOCK & IGNITION SWITCH

Removal

1) Remove steering column upper and lower shrouding. Disconnect ignition switch electrical wiring at lower end of steering column.

2) Center punch shear bolts. Drill out shear head bolts and extract from lock bracket. Remove ignition switch.

Installation

Insert new ignition switch. Hand tighten new shear bolts. Check switch operation at this time. Tighten shear bolts. Reconnect switch electrical leads.

ISUZU

REMOVAL & INSTALLATION

CAUTION: Steering shaft is an energy absorbing unit. During any service operation, avoid hammering, jarring, or leaning on any portion of column.

HORN BUTTON & STEERING WHEEL

Removal

1) Disconnect battery ground cable. Remove retaining screws on back of steering wheel. Remove horn pad. Disconnect horn wires.

2) Unscrew steering wheel retaining nut. Mark position of steering wheel on column shaft. Using steering wheel puller (J-29752), remove steering wheel.

Installation

To install, reverse removal procedures.

COMBINATION SWITCH

Removal

Remove steering wheel. Unscrew retaining screws to upper and lower column covers and remove. Disconnect electrical connectors. Remove retaining screws and combination switch.

Installation

To install, reverse removal procedures.

HAZARD WARNING SWITCH

Removal

Remove steering wheel. Unscrew retaining screws to upper and lower column covers and remove. Disconnect electrical connectors. Remove retaining screws. Remove combination switch and hazard warning switch.

Steering Wheel & Column Switches ¹²⁻¹¹

ISUZU (Cont.)

Installation

To install, reverse removal procedures.

STEERING LOCK & IGNITION SWITCH

Removal (I-Mark)

Remove steering wheel and column covers.

Remove snap ring, washer and retaining bolts on column flange. Remove ignition switch and steering lock assembly.

Installation

To install, reverse removal procedures.

Removal (P'UP)

Remove steering wheel. Remove upper and lower column covers. Disconnect ignition switch wiring connector. Remove switch cover. Remove ignition switch ring nut and switch.

Installation

To install, reverse removal procedures.

Fig. 1: I-Mark Disassembled Steering Wheel Assembly

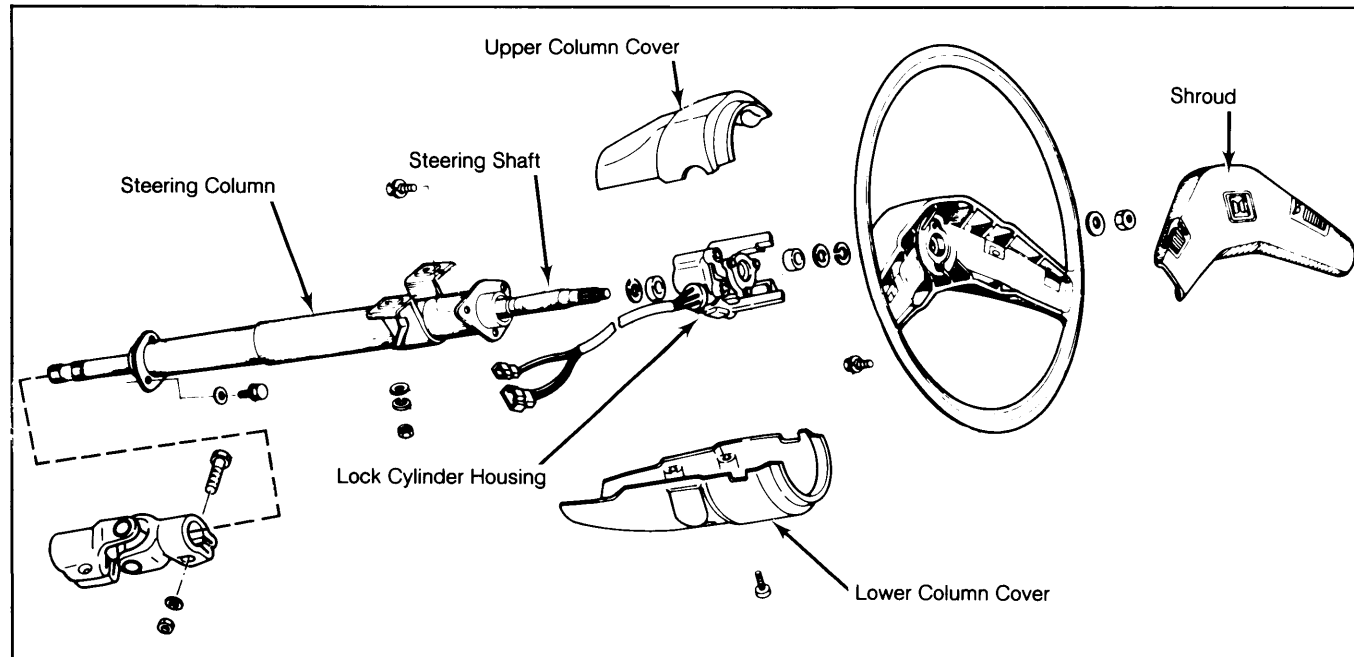

P'UP steering wheel assembly is similar.

JAGUAR

REMOVAL & INSTALLATION

HORN PAD & STEERING WHEEL

Removal

1) Set front wheels in straight-ahead position.

Mark position on steering wheel and column shaft. Remove screws retaining lower switch cover. Detach cover.

2) Working from below, remove clamp bolt retaining split collet adapter to steering column. See Fig. 1. Loosen lock nut on set screw and loosen screw 2 turns. Remove steering wheel, complete with hand lock nut, impact rubber bumper, collet adapter and shaft.

Disassembly

1) Remove self-tapping screws from lower face of steering wheel boss and lift off padded horn contact. Unscrew nylon nut from top of steering wheel shaft and carefully remove it. Remove horn contact tube.

2) Remove self-locking nut and plain washer which retain steering wheel. Carefully pull steering wheel from shaft. Collect both halves of split cone.

Reassembly

To reassemble, reverse disassembly procedures.

Installation

To install, reverse removal procedures. Be sure that front wheels are always kept in a straight-ahead position. When tightening collet clamp, tighten grub screw finger tight. Snug down lock nut and tighten clamp bolt.

STEERING LOCK

Removal

Take off upper column shrouding. Using a center punch, make several dimples in shear bolt and rotate bolt out.

Installation

To install, reverse removal procedure.