

## HONDA

Accord, Civic (Exc. Wagon), Prelude

### DESCRIPTION

Rear suspension system is an independent type, with MacPherson type struts. Major components are lower control arm, vertical suspension struts with shock absorber and coil springs, rear hub carrier, radius rods (Accord) and radius arms (Civic and Prelude). Prelude models are equipped with a rear stabilizer bar.

### ADJUSTMENTS

#### WHEEL ALIGNMENT SPECIFICATIONS & PROCEDURES

See *Wheel Alignment Specifications and Procedures* in WHEEL ALIGNMENT section.

### REMOVAL & INSTALLATION

#### SHOCK ABSORBER

##### Removal

1) Raise vehicle and support with safety stands. Remove wheel assemblies. Disconnect brake line from bracket on shock absorber housing. Plug open ends and place lines out of the way. Disconnect parking brake cable from lever on backing plate.

2) On Prelude, remove nut from stabilizer bar connecting link. On Civic and Prelude, loosen control arm pivot bolt and front radius arm pivot bolt. On Accord, remove cotter pin and loosen outer control arm pivot bolt.

3) On all models, remove bolt mounting shock absorber to hub carrier. Remove upper shock absorber retaining nuts. Lower shock absorber and coil spring from vehicle.

Install spring compressor and slightly compress coils. Remove lock nut and piston rod center nut. Take off upper mounting hardware and coil spring.

##### Inspection

Check piston rod for smooth, even operation. Inspect for signs of oil leaks. Listen for noise or unusual binding during inspection.

##### Reassembly & Installation

To reassemble and install, reverse disassembly and removal procedures. Fit top of shock absorber first. Make sure tab on shock absorber engages slot in bearing carrier. Bleed brake system.

#### WHEEL HUB CARRIER

##### Removal

1) Raise vehicle and support with safety stands. Remove wheel assembly and brake drum. Disconnect and plug brake lines.

2) Remove bolt mounting shock absorber to hub carrier. Disconnect control arm and radius rod/arm from hub carrier. Remove hub carrier from vehicle.

##### Installation

To install, reverse removal procedures. Bleed brake system and check rear wheel alignment.

Fig. 1: Exploded View of Suspension Strut Assembly

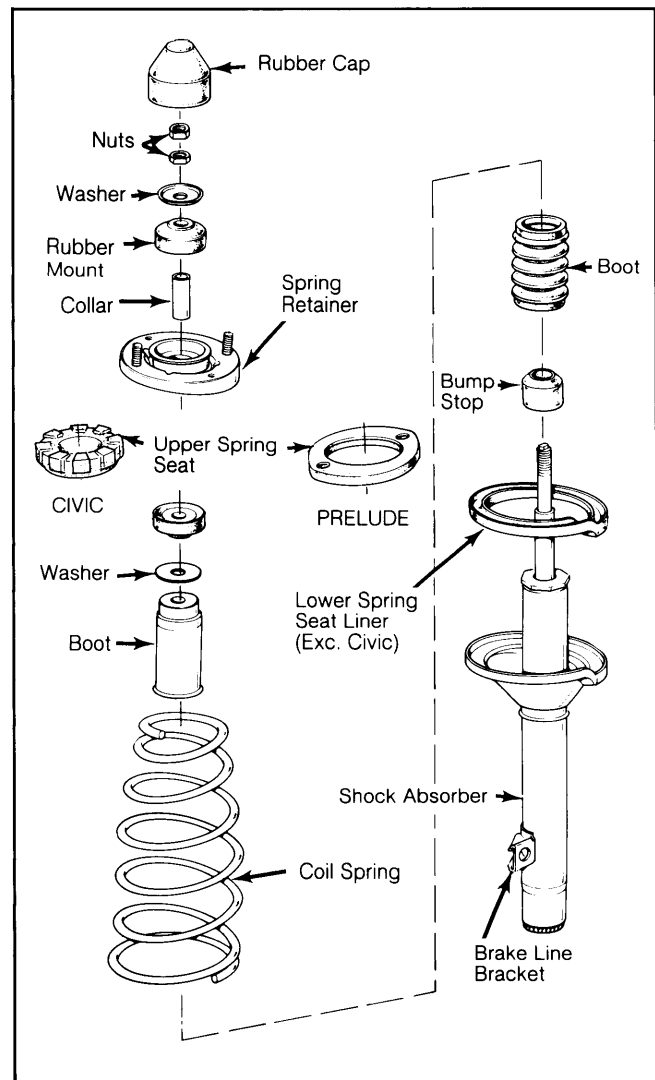

Civic & Prelude shown, Accord is similar.

#### RADIUS ROD/ARM

##### Removal

1) Raise vehicle and support with safety stands. On Prelude, remove stabilizer bar-to-radius arm nuts.

2) On all models, remove bolt(s) mounting radius rod/arm to hub carrier. Remove bolt(s) mounting opposite end of radius rod/arm to body bracket.

##### Inspection

Inspect all bushings and grommets for damage or excessive wear. Replace defective parts. Make sure radius rod/arm adjusting bolt is not damaged.

##### Installation

To install, reverse removal procedures. Either lower vehicle to floor or raise rear of vehicle to simulate normal weight before tightening radius rod/arm pivot bolts. Check rear wheel alignment.

# Rear Suspension

## HONDA (Cont.)

**Fig. 2: Exploded View of Accord Rear Suspension**

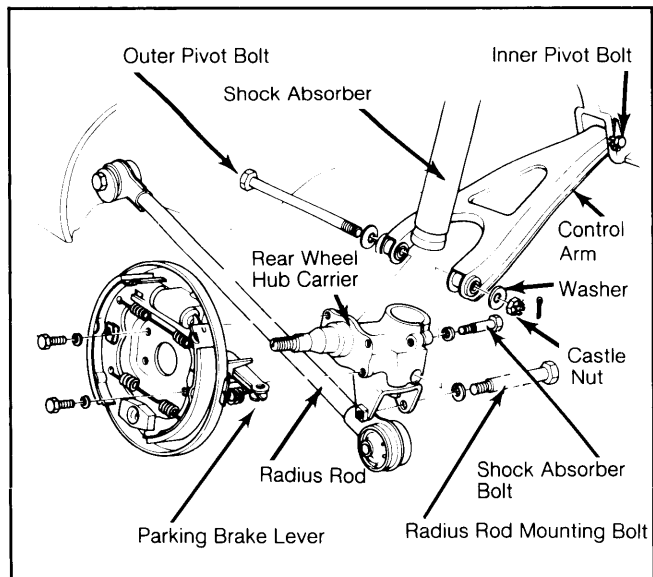

### CONTROL ARM

#### Removal

1) Raise vehicle and support with safety stands. Remove wheel assembly and brake drum. Remove brake hoses from shock absorber mounting, plug openings. Remove brake backing plate.

**Fig. 3: Exploded View of Civic and Prelude Suspension**

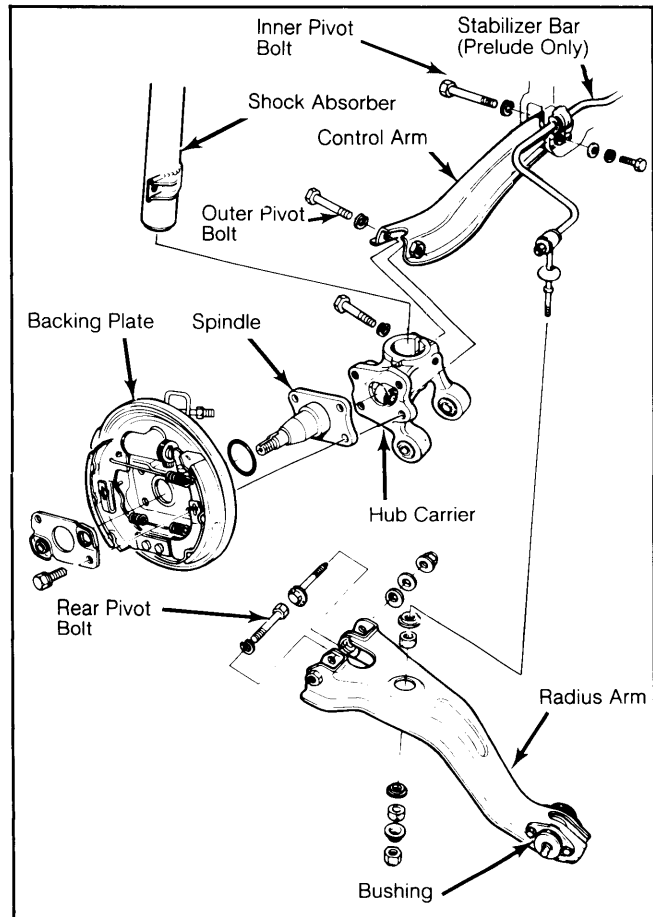

2) Remove bolt mounting suspension strut to hub carrier. Remove both inside and outside control arm pivot bolts. Pull out control arm.

#### Inspection

Inspect all control arm bushings for damage or excessive wear. Replace any parts found defective. Always replace bolt lock tabs.

#### Installation

To install, reverse removal procedures. Bleed brake system and check rear wheel alignment.

### STABILIZER BAR

#### Removal (Prelude Only)

Remove stabilizer bar-to-radius arm nuts. Remove bolts attaching stabilizer bar to body. Remove stabilizer bar from vehicle.

#### Installation

To install, reverse removal procedures. Install bar so that outside edges of Yellow paint stripes on bar align with outside edges of stabilizer bar bushings.

### TIGHTENING SPECIFICATIONS

Application	Ft. Lbs. (N.m)
Inner Control Arm Pivot Bolt	40 (54)
Lower Shock Absorber Bolt	40 (54)
Outer Control Arm Pivot Bolt	
Accord	60 (82)
Civic, Prelude	40 (54)
Radius Arm-to-Body	
Civic & Prelude	61 (83)
Radius Arm-to-Hub Carrier	
Civic & Prelude	
Inner Nut	40 (54)
Outer Bolt	74 (101)
Radius Rod-to-Body	
Accord	47 (64)
Radius Rod-to-Hub Carrier	
Accord	50 (68)
Shock Absorber Piston Nut	
Accord, Prelude	23 (32)
Civic	33 (45)