

# Rear Suspension

11-81

## DATSUN/NISSAN 280ZX & MAXIMA

### DESCRIPTION

Rear suspension is of the semi-trailing arm, independent type. The rear wheel is supported by a MacPherson strut type assembly and a semi-trailing arm. The upper end of the strut is attached directly to the upper body. The lower end of the strut is attached to the end of the semi-trailing arm.

The differential gear carrier is installed directly to the suspension subframe and a differential mounting bracket and insulator. The semi-trailing arm is installed on the subframe with rubber bushings and pivot bolts. The rear wheel bearing housing and lower strut mount bracket are welded to the end of the semi-trailing arm. A stabilizer bar is used attached for added suspension control.

### ADJUSTMENTS

#### WHEEL ALIGNMENT SPECIFICATIONS & PROCEDURES

See *Wheel Alignment Specifications & Procedures* in *WHEEL ALIGNMENT* section

#### WHEEL BEARING

Wheel bearings are adjusted by using a spacer sleeve between sealed wheel bearing and bearing housing. Rear wheel hub must be disassembled in order to adjust preload and rear axle shaft end play.

Fig. 1: Exploded View of 280ZX & Maxima Rear Suspension

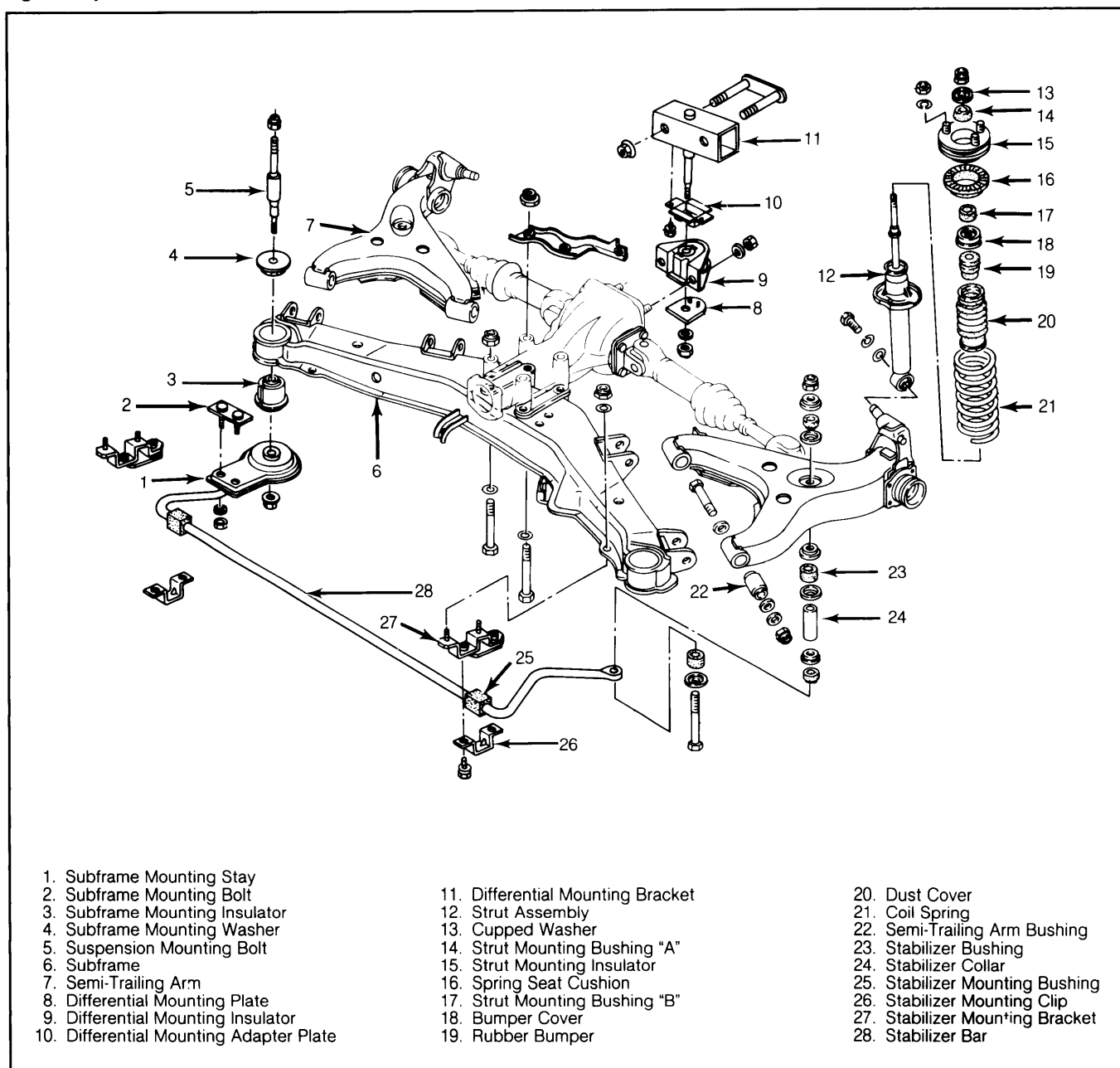

# Rear Suspension

## DATSUN/NISSAN 280ZX & MAXIMA (Cont.)

### REMOVAL & INSTALLATION

#### WHEEL BEARING

##### Removal

1) Raise vehicle and support with safety stands. Remove brake rotor and caliper assembly. Disconnect drive shaft from axle shaft. Remove wheel bearing lock nut using breaker bar.

2) Remove axle shaft. Remove companion flange. Remove grease seal and inner bearing using drift. Using bearing puller, remove outer bearing. Do not reuse bearing or grease seals.

##### Installation

1) Install wheel bearings, use bearing drift (ST37750000) to install outer bearing. Match mark stamped on housing and on spacer sleeve and install sleeve.

**NOTE:** Wheel bearing are sealed type. Sealed side of outer bearing must face the wheel and sealed side of inner bearing must face differential.

2) Install grease seal using seal installer (ST37710000). Tighten new bearing lock nut and measure preload and rear axle shaft end play.

3) Torque wheel bearing lock nut to specifications. Check wheel bearing preload. Preload should be 2.6 lbs. (12 N) or less. Rear axle shaft end play should be .012" (0.3 mm).

4) If correct preload and shaft end play cannot be obtained, disassemble again and replace bearing spacer sleeve.

#### STRUT & COIL SPRING

##### Removal

1) Raise rear of vehicle and support with safety stands. Support semi-trailing arm with floor jack. Open trunk lid, remove cover and nuts securing strut assembly to body.

2) Lower floor jack gradually. Disconnect strut by removing bolt at semi-trailing arm. Remove strut from vehicle.

##### Disassembly

For coil spring removal, use a spring compressor (ST35651001). Compress spring until mounting insulator can be turned by hand. Remove self-locking nut on strut shaft. Release spring compressor and remove coil spring.

##### Reassembly

Reverse disassembly procedure using a new self-locking nut on strut shaft.

##### Installation

Install strut assembly to upper body. Connect lower end of strut to semi-trailing arm and tighten bolt to specifications.

#### SEMI-TRAILING ARM

##### Removal

1) Raise vehicle and support with safety stands. Remove wheel assemblies. Disconnect brake line from hose at semi-trailing arm and brake assembly. Remove brake line. Disconnect axle shaft from stub shaft by removing flange bolts.

2) Remove stabilizer bar bolt and related hardware. Disconnect strut from semi-trailing arm. Discon-

nect semi-trailing arm from subframe by removing pivot bolts. Remove semi-trailing arm from vehicle.

##### Installation

To install, reverse removal procedures, noting the following: Replace all self-locking nuts. Tighten semi-trailing arm-to-subframe bolts to specifications only after installing wheels and lowering vehicle to floor. Bleed and adjust brakes.

#### REAR SUSPENSION ASSEMBLY

##### Removal

1) Raise and support vehicle with safety stands. Remove wheel assemblies. Remove heat shield from front of fuel tank. Remove rear exhaust pipe and muffler. Mark flange of propeller shaft and companion flange. Remove propeller shaft.

2) Disconnect and plug rear brake hoses at semi-trailing arm. Place a floor jack under center of suspension and differential assembly. Disconnect hand brake cables and lower strut ends.

3) Remove subframe nuts at body. Remove differential mount lock nut. Lower rear suspension assembly and remove from under vehicle.

##### Disassembly

1) Disconnect axle shafts from differential and stub shafts. Remove differential assembly from subframe. Remove pivot bolts and semi-trailing arms.

2) Insulator bushings can be removed with removal/installation tool (ST38280000).

##### Reassembly & Installation

Reassemble and install in reverse order of disassembly and removal, while noting the following: Final tightening of semi-trailing arm pivot bolt lock nuts should be done after vehicle has been lowered to the floor. All self-locking nuts should be replaced, if they were removed.

#### TIGHTENING SPECIFICATIONS

Application	Ft. Lbs. (N.m)
Wheel Bearing Lock Nut .....	181-239 (245-324)
Differential Mount Lock Nut .....	87-108 (118-146)
Propeller Shaft-to-Flange .....	25-33 (34-45)
Semi-Trailing Arm Pivot Nuts .....	58-72 (79-98)
Stabilizer Bar-to-Semi-Trailing Arm .....	12-15 (16-20)
Strut Lower Mount Bolt .....	43-58 (58-79)
Strut Upper Mount Nut .....	22-29 (30-39)
Subframe-to-Body Nuts .....	58-72 (79-98)