

CHRYSLER CORP. IMPORTS — RWD MODELS

Challenger, Sapporo

DESCRIPTION

Rear suspension is of the 4-link coil spring type. Lower arm and upper control arm are attached to rear axle housing brackets and to body with individual bushings. Shock absorbers attach to body and to rear axle housing.

Fig. 1: Exploded View of Rear Suspension

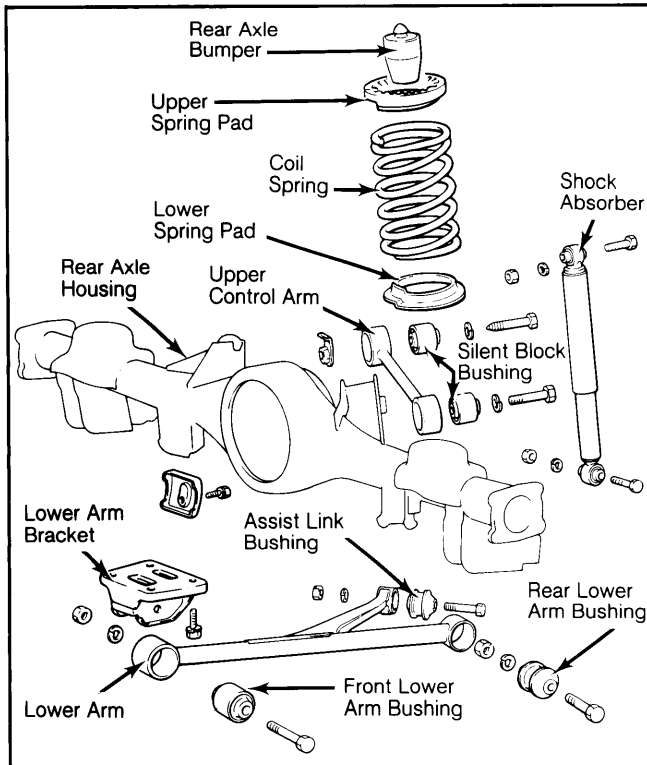

REMOVAL & INSTALLATION

WHEEL BEARING

Removal

1) Raise and support vehicle on safety stands. Remove wheel assembly. Remove brake disc (drum if equipped). On models with disc brakes, remove caliper support together with parking brake cable and caliper assembly (brake hose connected), and support out of the way.

2) Remove brake disc. On all models, utilizing hole in flange of rear axle shaft, remove bolts attaching bearing outer retainer to rear axle housing. Pull rear axle shaft from housing. Remove oil seal with a screw driver.

3) Remove bearing inner retainer by grinding down retainer to a thickness of .04-.06" (1.0-1.5 mm). Using a chisel, make a cut in the ground section of bearing retainer. Remove split bearing retainer.

4) Using axle bearing puller (CT-1120), remove rear wheel bearing from rear axle shaft.

Installation

To install, reverse removal procedure.

COIL SPRING & SHOCK ABSORBER

Removal

1) Raise vehicle and support body on safety stands. Place a floor jack under rear axle assembly, and raise axle assembly slightly.

2) Remove upper and lower shock absorber bolts, and remove shock absorber. Lower jack, and let axle assembly hang down. Remove coil spring.

Installation

1) Install coil springs so that spring ends contact spring stops in upper and lower spring pad.

2) Install shock absorbers, and loosely tighten bolts. Lower vehicle to floor, and tighten shock absorber attaching bolts.

LOWER ARM & UPPER CONTROL ARM

Removal

1) Raise vehicle, and support body with safety stands. Place a floor jack under rear axle assembly, and raise slightly. Remove upper control arm attaching bolts, and remove upper control arm.

2) If equipped with rear drum brakes, remove parking brake rear cable from lower arm. Remove bolts that attach lower arm to rear axle housing and to bracket attached to body. Remove lower arms.

Bushing Replacement

1) Use an arbor press to replace any damaged or deteriorated bushing in lower arms or upper control arm.

2) When new bushing is pressed into place, be sure that bushing extends out each end of arm equally.

Installation

1) Support rear axle housing with a floor jack. Install lower arms, being sure that right and left arms are installed on their proper sides.

2) Install upper control arm and attaching bolts. If equipped with drum brakes, reconnect parking brake cable to lower arm.

TIGHTENING SPECIFICATIONS

Application	Ft. Lbs. (N.m)
Bearing Retainer-to-Housing	25-36 (34-49)
Lower Arm-to-Lower Arm Bracket ...	94-108 (127-146)
Lower Arm-to-Axle Housing	
Inner Bracket	47-58 (64-79)
Outer Bracket	94-108 (127-146)
Shock Absorber Attaching Bolts	47-58 (64-79)
Upper Control Arm Bolts	94-108 (127-146)