

Steering Columns

TOYOTA COROLLA & CORONA

DESCRIPTION

Columns used on Corolla and Corona models are collapsible two-piece design. Columns use plastic shear pins to absorb collision impact. A flexible coupling connects steering shaft to steering gear.

REMOVAL & INSTALLATION

STEERING COLUMN

Removal - 1) Disconnect battery negative terminal. Remove steering wheel. See *STEERING WHEEL & COLUMN SWITCHES* in this Section. On Corona, remove fuse block cover. On both models, remove instrument panel cover (under column). On Corona, remove heater duct below column.

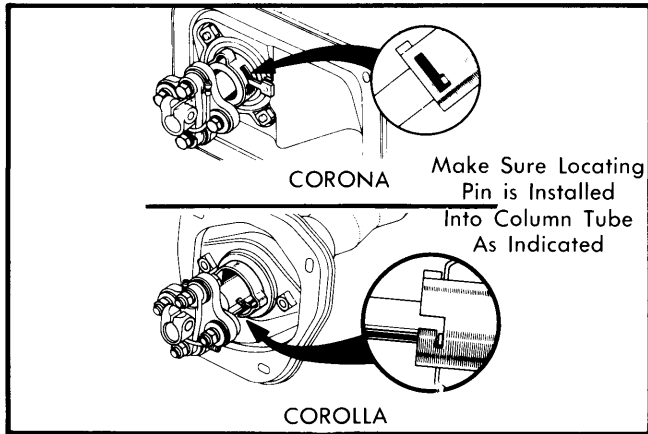

Fig. 1 Proper Installation of Steering Column Locating Pin

2) Remove upper and lower column covers, then remove combination switch. Remove flexible coupling bolt connecting steering shaft with gear (mark flexible coupling-to-gear shaft before removing). Remove column bracket bolts and floor hole cover bolts. Remove steering column from inside vehicle.

Installation - To install steering column, reverse removal procedures and note the following: make sure marks on flexible coupling and gear shaft are aligned. Make sure steering wheel is in straight ahead position when wheels are straight ahead.

OVERHAUL

STEERING COLUMN

Disassembly - Remove retainer and snap ring from upper end of steering column. Remove flexible coupling from steering shaft. Remove hole cover, ring, plate and seal from lower end of steering shaft. Pull column tube off steering shaft from upper end of shaft. Remove upper bracket from column tube.

Inspection - Check all components for damage or wear. Check steering shaft for bending damage. Check column for sheared plastic pins. Check upper bracket for proper operating lock mechanism. If necessary, upper bracket bearing can be replaced.

Reassembly - To reassemble steering column, reverse disassembly procedures. Make sure to grease steering shaft, bushings and bearings. Also make sure lock on upper bracket operates properly and steering shaft is not binding in column tube.

TIGHTENING SPECIFICATIONS

| Application | Ft. Lbs. (N·m) |
|------------------------------|----------------|
| Column Bracket (Breakaway) | |
| Corolla | 22-33 (30-45) |
| Corona | 14-22 (19-30) |
| Flexible Coupling Bolt | 15-22 (20-30) |
| Steering Wheel | 22-29 (30-40) |

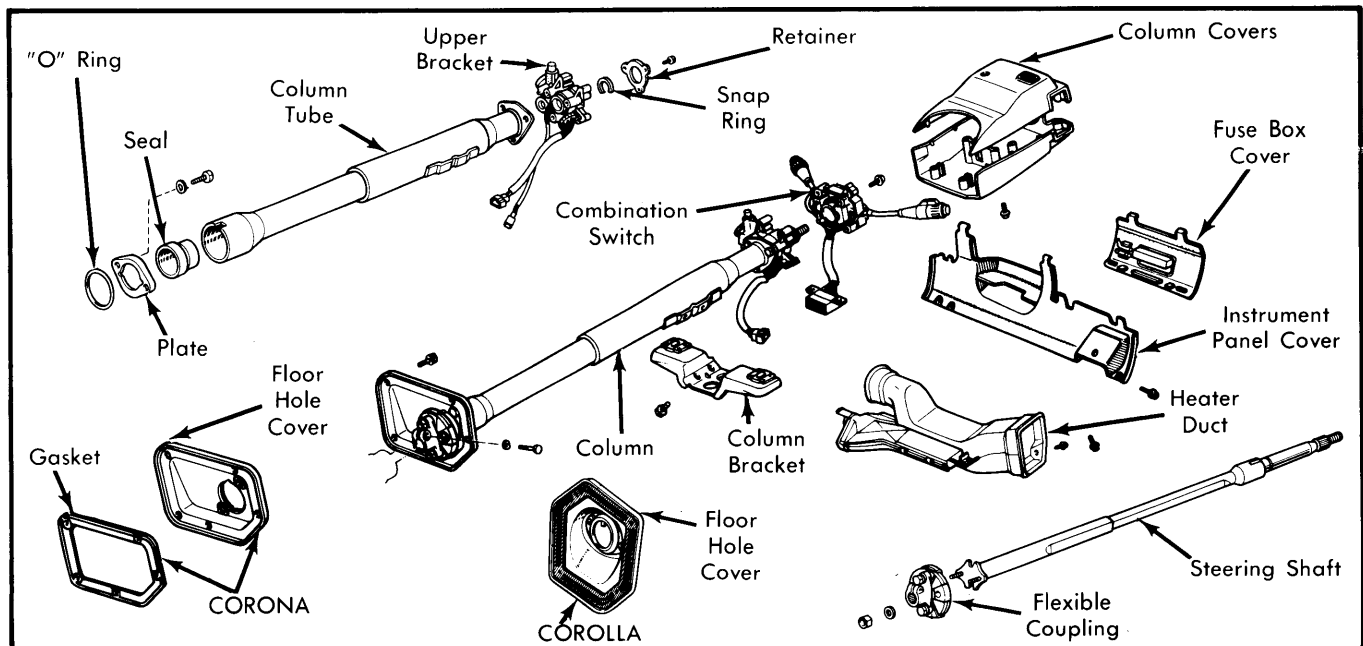

Fig. 2 Exploded View of Corolla and Corona Steering Column