

Accord  
Civic  
Prelude

## HONDA RACK & PINION

### REMOVAL & INSTALLATION

#### DESCRIPTION

Rack and pinion type steering is mounted by rubber insulators to crossmember. Adjustment is provided for pinion gear preload. Pinion shaft is coupled to the steering shaft and tie rods connect end of rack to steering arms of front wheels.

#### ADJUSTMENT

**NOTE** — Rack piston must be adjusted whenever steering gear assembly is removed and installed.

#### STEERING WHEEL TURNING FORCE

Raise and support front of vehicle, so front wheels are off ground. Attach spring gauge to steering wheel spoke, near wheel rim. Turn wheel with spring gauge and note reading. If reading is more than 3.3 lbs. (1.5 kg), adjust rack piston adjusting screw until turning force is to specifications.

#### RACK PISTON ADJUSTMENT

Loosen rack screw lock nut. Tighten rack screw until lightly bottomed then back off screw 45° from bottomed position. Tighten lock nut and recheck steering wheel turning force.

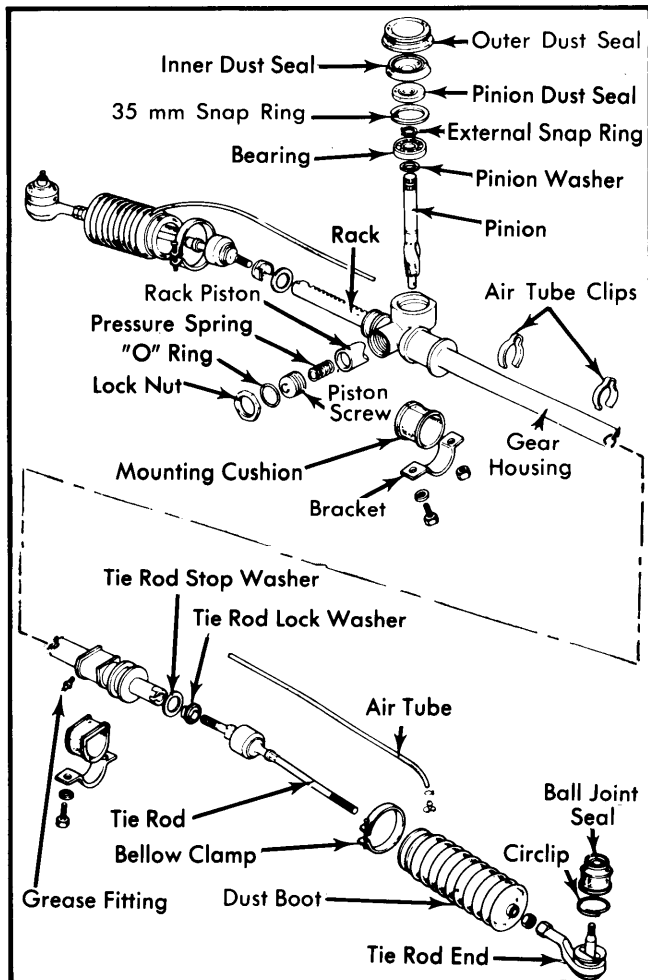

Fig. 1 Exploded View of Honda Rack & Pinion Steering Gear Assembly

#### STEERING GEAR

**Removal (Accord)** — 1) Raise and support front of vehicle. Remove front wheels. Disconnect tie rod ball joints from steering knuckles. Disconnect exhaust pipe at manifold.

2) Place Man. Trans. in 1st or 3rd and remove shift rod yoke bolt. Remove engine crossmember. Disconnect shift lever torque arm at transmission. On Auto. Trans. remove center engine mount and splash guard, then disconnect shift cable.

3) Turn steering wheel full left. Remove steering shaft connector bottom bolts, then steering gear brackets. Lower gear to disconnect steering shaft. Move gear right to clear subframe then move left to remove.

**Installation** — To install steering gear assembly, reverse removal procedures.

**Removal (Civic & Prelude)** — 1) Raise and support front of vehicle. Remove wheels. Disconnect tie rods from steering knuckles. Remove bolt from steering shaft to pinion gear connector. Remove steering gear mounting bracket bolts.

2) Lower gear to disconnect steering shaft, rotate gear 180° forward and remove gear through left side of vehicle.

**Installation** — To install steering gear, reverse removal procedures. Check operation of steering gear for smoothness and binding after installation.

### OVERHAUL

#### STEERING GEAR

**Disassembly** — 1) Place steering gear in a vise. Disconnect air tube and dust boot clamps. Push dust boots out of way, bend up lock washer tabs and remove tie rods from rack.

2) Remove rack adjusting screw lock nut, adjusting screw, washer, spring and rack piston. Remove pinion gear grommets, dust seal and snap ring, then pull pinion gear out of steering housing. Remove rack and rack bushing.

**Inspection** — Check all components for wear or damage, replace as necessary. Measure rack piston adjustment spring length, replace if not to specifications. New spring length should be 1.028" (26.1 mm) for Accord, 1.126" (28.6 mm) for Civic, and .750" (19.04 mm) for Prelude. Service limit for springs should be .945" (24 mm) for Accord, 1.035" (26.3 mm) for Civic, and .689" (17.5 mm) for Prelude.

**Reassembly** — Coat sliding surfaces with grease, then reassemble in reverse order of disassembly. Use new lock washers on tie rods and adjust steering after installation in vehicle.

#### TIGHTENING SPECIFICATIONS

| Application                    | Ft. Lbs. (mkg) |
|--------------------------------|----------------|
| Adjusting Screw Lock Nut ..... | 18 (2.5)       |
| Ball Joint Nuts .....          | 32 (4.4)       |
| Tie Rod Lock Nut .....         | 32 (4.4)       |