

Steering Columns

HONDA

Accord
Civic
Prelude

DESCRIPTION

Steering columns are mounted with an impact-absorbing plate on the upper bracket that deforms under pressure. A plastic bracket collar at the lower end of the column allows the assembly to slide, and double universal joints absorb impact without the need for a collapsing column.

REMOVAL & INSTALLATION

STEERING COLUMN

Removal (Civic & Prelude) — Disconnect steering joint at splines by removing clamp bolt. Remove wire connectors below column. Remove attaching bolts (upper bolts first) and take entire assembly out of vehicle.

Installation — To install, reverse removal procedure and ensure that front wheels are straight ahead when steering wheel is installed.

Removal (Accord) — Disconnect wire harness. Remove middle clamp bolt in universal joint shaft. Detach lower dash panel. Remove nuts securing column to mounting brackets (remove upper nuts first). Remove column from vehicle.

NOTE — If steering wheel has been removed, ignition switch must be in "LOCK" position to retain steering shaft during column removal.

Installation — 1) Insert column in vehicle and loosely connect universal joint shaft. Pull down on column to ensure bending plate is against hook, then tighten bracket nuts. Check plastic

collar to ensure it is all the way on column, then install lower column bracket.

2) On models with manual steering, tighten universal joint clamp bolt. On power steering models, install special tool (07973-6710000) on top of steering shaft. Pull down on universal joint shaft until legs on special tool are seated against turn signal switch body, then tighten bolt.

OVERHAUL

Disassembly — 1) Remove steering wheel and column switches. See *Honda* under **STEERING WHEEL & COLUMN SWITCHES** in this Section.

2) Remove rubber bands, bending plate and upper mounting plate. On Civic and Prelude models, remove snap ring and steering shaft washer from upper end of steering shaft. Turn ignition switch to "I" position on Prelude or "ACC" position on Civic.

3) On all models, remove plastic collar, shaft bushing and column hanger bushing. Pull steering shaft out from bottom end of column. Remove thrust ring, bushing and horn ring from top end of column.

4) On Accord models with power steering, remove rubber stop, plastic collar, washer, spring, washer and snap ring before pulling steering shaft out of bottom end of steering column.

Reassembly — 1) Install horn ground ring, serrated bushing and thrust ring in steering column. Flat sides of thrust ring should be aligned with slots in steering column.

2) Grease top end of steering shaft and carefully insert in column. Be careful not to bend horn ground ring. Fill bottom of

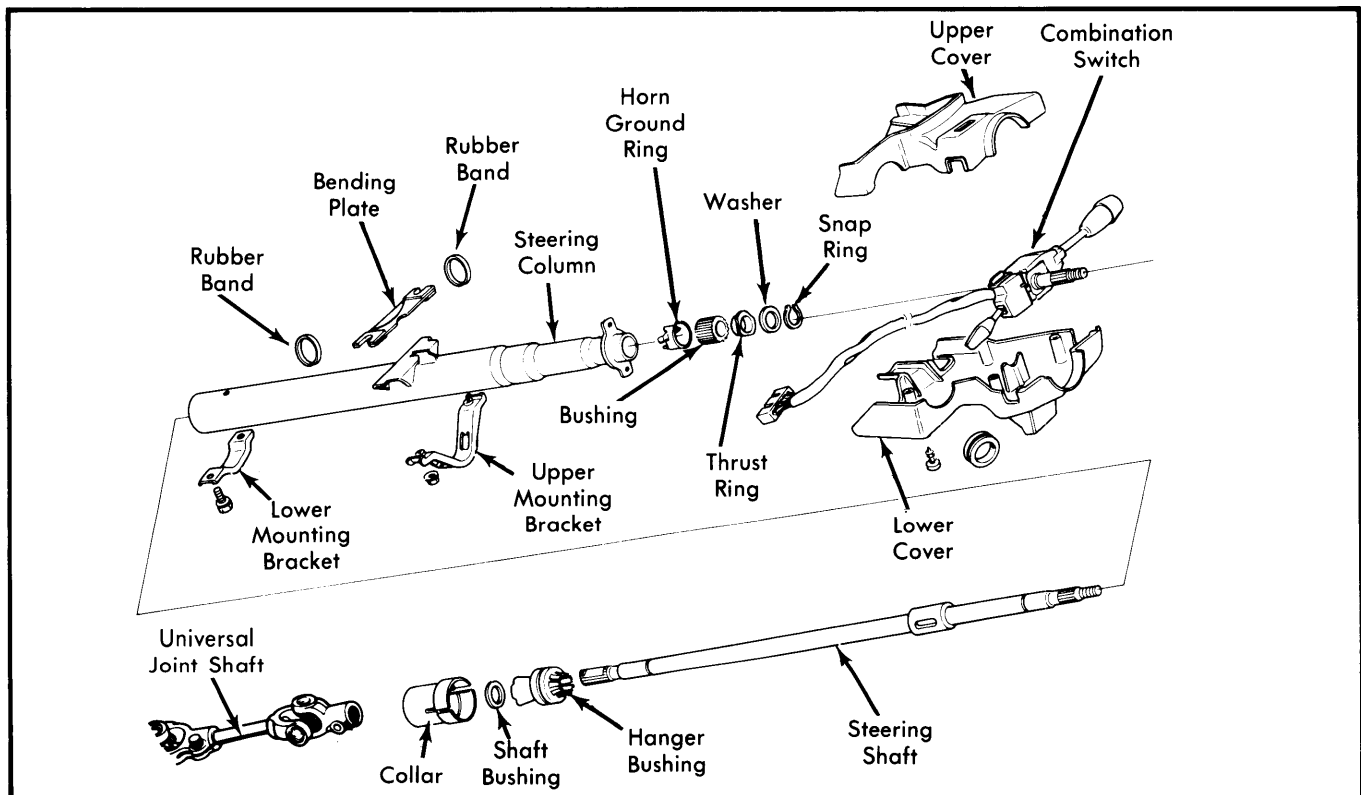

Fig. 1 Exploded View of Civic and Prelude Steering Column

HONDA (Cont.)

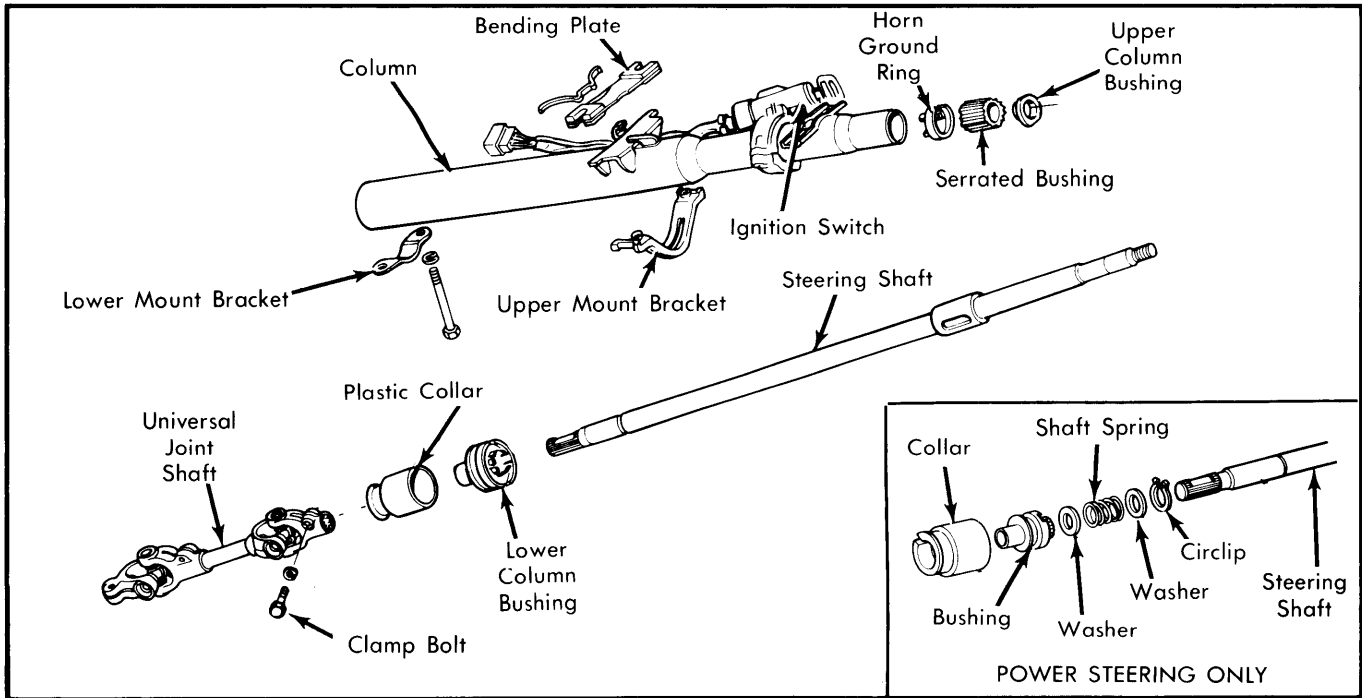

Fig. 2 Exploded View of Accord Steering Column

column with grease and install plastic hanger bushing. Align tab in column with cut-away in bushing. On Accord models with power steering, install snap ring, washer, spring and washer before installing plastic hanger bushing.

3) On all models, install plastic collar to bottom of column, align round projection on inside of collar with hole in column. On Accord models with power steering, install rubber stop. On Civic and Prelude models, install snap ring to top end of steering shaft. On Accord models, attach connector shaft universal joint to steering shaft so clamp bolt rests at bottom of machined flat of steering shaft. Tighten clamp bolt.

NOTE — On Accord models, place ignition switch in the "O" position to prevent shaft from sliding out during installation.

4) Install column switches. Use rubber bands to assemble upper bracket and bending plate to steering column. Bending plate should fit under hook on column with arrow mark facing out and pointing down. Install upper and lower covers.

TIGHTENING SPECIFICATIONS

Application	Ft. Lbs. (mkg)
Column Bracket Bolts	
Upper	9 (1.3)
Lower	16 (2.2)
Universal Clamp Bolts	22 (3.0)