

# Steering Column

## AUDI 4000

### DESCRIPTION

The Audi 4000 uses a 2 piece safety steering column with a slip joint flange connection. Steering column is supported by the column tube and steering lock assembly.

### REMOVAL & INSTALLATION

#### STEERING COLUMN

**Removal** – 1) Disconnect battery ground strap. Remove steering wheel and column switches. See *Audi 4000 under STEERING WHEELS & COLUMN SWITCHES* in this Section.

2) From under hood, remove clamp bolt attaching steering shaft clamp to steering gear pinion shaft. Remove column cover bolts and then upper and lower steering column covers. See *Fig. 1*.

3) Pry lock washer off of steering shaft and remove spring. Remove contact ring, then remove steering lock assembly. Remove support ring from column tube. See *Fig. 1*. Center punch shear bolt attaching column tube to dash. Drill out shear bolt, then remove socket head screw attaching column tube to dash.

4) From inside vehicle, force dust boot out of floor boards. Remove steering column tube and shaft as an assembly.

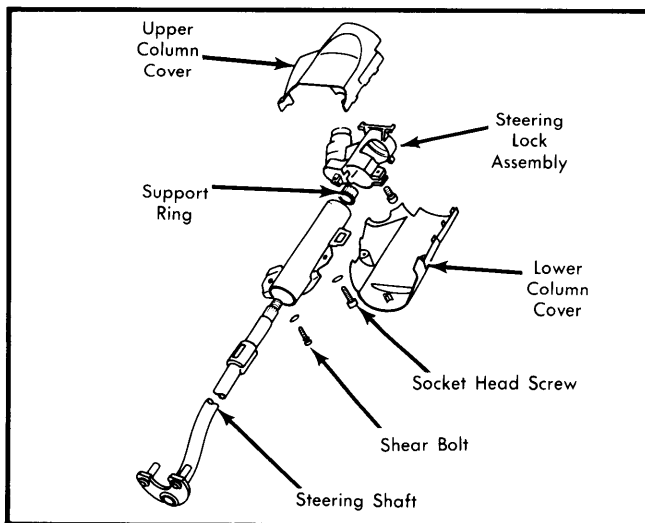

**Fig. 1 Exploded View of Audi 4000 Upper Steering Column**

**Installation** – 1) Install assembled steering column into vehicle. Install shear bolt and socket head bolt finger tight. Push dust boot into floor boards until seated. Place clamp onto steering gear pinion shaft. Place support ring into column tube.

2) Install steering lock assembly to steering column, then install contact ring, spring and a new lock washer. Tighten socket head screw. Tighten shear bolt until head snaps off.

3) Install upper and lower column covers, then install column switches and steering wheel. See *Audi 4000 under STEERING WHEELS & COLUMN SWITCHES* in this Section.

### OVERHAUL

**Disassembly** – 1) On lower steering shaft, remove clamp bolt attaching lower flange tube to upper flange tube. Separate flange tubes and remove bearing flange, bearing, support ring, spring and washer. See *Fig. 2*.

2) Push upper flange tube towards steering shaft until components can be separated. Remove flange tube bushings with plastic bushings. See *Fig. 2*.

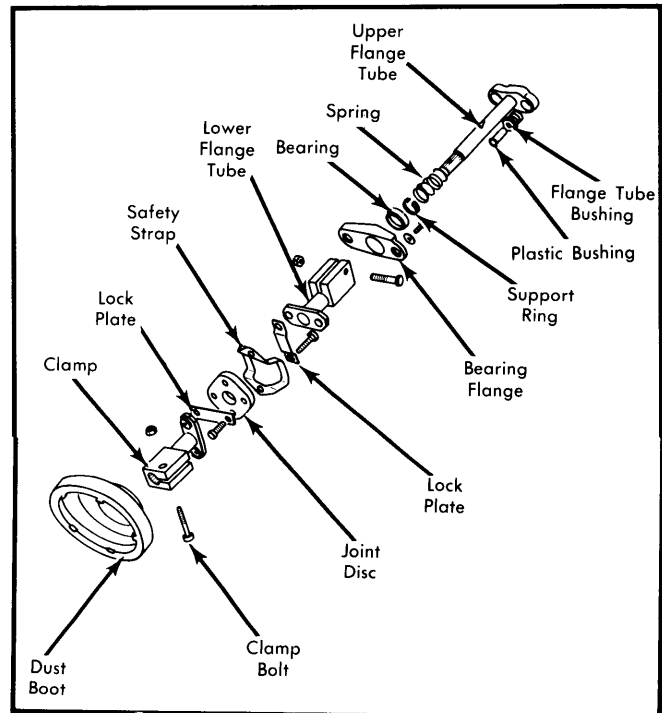

**Fig. 2 Exploded View of Audi 4000 Lower Steering Column**

3) Remove lower flange tube-to-clamp bolts; then separate lower flange tube from clamp. Inspect joint disc, safety strap and lock plates for damage or wear.

4) On steering shaft, slide column tube off of steering shaft. Inspect steering shaft, support ring and steering lock assembly for wear or damage. Replace components as necessary. See *Fig. 1*.

**Reassembly** – To reassemble steering column, reverse disassembly procedures. Press flange tube bushing and plastic bushing in by hand.

### TIGHTENING SPECIFICATIONS

Application	Ft. Lbs. (mkg)
Steering Wheel Nut .....	29 (4.0)
Socket Head Screw .....	14 (1.9)
Clamp Bolt .....	22 (3.0)
Lower Flange Tube Bolt .....	22 (3.0)
Lock Plate Bolts .....	18 (2.5)