

RENAULT

Le Car

DESCRIPTION

Vehicles are equipped with an energy-absorbing collapsible column. The steering column is designed in two separate sections, which are joined by a universal joint. The upper portion of the column is designed with a sliding section which compresses on vehicle impact. At the lower end of the bottom section, the steering column is connected to the pinion flange of the steering gear through a flexible rubber coupling.

REMOVAL & INSTALLATION

STEERING COLUMN

Removal — 1) Disconnect battery and unclip speedometer cable in engine compartment. Remove instrument cluster cowl. Pry clips on sides of cluster inward and pull cluster forward. Disconnect wiring and speedometer cable, then remove cluster.

2) Remove steering wheel pad and steering wheel. Detach lower column cover, remove screws and lift off combination switch from column. Disconnect wiring from switch. Remove fuse box screws and place box to one side. Disconnect universal joint.

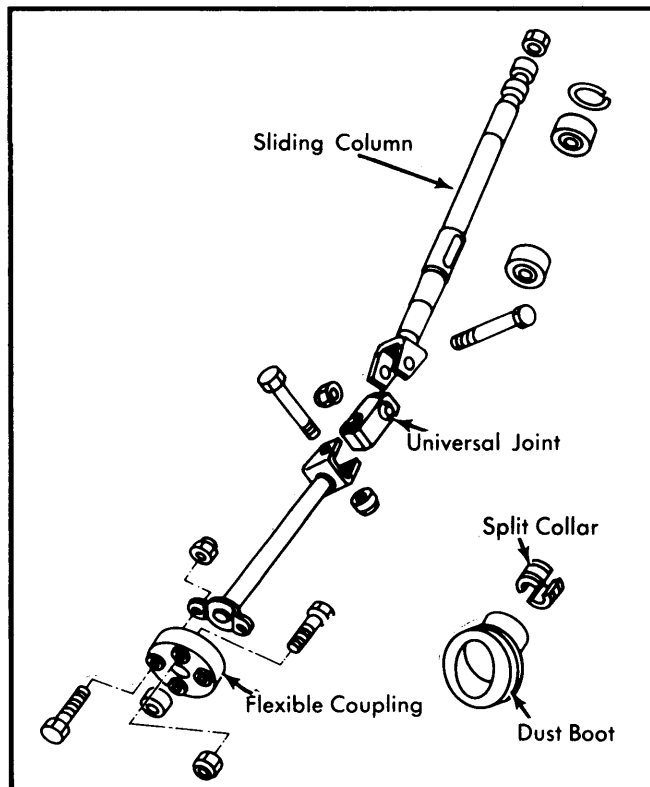

Fig. 1 Renault Steering Column with Related Components

3) Mark column clamp position, remove shaft flexible coupling at steering box, and remove clamps from column tube. Pull column assembly free from dashboard.

Installation — 1) To install, reverse removal procedures, noting the following: Tighten upper column clamp at the end of installation. Set gear at center position before connecting universal joint in the following manner:

2) Raise front end of vehicle. Set steering box at center point. Tighten bottom joint pin. Turn steering $\frac{1}{4}$ turn to left or right, then tighten upper universal joint pin.

3) Reconnect all wiring, tighten bolts securely and check shaft for binding or rubbing.

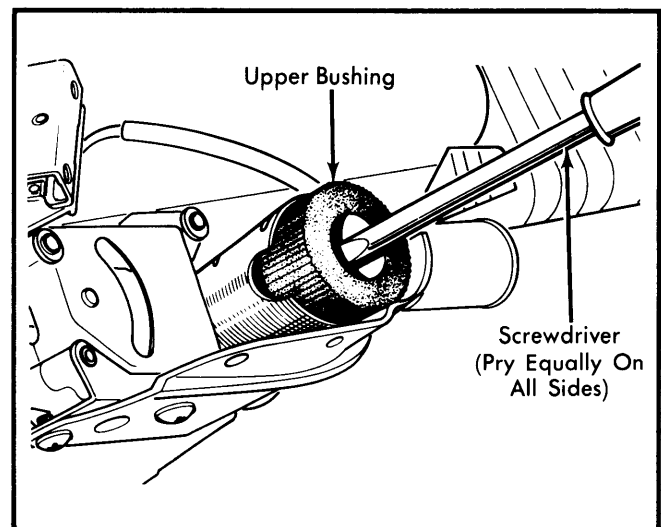

Fig. 2 Removing Upper Column Bushing

OVERHAUL

REPLACING COLUMN BUSHINGS

Disassembly — Tap upper end of steering shaft until lower bushing comes out of column tube. Remove snap ring from top of column tube and carefully pry out bushing with screwdriver.

Assembly — 1) Coat new bushings with suitable grease. Position lower split bushing on steering shaft and fit an old bushing below it which has been turned down .079" (2 mm) in diameter.

2) Insert lower bushing by pulling steering shaft upward, then push it back slightly to recover used bushing. Using a suitable sleeve, replace upper bushing. Insert snap ring and install column in vehicle.