

FIESTA

DESCRIPTION

Steering column is two-piece, with a slip joint that allows either part to move without transmitting force to the other end. A steering column jacket over the upper part of the steering shaft will also collapse under impact. No universal joints or flexible couplings are used between the shaft and steering gear.

REMOVAL & INSTALLATION

STEERING COLUMN

Removal - 1) Disconnect battery ground strap. Remove pinion-to-steering shaft clamp bolt. Inside vehicle, remove upper and lower steering column shrouds and lower dash insulation panel.

2) Loosen two screws retaining switch assembly to column and unplug wiring connectors. Remove column mounting bolts and nuts. Carefully remove column and shaft assembly from vehicle.

3) Remove steering wheel from assembly. Remove directional signals cam and bearing tolerance ring from shaft. Lift off column tube, remove washers and spring, then disconnect halves of shaft.

Installation - 1) Assemble upper and lower shafts, replace washers and spring, then insert shaft into column. Position bearing tolerance ring and directional signals cam, then install steering wheel.

2) Place column assembly in vehicle, with lower shaft loosely over pinion shaft. Secure column in place with supporting nuts and bolts. Reconnect ignition and replace column switches and wiring.

3) Ensure pins on lower shaft are fully engaged in upper shaft bushings. Tighten clamp bolt after checking steering wheel position. Replace column shrouds and dash insulation cover. Reconnect battery. Column upper shroud-to-instrument panel clearance should be .28" (7.0 mm). Adjust as necessary.

TIGHTENING SPECIFICATIONS

| Application | Ft. Lbs. (mkg) |
|---|-----------------|
| Steering Wheel Nut | 30-37 (4.1-5.1) |
| Column-to-Pinion Shaft Clamp Bolt | 33-41 (4.6-5.7) |

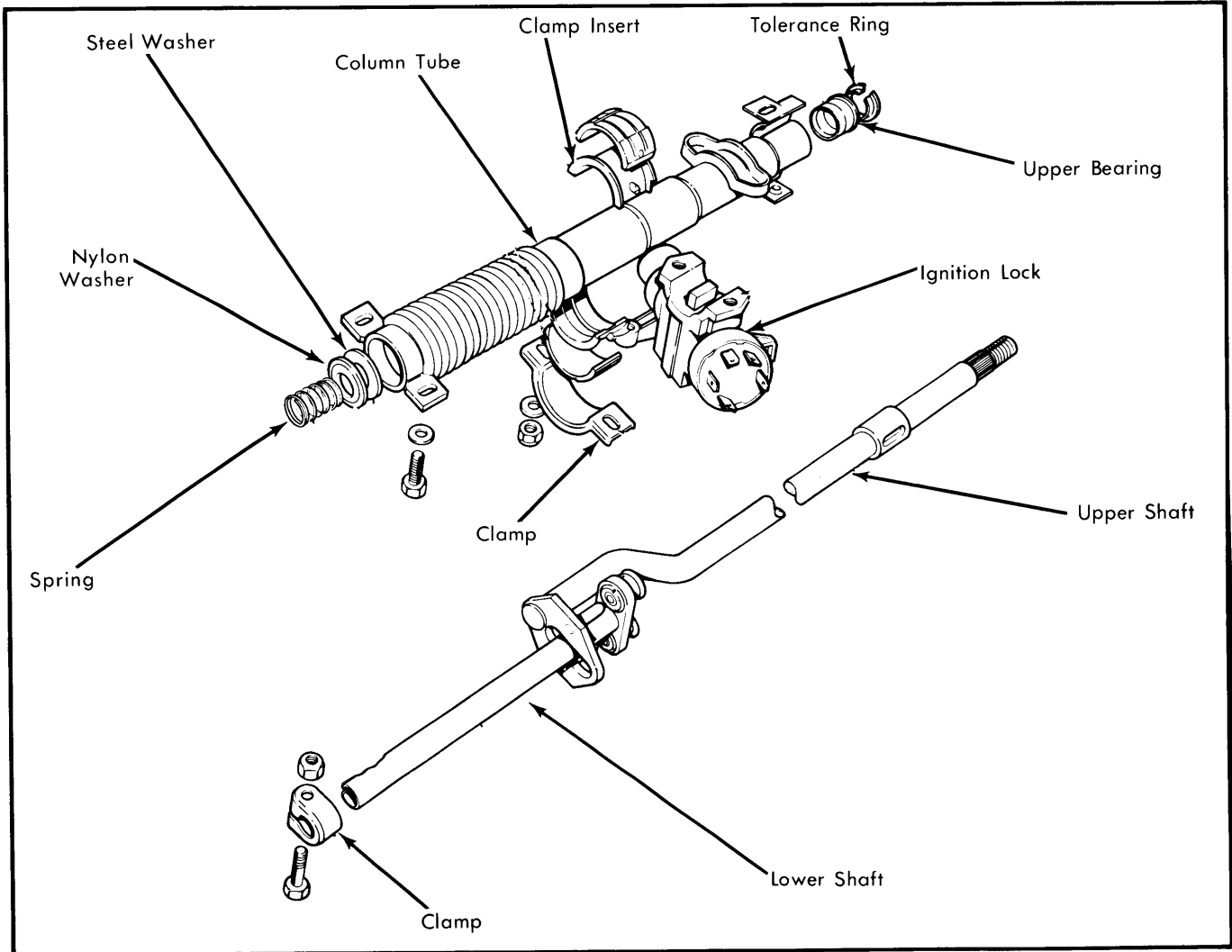

Fig. 1 Exploded View of Fiesta Steering Column Assembly