

## AUDI FOX

Fox

## DESCRIPTION

Brake system is hydraulically operated, utilizing a tandem master cylinder and a Teves power brake unit. Front disc brakes consist of rotors attached to wheel hubs, and single piston floating caliper assemblies attached to steering knuckles. The disc brake pads are equipped with wear indicators that create a pulsation in the brake pedal when the pads are worn. Rear brakes are leading-trailing shoe/drum type, using a dual piston wheel cylinder. Parking brake is cable actuated, operating secondary shoes of rear brake assemblies.

## ADJUSTMENT

## FRONT DISC BRAKE PADS

Front disc brakes are self-adjusting, therefore, no adjustment in service is required.

## REAR DRUM BRAKE SHOES

Raise and support rear of vehicle, release parking brake. Use a brake spoon, tighten rear star adjuster until wheel can no longer be turned by hand. Loosen star until wheels are just free to turn.

## PARKING BRAKE

With rear brake shoes properly adjusted, pull parking brake handle to second notch. Tighten parking brake adjusting nut until rear wheels can just be turned by hand, then tighten lock nut. Release handle and ensure both rear wheels rotate freely.

## HYDRAULIC SYSTEM BLEEDING

Fill master cylinder reservoir with brake fluid and maintain level throughout bleeding operation. Attach a hose to bleeder screw, and immerse opposite end in a container partially full of brake fluid. Open bleeder screw approximately one-half turn, depress brake pedal, close bleeder screw, and slowly return pedal. Continue operation until air bubbles are no longer seen in discharged fluid. Bleeding sequence is right-rear, left-rear, right-front, left-front.

## REMOVAL &amp; INSTALLATION

## FRONT DISC BRAKE PADS

**Removal** — Raise and support front of vehicle and remove wheel and tire assembly. Pull spring locks out of retaining pins, drive retaining pins out toward outside of vehicle, and remove cross spring. Using a suitable tool (P 86), remove inboard brake pad. Pull mounting frame and brake cylinder outwards until outboard pad can be removed.

**Installation** — Press piston to bottom of travel in cylinder and floating frame. **NOTE** — *Level in master cylinder reservoir will rise. Siphon off sufficient fluid to prevent overflowing.* Ensure machined portion of piston face makes a 20° angle to lower caliper wall. Install disc pads by reversing removal procedure.

## FRONT DISC BRAKE CALIPER

**Removal** — With wheel and tire assembly and disc brake pads removed, disconnect hydraulic line from caliper. Remove bolts securing caliper to steering knuckle and remove caliper.

**Installation** — Reverse removal procedure and bleed hydraulic system.

## FRONT DISC BRAKE ROTOR

**Removal** — With wheel and tire assembly removed, remove caliper. **NOTE** — *Do not disconnect hydraulic line unless necessary.* Remove screw securing rotor to wheel hub and withdraw rotor.

**Installation** — Reverse removal procedure and bleed hydraulic system if necessary.

## REAR BRAKE DRUM

**Removal** — Pry off grease cap. Remove cotter pin, castle nut, hex nut, and washer. Pull off brake drum making sure that inner race of outer bearing is not lost.

**Installation** — Reverse removal procedure, adjust brake shoes, and adjust wheel bearings. See *Wheel Bearing Adjustment* in **WHEEL ALIGNMENT** Section.

## REAR BRAKE SHOES

**Removal** — With brake drum removed, disconnect lower spring by removing from primary shoe. Remove shoe vibration cups, springs, and pins. Remove primary shoe from backing plate, disconnect parking brake cable from lever, and remove secondary shoe and parking brake lever assembly.

**Installation** — Reverse removal procedure and note the following: Before installing secondary brake shoe, make sure that rear wheel cylinder piston is positioned so that web faces outward and opening inward. Adjust brakes and bleed hydraulic system if necessary.

## REAR BRAKE WHEEL CYLINDER

**Removal** — Depress brake pedal approximately 1.2" to close compensator bore in master cylinder, and hold in position using a suitable pedal support. Disconnect hydraulic line from cylinder and plug with rubber cap from bleeder screw. Remove bolts attaching wheel cylinder to backing plate. Remove cylinder by maneuvering out of backing plate.

**Installation** — Reverse removal procedure and note the following: Make sure that rear piston is installed in wheel cylinder so that web faces outward and opening inward. Bleed hydraulic system.

## MASTER CYLINDER

**Removal** — Siphon brake fluid from master cylinder reservoir. Disconnect hydraulic lines at cylinder, remove nuts attaching master cylinder to power unit, and remove master cylinder.

**Installation** — Reverse removal procedure and note the following: Make sure "O" ring is installed between master cylinder and power unit. After installing master cylinder, bleed hydraulic system.

## OVERHAUL

## FRONT DISC BRAKE CALIPER

**Disassembly** — Remove disc pads and pry mounting frame and piston assembly off floating frame. Remove brake cylinder and guide spring from floating frame. Remove clamp and dust cap from brake cylinder, then withdraw piston. **NOTE** — *If necessary, apply compressed air to fluid inlet.* Remove seal from cylinder.

## AUDI FOX (Cont.)

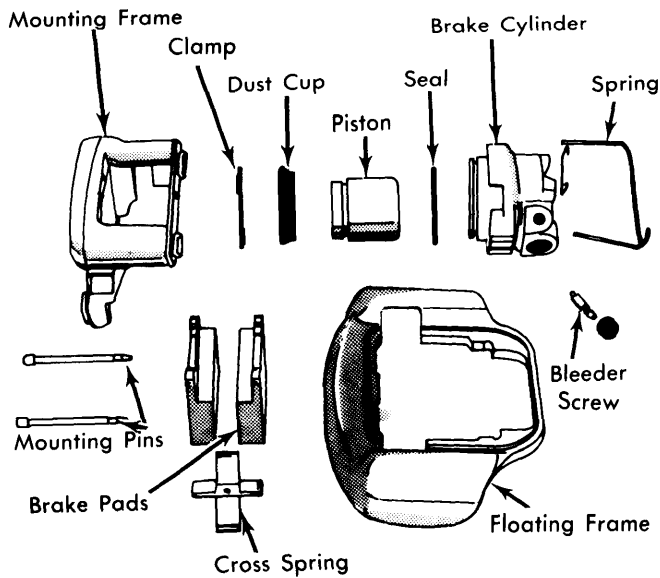

Fig. 1 Audi Fox Disc Brake Caliper Assembly

**Cleaning & Inspection** – Thoroughly clean all parts in alcohol. Check all parts for rust, corrosion, or other damage; replace parts as necessary. **NOTE** – Manufacturer recommends replacing rubber parts whenever caliper has been disassembled.

**Reassembly** – Apply a thin coat of ATE brake cylinder paste (or equivalent) to cylinder, piston and seal, and reassemble. Place guide spring in groove of brake cylinder, then drive cylinder on floating frame with a brass mandrel. Place mounting frame in guide spring, then slide it on floating frame.

### REAR BRAKE WHEEL CYLINDER

**Disassembly** – Remove rubber dust caps, then withdraw front and rear piston and seal assemblies. Remove seals from pistons. Remove bleeder screw and dust cap.

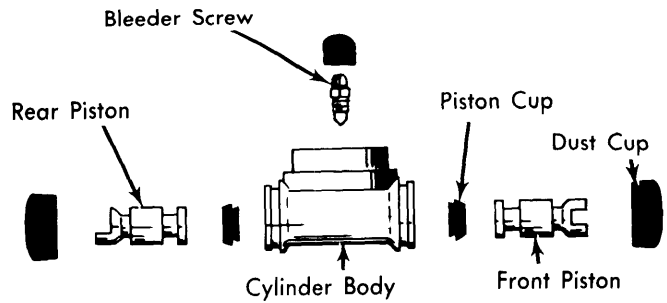

Fig. 2 Exploded View of Rear Wheel Cylinder

**Cleaning & Inspection** – Thoroughly clean all components in alcohol. Inspect cylinder and pistons for rust, corrosion, or scoring; replace parts as necessary. **NOTE** – Manufacturer recommends replacing all rubber parts whenever cylinder has been disassembled.

**Reassembly** – Reverse disassembly procedure and note the following: Pistons are not interchangeable. Install notched piston in front of cylinder so that it will engage primary shoe when installed on backing plate.

### MASTER CYLINDER

**Disassembly** – Remove "O" ring from master cylinder housing. Remove retaining ring and loosen piston stop screw, then remove both pistons from housing. Remove pressure valves and reservoir from master cylinder housing. Disassemble piston assemblies as necessary.

**Cleaning & Inspection** – Clean all parts in alcohol and check for rust, corrosion, or other damage; replace parts as necessary. Make sure compensating and filler holes are not plugged.

**Reassembly** – Reverse disassembly procedure and note the following: Make sure pressure and intermediate piston cups are installed correctly (See Fig. 3). Use new "O" ring on master cylinder between cylinder and power unit.

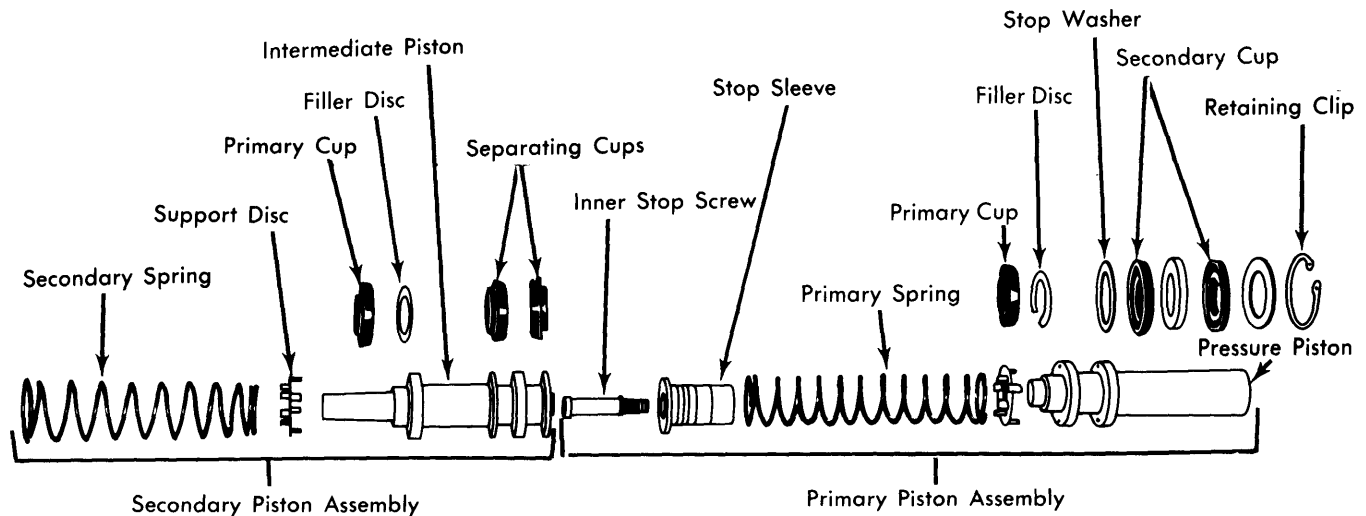

Fig. 3 Master Cylinder Piston Assembly

## AUDI FOX (Cont.)

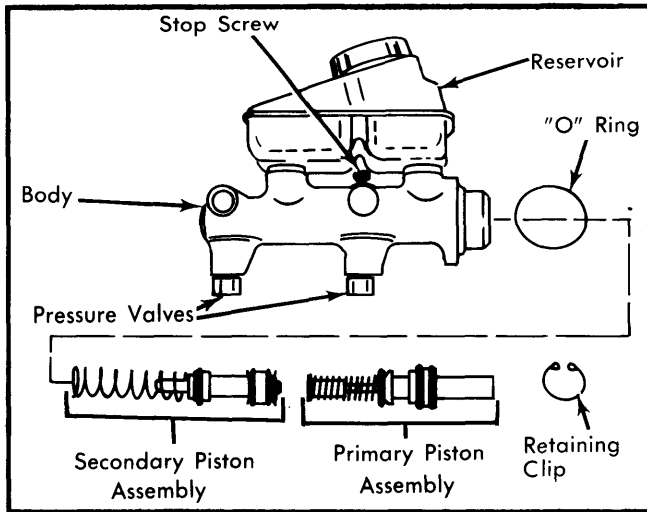

Fig. 4 Master Cylinder Reservoir, Body and Piston Assemblies

### POWER BRAKE UNIT

**NOTE** — Manufacturer does not recommend overhaul of power brake unit. Assembly is serviced by replacement only.

### TIGHTENING SPECIFICATIONS

Application	Ft. Lbs. (mkg)
Power Unit-to-Adapter .....	14 (2)
Adapter-to-Firewall .....	14 (2)
Caliper-to-Steering Knuckle .....	43 (6)
Splash Guard-to-Steering Knuckle .....	7 (1)
Rotor-to-Hub Screw .....	5 (.7)
Hydraulic Line-to-Master Cylinder .....	7 (1)
Hydraulic Line-to-Caliper .....	9 (1.2)
Hydraulic Line-to-Wheel Cylinder .....	9 (1.2)

### BRAKE SYSTEM SPECIFICATIONS

Application	Drum Diam. In. (mm)	Wheel Cylinder Diameter		Master Cylinder
		Front In. (mm)	Rear In. (mm)	Diameter In. (mm)
Fox	7.87 (200)	1.73 <sup>Ⓢ</sup> (44)	.....	.813 (20.6)

<sup>Ⓢ</sup> — Front disc brake cylinder.

### DISC BRAKE ROTOR SPECIFICATIONS

Application	Disc Diameter In. (mm)	Lateral Runout In. (mm)	Parallelism In. (mm)	Original Thickness In. (mm)	Minimum Refinish Thickness In. (mm)	Discard Thickness In. (mm)
Fox (Front)	9.41 (2.4)	.0023 (.06)	.0008 (.02)	.470 (12)	.430 (11)	.410 (10.5)

### BRAKE DRUM SPECIFICATIONS

Application	Drum Diameter In. (mm)	Original Diameter In. (mm)	Maximum Refinish Diameter In. (mm)	Discard Diameter In. (mm)
Fox (Rear)	7.87 (200)	7.87 (200)	7.89 (200.5)	7.91 (201)