

MG MIDGET

Midget

DESCRIPTION

Suspension is a control arm coil spring type. Shock absorber is a lever arm type and acts as upper control arm. Shock absorber is bolted to crossmember and attached to steering knuckle. Lower control arm is attached to frame and steering knuckle with fulcrum shafts. A coil spring is mounted between lower control arm and crossmember.

ADJUSTMENT

WHEEL ALIGNMENT SPECIFICATIONS & PROCEDURES

See *Wheel Alignment Specifications & Procedures* in *WHEEL ALIGNMENT* Section.

WHEEL BEARING ADJUSTMENT

See *Wheel Bearing Adjustment* in *WHEEL ALIGNMENT* Section.

REMOVAL & INSTALLATION

COIL SPRINGS

Removal & Installation – Place a wood block under shock absorber lever arm rubber stop. Raise and support vehicle on jack stands, remove wheels. Using suitable spring compressor (18G 153), compress spring. Remove nuts and bolts securing spring seat to lower control arm. Release spring compressor and remove spring. To install, reverse removal procedure.

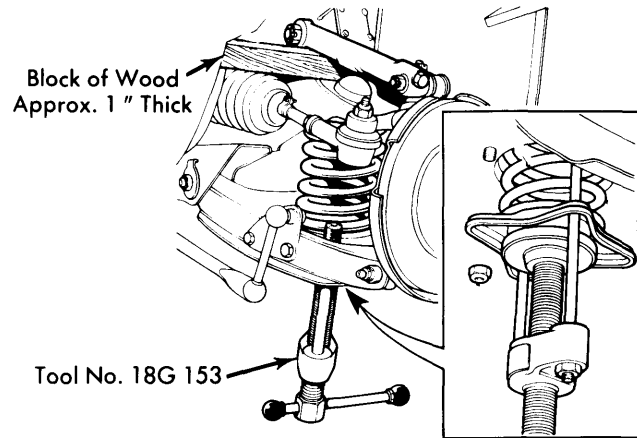

Fig. 1 View Showing Detail of Front Spring Removal

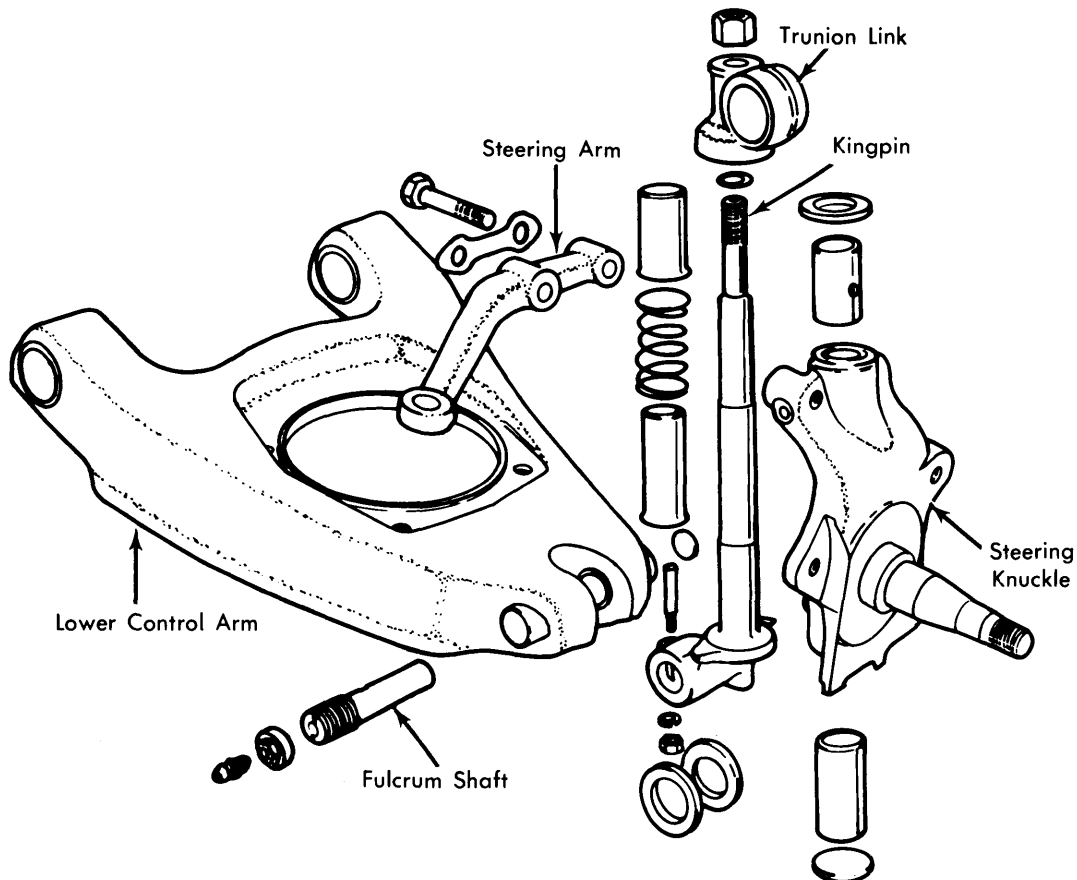

Fig. 2 Exploded View of Front Suspension Components

MG MIDGET (Cont.)

FRONT SUSPENSION ASSEMBLY

Removal & Installation — Raise and support vehicle on safety stands, remove wheels. Remove coil spring as previously outlined. Disconnect steering lever from steering link. Disconnect and plug brake hose at body connection. Remove cotter pin and nuts on lower control arm inner fulcrum shaft, remove shaft. Remove clamp bolt and washer from shock absorber lever arm. Remove cotter pin and slotted nut from fulcrum pin, withdraw fulcrum pin. Remove suspension assembly after removing nuts and bolts holding sway bar link bracket to suspension lower link. To install, reverse removal procedure.

Disassembly & Reassembly — Remove hub assembly and backing plate. Remove cotter pin and nut from top of king pin. Remove thrust washer, steering knuckle, dust tubes, dust tube spring, and seal from king pin. Remove grease fitting, plug, and fulcrum shaft. To reassemble, reverse disassembly procedure.

SHOCK ABSORBERS

Removal & Installation — Raise and support vehicle on jack stands, remove wheels. Place jack under outer end of control arm and raise until shock lever arm is off its rubber stop. Remove nut and bolt from fulcrum shaft and remove shaft. Remove bolts securing shock absorber to frame. Remove shock absorber. Jack must remain under lower control arm while shock absorber is removed from vehicle. To install, reverse removal procedure; tighten bolts securing shock absorber-to-frame to 25-30 ft. lbs. (3.5-4.2 mkg).

SWAY BAR

Removal — Raise front of vehicle and place jack stands under front suspension. Remove screws and nuts to release end stops from sway bar. Remove bolts mounting sway bar rubber bushing bracket. Remove nuts mounting sway bar links and remove from vehicle.

Installation — To install, reverse removal procedure and tighten all mounting hardware.