

Steering Columns

OPEL

Manta
1900

DESCRIPTION

Steering column is an energy-absorbing unit. The mast jacket is provided with a tube frame section. Column consists of two parts, the upper and lower mast jacket assembly and the steering shaft. Upper steering mast is firmly attached to tube, while lower mast is clearance-free and attached to tube by means of injected plastic. A slide-off base is welded to mast jacket. A metal piece is located in each bolt slot and attached to slide-off base with injected plastic. This slide-off base is designed to absorb forward energy of driver into the steering wheel.

REMOVAL & INSTALLATION

CAUTION — Do not exert any blows or heavy impact on steering column at any time, or plastic inserts may be disturbed. If plastic injections are broken, replacement of entire column assembly is required. It is also important that only original equipment grade attaching pieces be used to ensure the energy absorbing quality of the column will remain intact.

STEERING COLUMN

Removal — Disconnect battery. From underside of vehicle, remove clamp screw of upper steering mast from "U" joint flange. Remove hex nut from mast jacket attachment at front of dash. Pull off signal switch and steering/ignition lock wire couplers. Unscrew slide-off base from underside of instrument panel and remove column assembly from vehicle.

Installation — First, make sure that steering wheel center spoke is straight down and that steering gear is in high point position (front wheels straight ahead). Carefully position column assembly in vehicle and loosely attach slide-off base to instrument panel. Secure mast jacket to front of dash, using a notched hex nut. Complete the tightening of slide-off base clamp and tighten steering mast clamp as required. Reconnect wires for directional signal switch and ignition switch. Reconnect battery.

TIGHTENING SPECIFICATIONS

Application	Ft. Lbs. (mkg)
Flexible Coupling	22 (3.04)
Slide-Off Base	10 (1.38)
Mast Jacket Clamp	
Nut	11 (1.52)
Screw	22 (3.04)

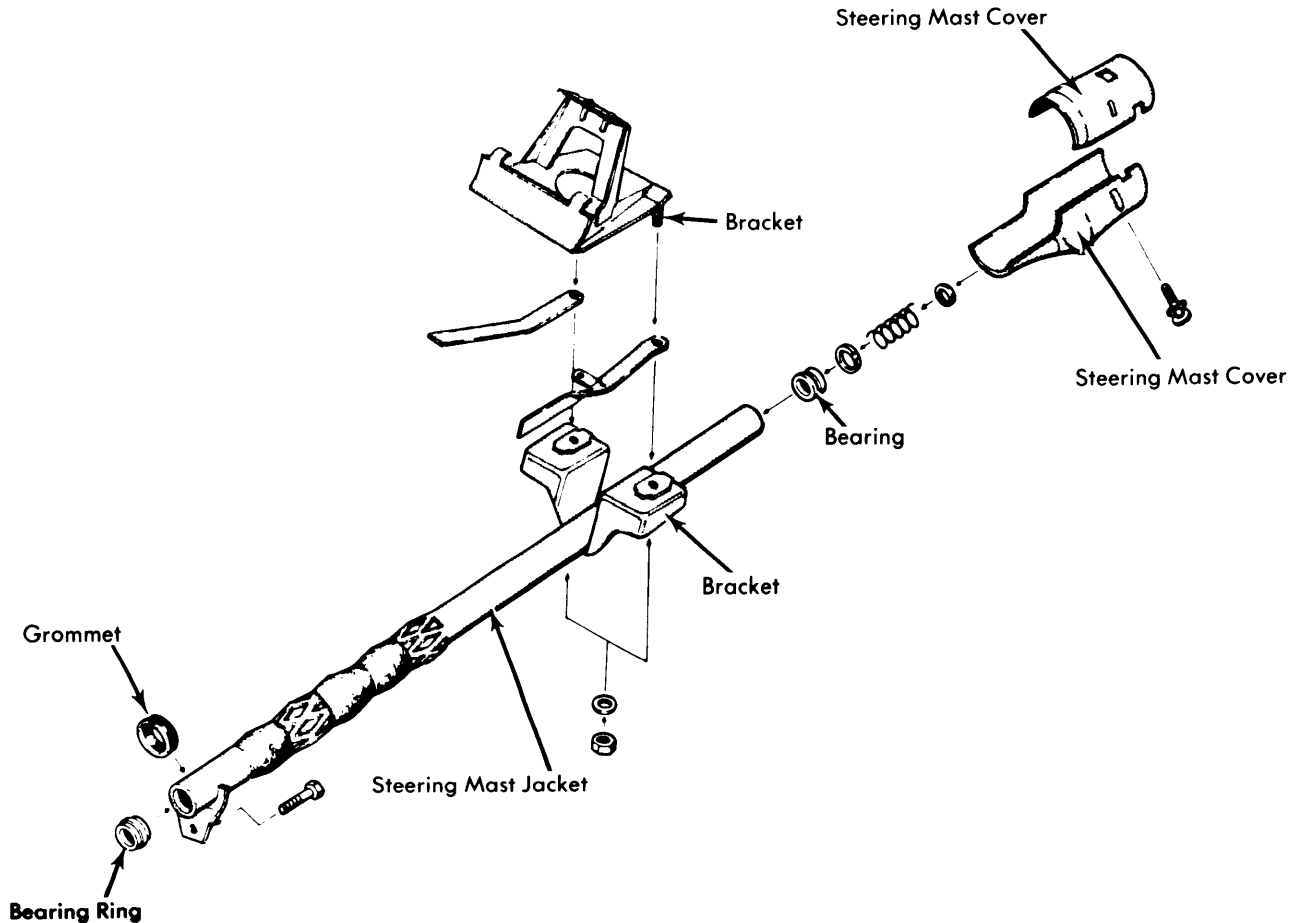

Fig. 1 Exploded View of Opel Steering Column Assembly