

Steering Columns

AUSTIN MARINA

Austin Marina

REMOVAL & INSTALLATION

UPPER STEERING COLUMN

Removal — 1) Disconnect battery ground. Remove steering wheel as previously outlined. Disconnect cowl lighting electrical lead at harness. Take off steering column cowl. Loosen screw mounting combined control switches, then disconnect electrical leads and remove connectors.

2) Disconnect ignition switch electrical leads at harness connector. Remove mounting hardware keeping upper column to flexible coupling. Take out bolts mounting steering column to firewall (bulkhead), then withdraw upper steering column through fascia panel.

Installation — 1) Engage steering column lock. Centralize steering rack by inserting a 1/4" rod into hole provided and aligning hole and indent in shaft.

2) To install remaining components, reverse removal procedure and note the following: Torque column mounting bolts to 14-18 ft. lbs. (2.0-2.5 mkg). If new coupling has been installed, break band compressing coupling and remove band.

UPPER BUSHING

Removal and Installation — Remove steering wheel. Detach and remove combined switches mechanism. Position suitable bushing removal tool (18G 1191) and pull bushing from column. To install, align slots in bushing with depression in outer column and ensure that chamfered end of bushing enters column first.

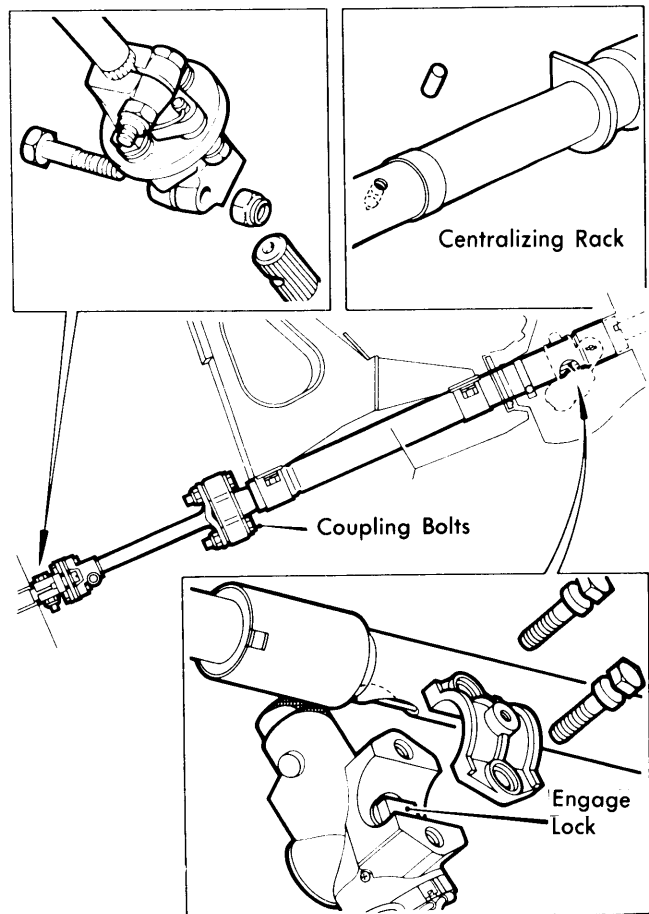

Fig. 1 Upper Steering Column Components Showing Detail for Removal

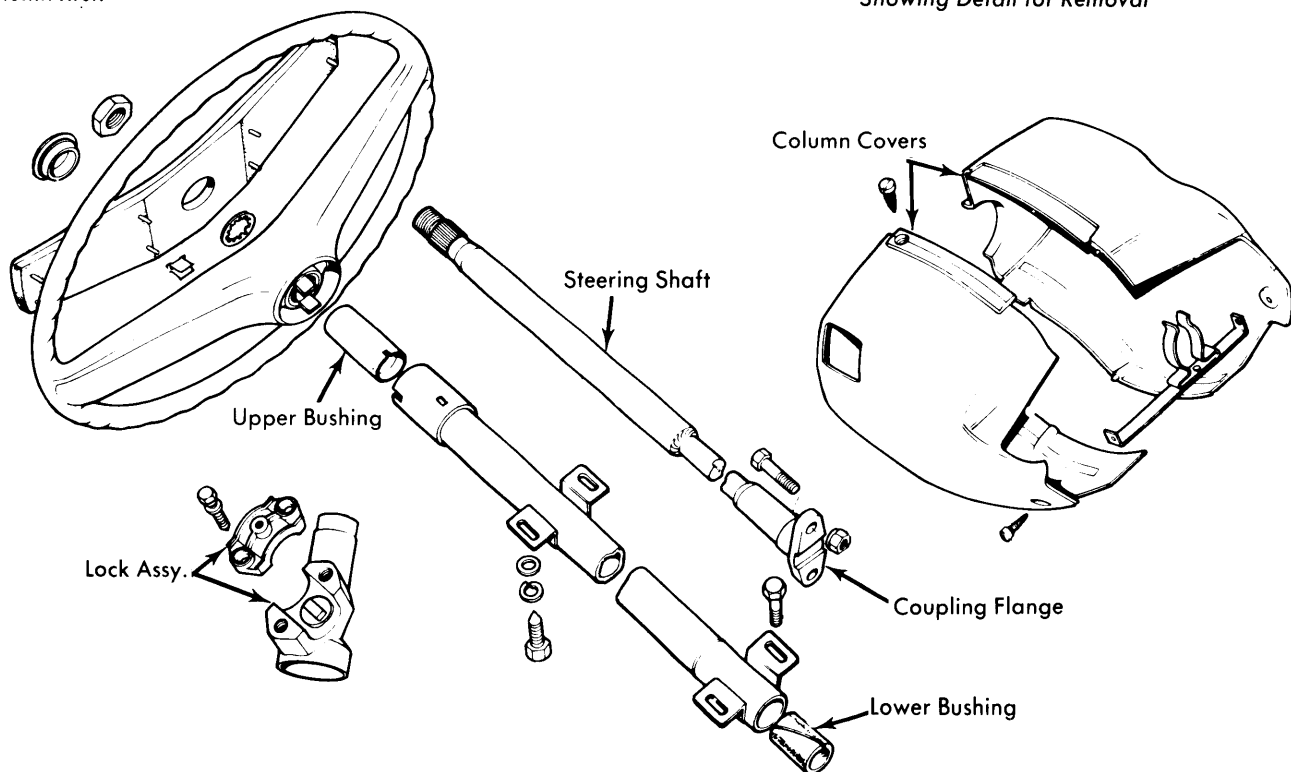

Fig. 2 Disassembled View of Austin Marina Steering Column