

DATSUN B-210

B-210

DESCRIPTION

Brakes are hydraulically operated, actuated by a tandem master cylinder. Front brakes are floating dual piston disc type, and rear brakes are leading-trailing shoe/drum type. Parking brake is cable actuated, operating sliding wheel cylinders of rear brake assemblies.

ADJUSTMENT

PEDAL HEIGHT & FREE PLAY

Adjust pedal height to specifications by moving stop lamp switch. Pedal height should be 6.14" (156 mm) on vehicles equipped with manual transmission and 6.22" (158 mm) on vehicles with automatic transmission. After pedal height is adjusted, loosen push rod lock nut and adjust pedal free play to .039-.197" (1-5 mm).

FRONT DISC BRAKE PADS

Front disc brakes are self-adjusting, therefore, no adjustment in service is required.

REAR BRAKE SHOES

Raise and support vehicle and remove wheel. Using a suitable brake adjusting tool, tighten adjuster wedge clockwise until brake shoe contacts drum. Return adjuster wedge until shoe is slightly separated from drum. Check operation by turning drum and applying brakes; if shoe interferes with drum rotation, readjust.

PARKING BRAKE

With rear brakes adjusted, adjust front cable turnbuckle until rear brakes are locked when parking brake lever is pulled to sixth ratchet stop. Release parking brake lever and make sure rear wheels turn freely.

HYDRAULIC SYSTEM BLEEDING

Attach a bleed tube to bleeder screw and immerse opposite end of tube in a container partially filled with brake fluid. Pump brake pedal two or three times, keep pedal fully depressed, open bleeder screw and exhaust air, close bleeder screw, and return brake pedal. Repeat operation until air bubbles are no longer seen in discharged fluid. Repeat procedure on remaining brake lines. Bleeding sequence is left-rear, right-rear, left-front, right-front.

REMOVAL & INSTALLATION

FRONT DISC BRAKE PADS

Removal — Raise front of vehicle and support in place, then remove front wheels. Remove clips from retaining pins and pull out pins, coil springs and pad springs. Remove pads from caliper assembly using a suitable pair of pliers.

Inspection — With friction pads removed, measure their thickness. Replace any pad that is worn to less than .063" (1.6 mm) in thickness (not including metal backing plate). It is recommended that friction pads be replaced as a set to prevent any possibility of uneven braking.

Installation — Clean and apply P.B.C. grease (or equivalent) on yoke guide groove of cylinder body, sliding contact portions of yoke and end surface of piston. Loosen bleeder screw and push outer piston in cylinder until end surface of piston coincides with end surface of retaining ring on boot. Install inner brake pad. Push inner piston in cylinder by pulling on yoke, then install outer brake pad. After installing pads, depress brake pedal several times to seat pads.

FRONT DISC BRAKE CALIPER

Removal — Raise vehicle and suitably support on safety stands; remove tire and wheel. Remove brake friction pads as previously described. Disconnect brake line from wheel cylinder. To ease removal of caliper, remove strut assembly and knuckle arm mounting bolt. Withdraw caliper mounting bolt and separate it from strut assembly.

Installation — To install brake caliper assembly, reverse removal procedures, noting the following: Bleed hydraulic system.

FRONT DISC BRAKE ROTOR

Removal — With caliper removed, remove hub dust cap, cotter pin and nut. Remove hub and rotor assembly with wheel bearing and washer in place. Remove bolts attaching rotor to wheel hub, and separate rotor from hub.

Installation — Reverse removal procedure, tighten rotor-to-hub bolts securely, and adjust wheel bearings. See *Wheel Bearing Adjustment* in **WHEEL ALIGNMENT** Section.

REAR BRAKE ASSEMBLY

Removal (Rear) — Raise vehicle and suitably support on safety stands; remove tire and wheel. Loosen parking brake linkage at clevis pin and place out of way. Remove brake drum. Remove shoe retainer and return spring, then lift off shoe assembly. Disconnect brake line from wheel cylinder. If necessary, wheel cylinder can now be removed by withdrawing dust cover, adjusting shims and plates.

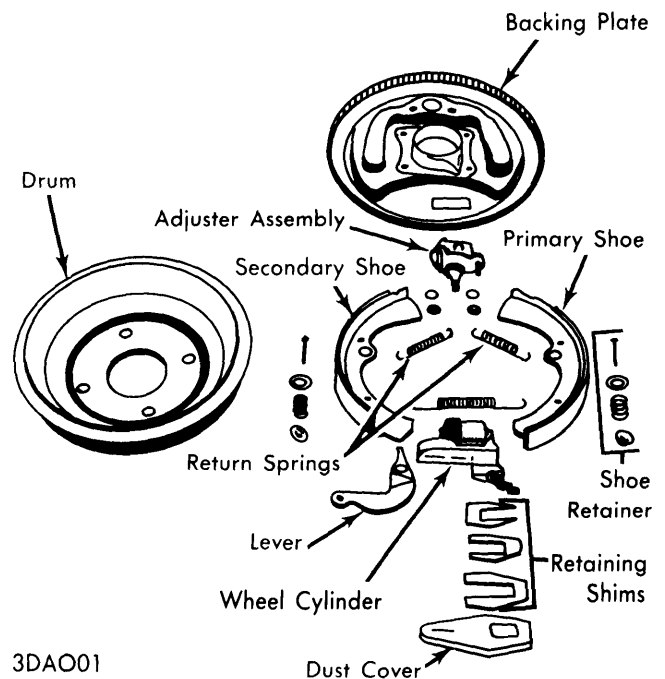

3DA001

REAR DRUM BRAKE ASSEMBLY

DATSUN B-210 (Cont.)

Inspecting — Inspect all brake components for damage or excessive wear and replace those found defective. Replace brake lining if it is oil soaked or lining is less than .059" (1.5 mm) thick.

Installation — To install rear brake lining, reverse removal procedures, noting the following: Readjust shoe-to-drum clearance and, if necessary, bleed hydraulic system.

MASTER CYLINDER

Removal — Disconnect front and rear brake lines from master cylinder. Remove master cylinder attaching nuts and remove master cylinder.

Installation — To install master cylinder, reverse removal procedures, noting the following: Bleed hydraulic system and check pedal height.

removed. Depress and remove piston from cylinder. Remove piston seal from cylinder bore. Yoke can be further disassembled.

Inspecting — Thoroughly clean all internal parts and check each component for excessive wear or damage. If caliper bore is damaged or excessively rusted, it must be replaced. If, however, slight imperfections are evident, honing will eliminate them. It is recommended to replace all seals when overhauling.

Reassembly — Before assembling components, lightly coat with suitable brake grease. Insert bias ring into piston so round portion of ring fits to bottom of piston. Insert piston into cylinder. Do not fully seat piston. Install dust boot and retaining ring. Install yoke bias ring so it coincides with yoke groove of cylinder. Fit bias spring to yoke so bias spring faces bleeder side of cylinder. With yoke spring inserted in cylinder groove, properly align position of bias spring so groove of spring aligns with yoke. Assemble body-to-yoke, tapping lightly if necessary.

OVERHAUL

FRONT DISC BRAKE CALIPER

Disassembly — Loosen bleed screw and depress pistons into cylinder. Secure yoke in a vise and tap head with a mallet. Cylinder body can then be removed from yoke. When separating cylinder body from yoke, do not allow piston to protrude from cylinder. Remove ring from piston and extract retaining rings from both pistons. Dust boot can now be

MASTER CYLINDER

Disassembly — Remove master cylinder reservoir caps and filters and drain brake fluid. Using a screwdriver, pry off stopper ring. Remove stopper screw and pull out primary piston assembly, spring and secondary piston assembly. Remove plugs and pull out front and rear check valves. **NOTE** — Do not remove reservoir tanks. If tanks are removed for any reason, discard and install new ones.

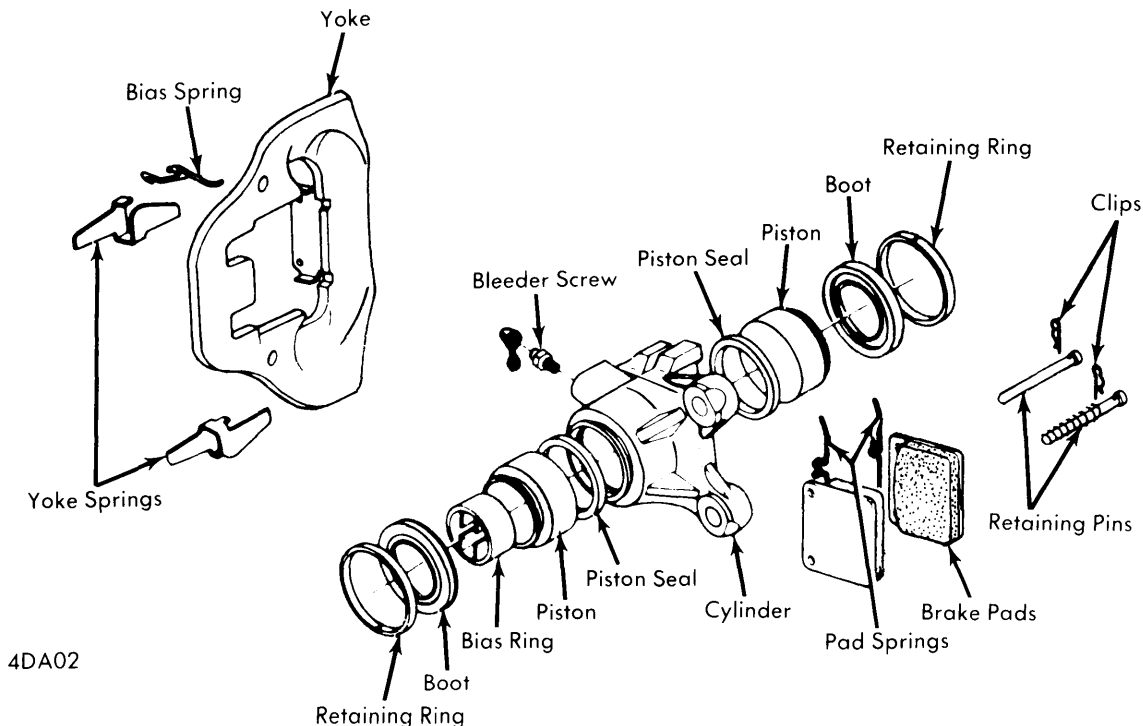

FRONT DISC BRAKE ASSEMBLY

Brakes

DATSUN B-210 (Cont.)

Inspecting — Thoroughly clean all components in approved grade brake fluid. Inspect all components for excessive wear or damage and replace parts as necessary.

Reassembly — Reverse disassembly procedure and note the following: Coat all parts with brake fluid (rubber parts with brake grease) when assembling.

TIGHTENING SPECIFICATIONS	
Application	Ft. Lbs. (mkg)
Master Cylinder Attaching Nuts	6-9 (.8-1.2)
Hydraulic Lines	11-13 (1.5-1.8)
Rotor-to-Hub	28-38 (3.9-5.3)
Caliper Mounting Bolts	53-72 (7.3-9.9)

BRAKE SYSTEM SPECIFICATIONS				
Application	Drum Diam. In. (mm)	Wheel Cylinder Diameter		Master Cylinder Diameter In. (mm)
		Front In. (mm)	Rear In. (mm)	
B-210	8.00 (203)	2.012 [ⓐ] (51.1)	.813 (20.64)	.750 (19.05)

ⓐ — Caliper cylinder diameter.

DISC BRAKE ROTOR SPECIFICATIONS						
Application	Disc Diameter In. (mm)	Lateral Runout In. (mm)	Parallelism In. (mm)	Original Thickness In. (mm)	Minimum Refinish Thickness In. (mm)	Discard Thickness In. (mm)
B-210	9.13 (232)	.0047 [ⓐ] (.12)374 (9.5)	.331 (8.4)	ⓑ

ⓐ — Maximum.

ⓑ — Less than Minimum Refinish Thickness.

BRAKE LINING SPECIFICATION							
Application	Drum Dia. In. (mm)	Width		Length		Thickness	
		Front In. (mm)	Rear In. (mm)	Primary In. (mm)	Secondary In. (mm)	Primary In. (mm)	Secondary In. (mm)
B-210	8.00 (203)	ⓐ	1.378 (35)	7.68 (195)	7.68 (195)	.189 (4.8)	.189 (4.8)

ⓐ — Front disc equipped.

BRAKE DRUM SPECIFICATIONS				
Application	Drum Diameter In. (mm)	Original Diameter In. (mm)	Maximum Refinish Diameter In. (mm)	Discard Diameter In. (mm)
B-210	8.00 (203)	8.00 (203)	8.051 (204)	ⓐ

ⓐ — More than Maximum Refinish Diameter.