

# Steering Columns

## AUSTIN MARINA

Austin Marina

### REMOVAL & INSTALLATION

#### STEERING COLUMN (UPPER)

**NOTE** — Lower portion of steering column is removed with rack and pinion assembly. See appropriate *Steering Gears* article in this Section.

**Removal** — 1) Remove steering wheel, lower instrument panel section, and instrument panel. Loosen screw retaining combined switches on column, disconnect electrical leads, and remove switches. Disconnect ignition switch electrical leads at harness.

2) Remove two nuts and bolts retaining upper column to flexible coupling. Detach column-to-instrument panel support brackets. Remove steering column.

**Installation** — Engage steering lock. Centralize steering rack by inserting set pin as shown. Reverse removal procedure, noting the following: Tighten support bracket bolts to 14-18 ft. lbs. (2.0-2.5 mkg) and flexible coupling bolts to 20-22 ft. lbs. (2.8-3.0 mkg). **NOTE** — If new coupling is installed, remove band compressing the coupling.

#### UPPER BUSHING

Remove steering wheel. Detach and remove combined switches mechanism. Position suitable bushing removal tool (18G 1191) and pull bushing from column. To install, align slots in bushing with depression in outer column, and ensure that chamfered end of bushing enters column first.

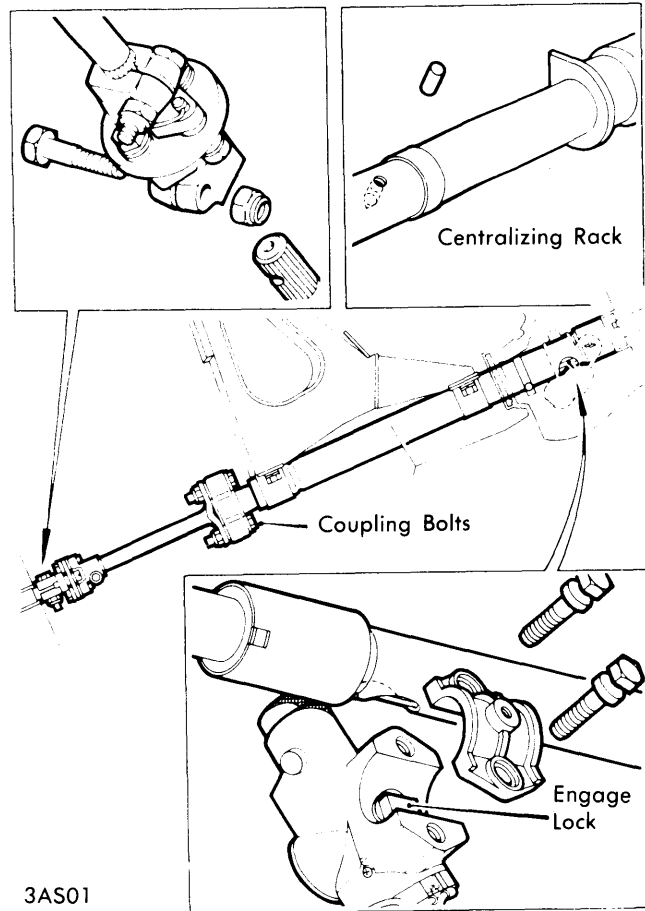

UPPER COLUMN REMOVAL & INSTALLATION

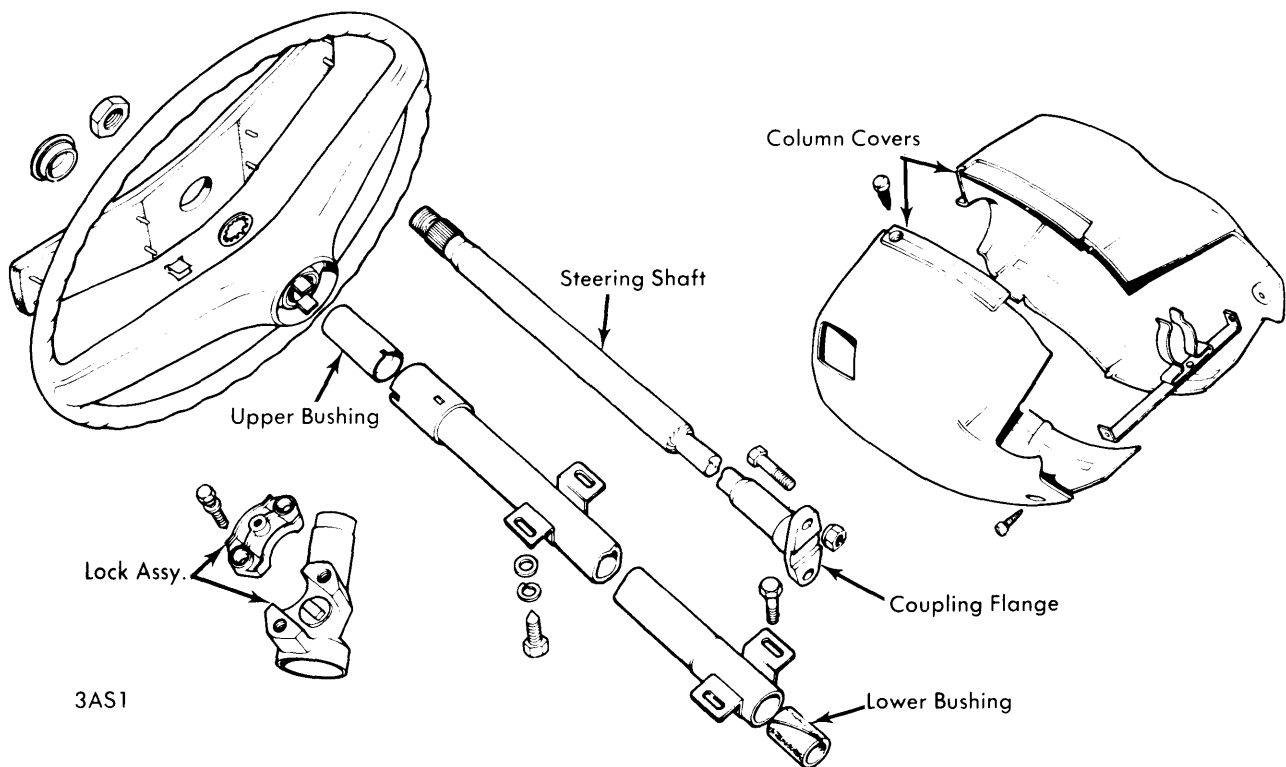

AUSTIN MARINA STEERING COLUMN