

## 1971-72 PLYMOUTH CRICKET

Cricket (1971-72)

### DESCRIPTION

Link type rear suspension with coil springs. Four control arms attach rear axle assembly to frame members. Coil springs are mounted at top in a pocket attached to body side member. Bottom of springs are seated in pockets in outside control arms. Two shock absorbers are mounted at incline angles at rear of axle.

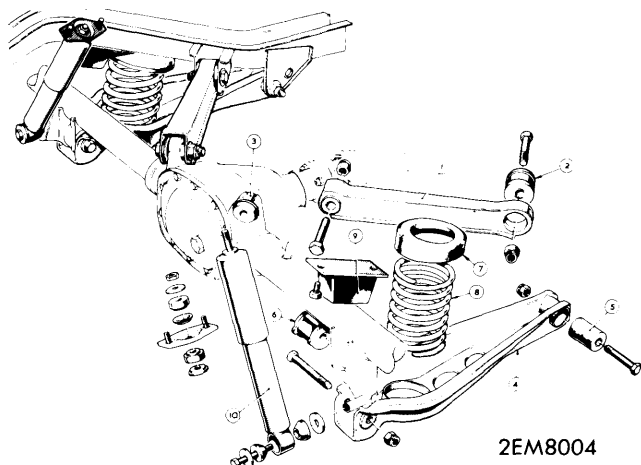

- 1 - Upper Control Arm
- 2 - Upper Control Arm Front Bushing
- 3 - Upper Control Arm Rear Bushing
- 4 - Lower Control Arm
- 5 - Lower Control Arm Front Bushing
- 6 - Lower Control Arm Rear Bushing
- 7 - Coil Spring Insulator
- 8 - Coil Spring
- 9 - Bump Rubber
- 10 - Shock Absorber

### CRICKET REAR SUSPENSION COMPONENTS

### REMOVAL & INSTALLATION

#### SHOCK ABSORBERS

**CAUTION** - Do not remove shock absorbers unless full weight of vehicle is on rear wheels or on safety stands under rear axle.

**Removal** - Remove lower shock bolts and rubber bushings. Remove upper shock mounting bolts, which are accessible from inside luggage compartment.

**Installation** - Reverse removal procedure and tighten all bolts and nuts to specifications.

#### COIL SPRING

**Removal** - Raise vehicle by jacking up under axle and support body by placing safety stands under body members. Remove lower shock absorber mounting bolts and lower rear axle until coil spring can be removed.

**Installation** - Reverse removal procedure making sure coil spring insulator is properly seated in upper spring pocket. Tighten bolt to specification.

#### UPPER CONTROL ARM

**NOTE** - This procedure is for removing one control arm at a time. If it is necessary to remove all control arms at one time, rear axle must be removed. See Cricket Rear Axle in REAR AXLE Section.

**Removal** - Arm can be removed with full weight of vehicle on rear wheels. Remove pivot nuts and bolts and remove control arm from vehicle.

**Installation** - It may be necessary to tilt axle before installing control arm. With arm in position, slide in pivot bolts. Bounce vehicle a few times, before tightening pivot bolts, to make sure bushings are seated. Tighten bolts and nuts to specification.

#### LOWER CONTROL ARM

**NOTE** - This procedure is for removing one control arm at a time. If it is necessary to remove all control arms at one time, rear axle must be removed. See Cricket Rear Axle in REAR AXLE Section.

**Removal** - Remove coil spring as previously outlined. Support axle with safety stands and remove control arm pivot bolts. Remove control arm from vehicle.

**Installation** - Reverse removal procedure to install control arm. Before tightening bolts, bounce vehicle a few times to make sure bushings are seated. Tighten bolts to specification.

#### UPPER AND LOWER CONTROL ARM BUSHING REMOVAL

Upper and lower control arms pivot on rubber bushings which are replaceable. To replace rear bushing of either upper or lower control arms, loosen front pivot bolt and remove rear pivot bolt. Guide control arm away from bushing mount. Using a suitable tool (RG. 551/1-10), press bushing out of mount.

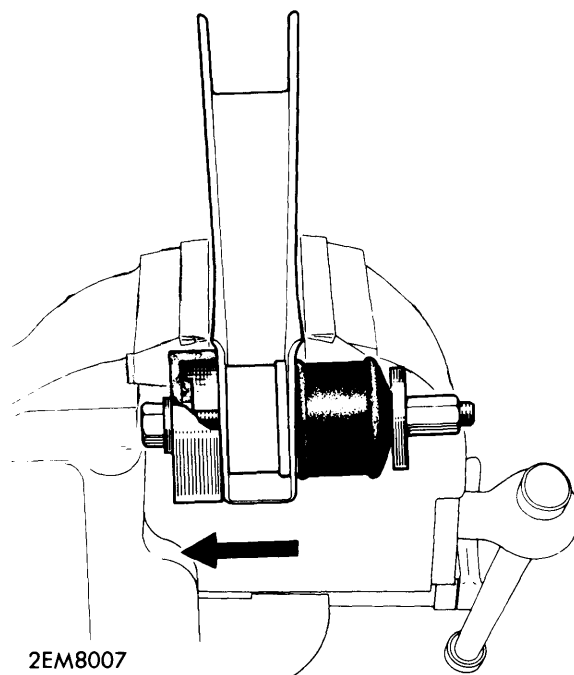

### UPPER CONTROL ARM FRONT BUSHING REMOVAL

# Rear Suspension

## 1971-72 PLYMOUTH CRICKET (Cont.)

Before installing new bushing, coat with a suitable rubber lubricant. Using same tool as used for removal, press bushing into mount. Place control arm in proper position and tighten bolts to specification. To replace either upper or lower control arm front bushing, remove control arm from vehicle as previously outlined. Place control arm in a vise and using same tool, press bushing out of control arm. **CAUTION** — When pressing front bushing in or out of upper control arm, press in direction shown in illustration. Damage to control arm or bushing will occur if pressed in opposite direction. Coat new bushing with a suitable rubber lubricant before installing. Using same tool, press bushing into control arm. Install control arm in vehicle as previously outlined.

### Tightening Specifications

Application	Ft. Lbs.
Control Arm Pivot Bolts & Nuts.....	40
Shock Absorber Spindle to Top Bracket.....	13
Shock Absorber Top Bracket to Body.....	10
Shock Absorber Lower Mount.....	12

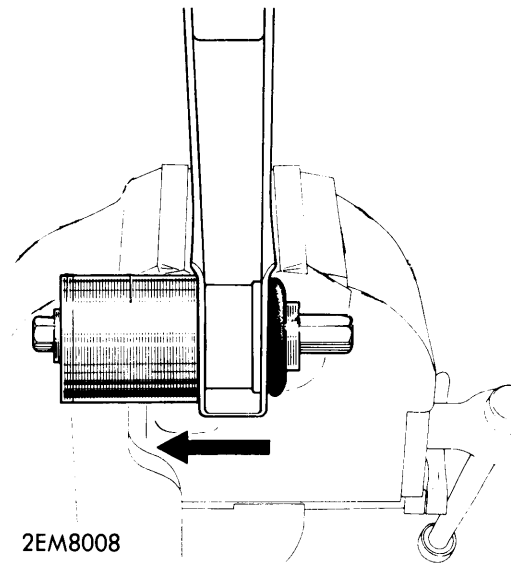

**UPPER CONTROL ARM  
FRONT BUSHING INSTALLATION**