

1972-73 SUBARU 1300 & 1400

1300 (1972)
1400 (1972-73)

REMOVAL & INSTALLATION

DESCRIPTION

Suspension is strut type, utilizing a hydraulic shock absorber/coil spring assembly for strut. Strut is secured at top to body and at bottom to steering knuckle. Steering knuckle pivots on ball joint riveted to lower control arm. Lower control arm pivots on mount integral with crossmember. A stabilizer bar, mounted at rear to body and at front to lower control arms, is also employed. Front suspension caster and camber is not adjustable.

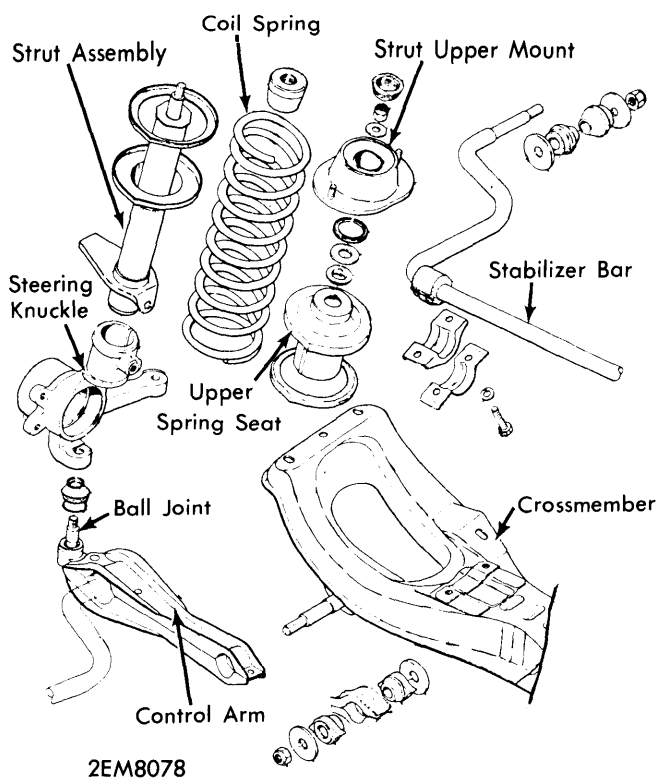

FRONT SUSPENSION COMPONENTS

ADJUSTMENT

WHEEL ALIGNMENT SPECIFICATIONS & PROCEDURES

See appropriate story in WHEEL ALIGNMENT Section.

WHEEL BEARING ADJUSTMENT

See appropriate story in WHEEL BEARING ADJUSTMENT Section.

BALL JOINT CHECKING

See appropriate story in BALL JOINT Section.

FRONT SUSPENSION ASSEMBLY

Removal — Disconnect battery ground cable. Disconnect parking brake cable bracket on control arm. Remove axle nut and pull brake drum off with a suitable puller (925200000). Disconnect flex brake lines from steel brake lines. Separate backing plate assembly from steering knuckle. On vehicles equipped with disc brakes, disconnect parking brake cable from caliper. Remove outer cable clip and remove cable bracket from housing mount. Drive pins out of "U" joints at transaxle. Loosen control arm pivot shaft nut and remove stabilizer bar nut at end of control arm. Pry control arm off of pivot shaft. Remove tie-rod stud nut and separate tie-rod from steering knuckle with a puller. Remove strut assembly upper mounting nuts, pull "U" joint from transaxle and remove complete suspension assembly. Follow same procedure for removal of opposite side suspension assembly.

Installation — To install suspension assembly, reverse removal procedure. Tighten control arm pivot shaft nuts with weight off of front wheels. Replace all self locking nuts with new ones and check wheel alignment specifications. Tighten all nuts and bolts to specifications.

STRUT ASSEMBLY

Removal — Raise front of vehicle and support with safety stands. Remove wheels. Remove bolt securing strut assembly to steering knuckle. Disconnect tie-rod from steering knuckle. Pull down on control arm, separating strut assembly from steering knuckle. Remove upper strut assembly mounting nuts and remove strut assembly.

Installation — To install strut assembly, reverse removal procedure. Tighten all bolts and nuts to specifications and check wheel alignment.

STRUT ASSEMBLY OVERHAUL

Disassembly — Install strut assembly in a suitable holding fixture and spring compressor (925160000). Compress coil spring with compressor until upper spring seat is clear of spring. Hold upper mount by attaching a suitable holding tool (925170000) to bolts and remove nut from center shaft. Pull strut mount from rod, remove thrust washer with oil seal and thrust bearing. Pull off upper spring retainer. Loosen spring compressor and remove spring when completely released.

Inspection — Push and pull center shaft in and out of strut assembly. Pressure should be equal during both strokes. Replace strut assembly if defective. Check outer layer of thrust washer for cracks or wear. Check sliding surface of thrust bearing for wear or cracking. Inspect sealing lip of oil seal for damage.

Assembly — To assemble strut, reverse disassembly procedure. Apply grease to sealing lip of seal. Position thrust washer so that machined surface is facing coil spring. Tighten upper strut mount nut to specification.

Front Suspension

1972-73 SUBARU 1300 & 1400 (Cont.)

STABILIZER BAR

Removal – Raise front of vehicle and support with safety stands. Remove nuts and washers securing stabilizer bar to control arm. Disconnect exhaust pipe from manifold. Remove bolts securing stabilizer bar clamps to rear crossmember and remove clamps. Pull stabilizer bar down and to rear to remove.

Installation – Check all bushings for wear or damage and replace as necessary. Check stabilizer bar for possible cracking. To install stabilizer bar, reverse removal procedure.

LOWER CONTROL ARM

Removal – Raise front of vehicle and support with safety stands. Disconnect brake cable bracket from control arm. Remove nut from control arm pivot shaft. Disconnect stabilizer bar from control arm. Pry control arm rearward off of pivot shaft. Remove cotter pin from ball joint and remove nut. Separate control arm and ball joint from steering knuckle.

Installation – Check that ball joint is still tightly riveted in control arm. Check pivot bushing for wear or damage. Check ball joint for wear or damage. See *Appropriate article in WHEEL ALIGNMENT Section*. Check ball joint boot for damage and repack with grease. To install control arm, reverse removal procedure.

TIGHTENING SPECIFICATIONS	
Application	Ft. Lbs. (mkg)
Upper Strut Mount	26 (3.6)
Control Arm Pivot Shaft Nut	80 (11.1)
Stabilizer Bar-to-Control Arm Nut	80 (11.1)
Tie-Rod Stud Nut	20 (2.8)
Brake Backing Plate-to-Steering Knuckle	27 (3.7)
Strut Assembly-to-Steering Knuckle	26 (3.6)
Strut Assembly Center Shaft Nut	48 (6.6)