

Wheel Alignment

1962-72 DATSUN SPECIFICATIONS & ADJUSTMENTS

TIRE INFLATION (COLD)

Before attempting to check or adjust wheel alignment, ensure that tires are properly inflated.

Tire Pressure Specifications (psi)

Model Application	Front	Rear
310,311,312	22	22
410,411	22	22
240Z (Radial)	28	28
240Z (Standard)	24	24
320U	24	30
520	22	46
521	21	39
1200	22	22

RIDING HEIGHT

Pickups Only – Adjust to specified distance by turning anchor bolt adjusting nut. Raise vehicle to release tension on adjusting nut.

Riding Height Specifications

Application	Vehicle Loaded	Vehicle Unloaded
Pickup Model 320	2.93"	3.47"
Pickup Model 520	2.21"	3.07"
Pickup Model 521	2.15"	3.11"-3.31"

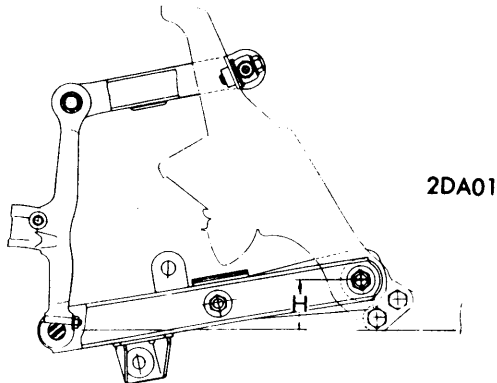

RIDING HEIGHT MEASURING POINT

CASTER

All Models (Except 240Z, 510 & 1200) – Caster is adjusted by increasing or decreasing the thickness of shims inserted between upper link spindle and upper link mounting bracket. When front shim thickness increases, caster reduces. Set caster to specifications given in table. **NOTE** – Do not adjust caster with difference between front and rear shim thicknesses beyond .078".

240Z, 510 & 1200 – Caster is not adjustable. If alignment is not within specifications, check for damaged parts and replace as necessary.

CAMBER

All Models (Except 240Z, 510 & 1200) – Camber is adjusted by increasing or decreasing the thickness of shims inserted between upper link spindle and upper link mounting bracket. When thickness of shims increases, camber reduces. Set camber to specifications given in table.

240Z, 510 & 1200 (Front) – Camber is not adjustable. If alignment is not within specifications, check for damaged parts and replace as necessary.

240Z & 510 (Rear) – Camber is not adjustable. If alignment is not within specifications, check for damaged parts and replace as necessary.

TOE-IN

All Models (Except Pickups) – Adjust by loosening side rod lock nuts and adjusting length of side rod to change toe-in to correct specifications. **NOTE** – Left and right side rods should be moved equally. Tighten lock nuts.

Pickups – Adjust by loosening cross rod lock nuts and turning cross rod to change its length which will increase or decrease the toe-in depending on the direction rod is turned. With toe-in to correct specifications, tighten lock nuts.

WHEEL ALIGNMENT SPECIFICATIONS							
R – Right Rr – Rear Man – Manual Steering Pwr – Power Steering	F – Front L – Left	Steering Axis Incl.	Caster (Degrees)	Camber (Degrees)	Toe-In (Inches)	Toe-Out On Turns	
						Inner	Outer
240Z		12°10' ±30'	2°55' ±30'	F 50' ±30' Rr 48'	F .0787-.1969 Rr 0°	32.5° 30'	31.9° ±30'
510 Sedan		8°	1°40'	1°	.236-.354	38°-39°	22°-33°
L510S		7°30'	1°40'	1°30'	.354-.472	38°-39°	22°-33°
510 Wagon		7°50'	2°	F 1°10' Rr 0° ±30'	F .118-.236 Rr -1° ±30'	38°-39°	22°-33°
320U		6°	4°15'	1°30'	.079-.118	34°	29°30'
520		6°15'	1°50'	1°15'	.079-.118	34°	29°30'
521		6°15'	1°50'	1°15'	.079-.118	36°	31°
1200 Sedan		7°55'	1°40' ±30'	1°05' ±30'	.16-.24	43°	36°
1200 Wagon		7°45'	1°35' ±30'	1°15' ±30'	.20-.24	43°	36°
310, 311, 312		6°34'	1°30'	1°26'	.079-.118	36°16'	28°20'
410, 411		6°30'	1°30'	1°30'	.118	36°	28°36'