

## 1966-73 FIAT 124

124 (1966-73)

## DESCRIPTION

Braking system is four wheel disc type, which is actuated by a tandem master cylinder. To reduce effort required to depress brake pedal, all models (except early model sedans) use Master-Vac power assisted brake unit on the tandem master cylinder. Single piston floating disc caliper is used on all four wheels. All Models use a brake pressure regulator (located near rear axle housing) to provide a front to rear braking differential of .46:1, for balanced braking. Parking brake is mechanically operated by a hand lever and cables which connect to rear brake assemblies.

## ADJUSTMENT

## DISC BRAKE PADS

Front and rear disc brakes are self-adjusting, therefore, no adjustment in service is required.

## PARKING BRAKE

Fully release parking brake lever, then pull upward on lever to second notch. Loosen lock nut and tighten equalizer adjusting nut until cable is tight. Release hand lever and again actuate lever through at least two notches. Cable is properly adjusted if rear brakes are locked when lever is pulled to third notch. Release hand lever and check that rear wheels turn freely. With cable properly adjusted, tighten cable lock nut.

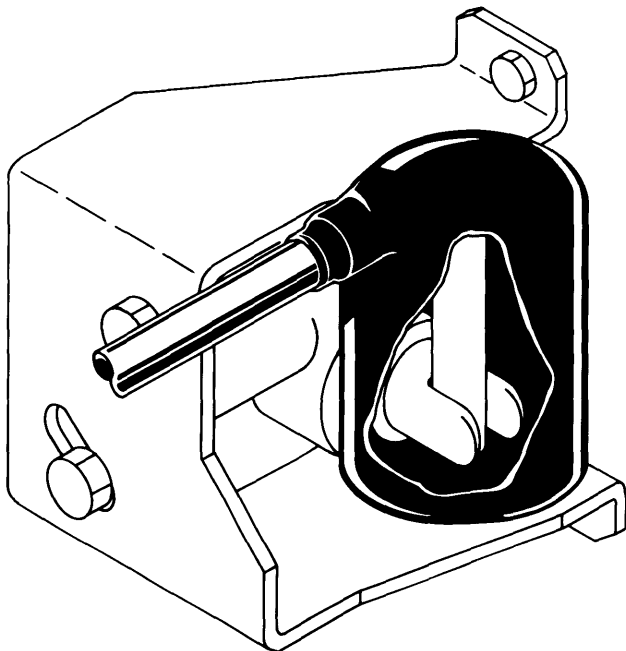

3FI01

## BRAKE PRESSURE REGULATOR

*NOTE* — The following procedure should only be used if pressure regulator has been overhauled or if it is suspected that it is improperly adjusted.

See illustration and perform the following: Bring end of torsion bar (E) to a distance of  $5.787 \pm .196$ " ( $3.740 \pm .196$ " for Spider) from rubber buffer resting surface. Lift dust boot (C) and rotate regulator on screws (A & B) until opposite end of torsion bar (E) is in light contact with piston (D) projecting from regulator. Holding regulator in this position, tighten screws (A & B). Apply rubber lube to torsion bar (E) where piston (D) and pin (F) meet; replace dust boot (C). Connect link to regulator torsion bar and lug on axle housing.

## HYDRAULIC SYSTEM BLEEDING

Attach a bleed tube to caliper bleeder screw, and immerse opposite end of tube into container partially filled with brake fluid. Open bleeder screw, press pedal down quickly, and allow to return slowly. Continue operation until air bubbles are no longer seen in discharged fluid. Tighten bleeder screw on a down stroke of pedal. Repeat procedure on remaining brake lines until all air is bled from system.

## REMOVAL &amp; INSTALLATION

## BRAKE CALIPER

**Removal** — Plug master cylinder reservoir outlet port before disconnecting brake line to caliper. Remove cotter pin on caliper and remove locking plates. Remove caliper flat springs, disc pads and springs. *NOTE* — On rear wheels handbrake cable must be disconnected from caliper unit.

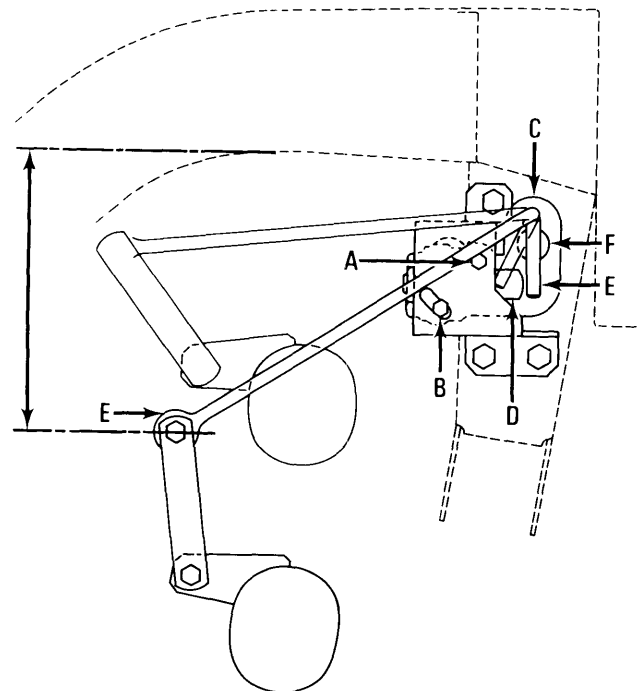

## BRAKE REGULATOR ADJUSTMENT

## 1966-73 FIAT 124 (Cont.)

**Installation** — Fit friction pad locking spring and friction pads to caliper bracket. Fit flat spring and caliper to caliper bracket. Install locking blocks and cotter pins. Connect brake line to caliper. **NOTE** — On rear wheels connect handbrake.

### DISC PADS

Disc pads may be inspected and/or replaced when caliper is removed. **NOTE** — Inside and outside pads are different. When installing pads to calipers, distance between inner surfaces must not be less than .413" (10.5 mm). **NOTE** — There are two kinds of disc pads available, do not mix them. One has an orange stripe and the other has a black stripe.

### BRAKE ROTOR

**Removal** — With caliper removed, remove caliper support bracket from support plate (front) or from axle housing (rear). Remove bolts attaching rotor to wheel hub, remove hub plate, then remove rotor using a drift.

**Installation** — Install rotor and hub plate to wheel hub, install attaching bolts, and tighten securely.

### MASTER CYLINDER

**Removal** — Remove reservoir cover and plug fluid outlet ports. Disconnect fluid supply lines from reservoir at cylinder, and disconnect pressure lines. Remove bolts attaching master cylinder to power unit and remove master cylinder.

**Installation** — Reverse removal procedure and bleed hydraulic system.

## OVERHAUL

### BRAKE CALIPER

**Disassembly** — With front caliper removed from vehicle and placed on work bench, remove dust boot. Inject compressed air into inlet union to remove piston. **NOTE** — When using compressed air to remove piston, take care to prevent personal injury and to prevent damage to piston. With piston removed, remove piston seal. On rear caliper, remove dust boot. Use screwdriver (inserted into slot of piston) to disconnect piston from handbrake lever. Remove cam lever pivot pin and lever. Lift out self-adjusting plunger, plunger seal, disc spring and thrust washer.

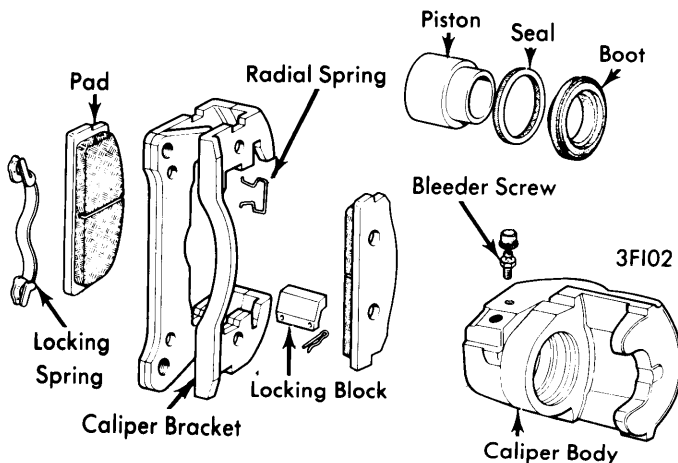

**FRONT CALIPER ASSEMBLY**

**Cleaning & Inspecting** — Clean all parts in suitable solvent, (Fiat LDC detergent). **NOTE** — When piston is removed from caliper, piston seals must be replaced.

**Reassembly** — On front caliper, fit piston seal in caliper. Insert piston to far end of cylinder bore. Position dust boot on caliper body. On rear caliper, fit self-adjusting plunger complete. Fit seal, disc spring and body. Install rubber boot on rear brake caliper body. **NOTE** — Reference mark on rear brake caliper piston must be on side of bleed connector.

### MASTER CYLINDER

**Disassembly** — Disconnect fluid inlet union from cylinder. Remove stop screw and end plug, and remove piston return springs, cups, seal rings, and spacers.

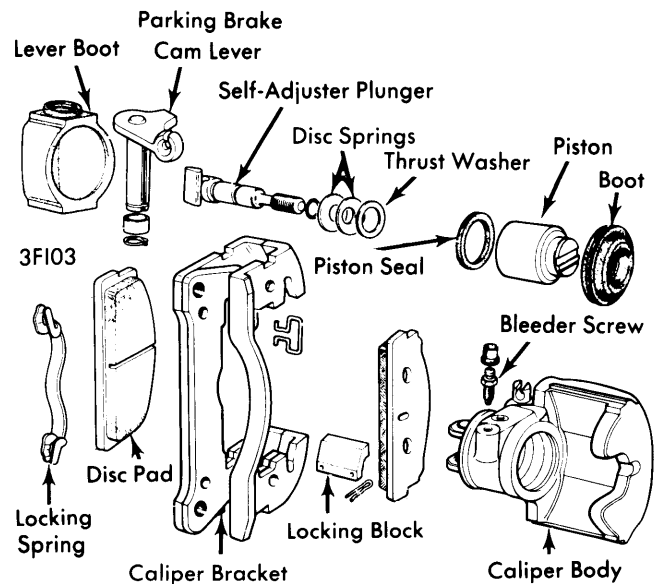

**REAR CALIPER ASSEMBLY**

**Cleaning & Inspection** — Clean all components in Fiat LDC fluid and check for wear or damage; replace parts as necessary. Small imperfections in cylinder bore may be removed by honing.

**Reassembly** — Coat all parts with rubber lube and reverse disassembly procedure. **NOTE** — Manufacturer recommends replacing seal rings whenever master cylinder has been disassembled.

### TIGHTENING SPECIFICATIONS

Application	Ft. Lbs. (mkg)
Caliper Support Plate	
Front .....	36 (4.6)
Rear .....	40 (5.5)
Hydraulic Lines	
Front .....	22 (3.0)
Rear .....	18 (2.5)
Pressure Regulator .....	18 (2.5)
Wheel Nuts .....	51 (7.0)

# Brakes

## 1966-73 FIAT 124 (Cont.)

BRAKE SYSTEM SPECIFICATIONS				
Application	Drum Diam. In. (mm)	Wheel Cylinder Diameter		Master Cylinder
		Front In. (mm)	Rear In. (mm)	Diameter In. (mm)
All Models	8.94 (227.1)	1.88 (47.6)	1.38 (34.9)	.750 (19.05)

DISC BRAKE ROTOR SPECIFICATIONS						
Application	Disc Diameter In. (mm)	Lateral Runout In. (mm)	Parallelism In. (mm)	Original Thickness In. (mm)	Minimum Refinish Thickness In. (mm)	Discard Thickness In. (mm)
All Models	8.94 (227.1)	.006 (.152)	..... .....	.395 (10.0)	⊙ .....	.354 (8.9)

⊙ — Front is .368" (9.34 mm) and rear is .372" (9.40 mm).